

KEY:	
E3	FLUSH CONCRETE KERB - 125 X 255 X 915 MM - GREY SQUARE CHANNEL STRAIGHT BY MARSHALLS
E6	UPSTAND CONCRETE KERB - 150 X 305 X 915 MM - GREY BULLNOSED STRAIGHT BY MARSHALLS

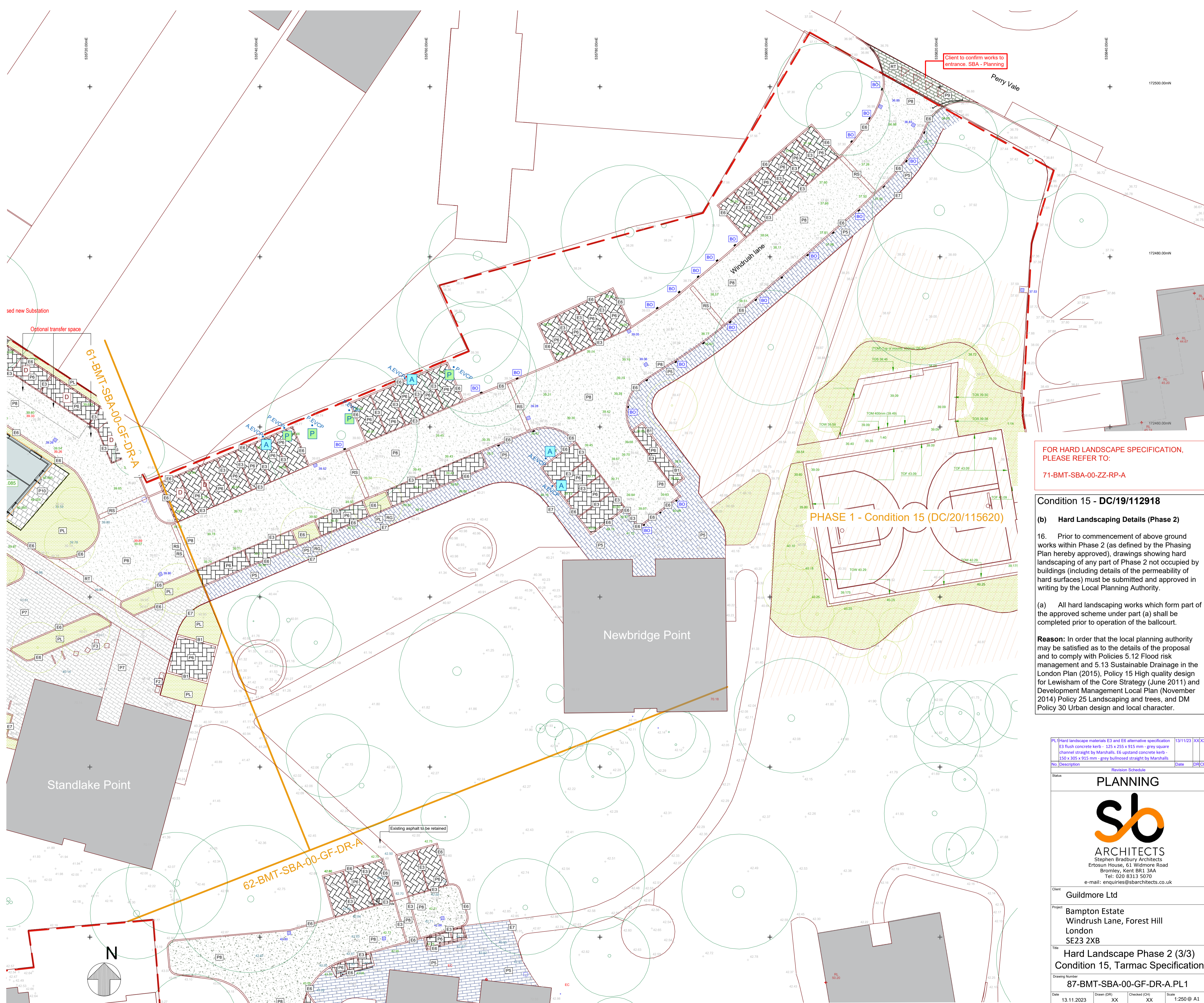

FOR HARD LANDSCAPE SPECIFICATION,
PLEASE REFER TO:
71-BMT-SBA-00-ZZ-RP-A

Condition 15 - DC/19/112918

(b) Hard Landscaping Details (Phase 2)

16. Prior to commencement of above ground works within Phase 2 (as defined by the Phasing Plan hereby approved), drawings showing hard landscaping of any part of Phase 2 not occupied by buildings (including details of the permeability of hard surfaces) must be submitted and approved in writing by the Local Planning Authority.

(a) All hard landscaping works which form part of the approved scheme under part (a) shall be completed prior to operation of the ballcourt.

Reason: In order that the local planning authority may be satisfied as to the details of the proposal and to comply with Policies 5.12 Flood risk management and 5.13 Sustainable Drainage in the London Plan (2015), Policy 15 High quality design for Lewisham of the Core Strategy (June 2011) and Development Management Local Plan (November 2014) Policy 25 Landscaping and trees, and DM Policy 30 Urban design and local character.

No	Description	Revision	Schedule	Date	DR/CH
PL1	Hard landscape materials E3 and E6 alternative specification	13/11/23	XX		
	E3 flush concrete kerb - 125 x 255 x 915 mm - grey square channel straight by Marshalls. E6 upstand concrete kerb - 150 x 305 x 915 mm - grey bullnosed straight by Marshalls				

PLANNING	
ARCHITECTS Stephen Bradbury Architects Ertoun House, 61 Wildmore Road Bromley, Kent BR1 3AA Tel: 020 8313 5070 e-mail: enquiries@sbarchitects.co.uk	
Client	Guildmore Ltd
Project	Bampton Estate Windrush Lane, Forest Hill London SE23 2XB
Title	Hard Landscape Phase 2 (3/3) Condition 15, Tarmac Specification
Drawing Number	87-BMT-SBA-00-GF-DR-A.PL1
Date	13.11.2023
Drawn (DR)	XX
Checked (CH)	XX
Scale	1:250 @ A1