

**Notes**  
 This document and its design content is copyright ©. To be read in conjunction with all other associated project information including models, specifications, schedules and related consultants documents. It is not recommended to scale from this document and no responsibility lies with the authors for scaled dimensions. Check print using the scale bar provided to ensure the document is printed to scale. All dimensions must be checked on site. Immediately report any discrepancies, errors or omissions on this document to the Originator. If in doubt ASK.

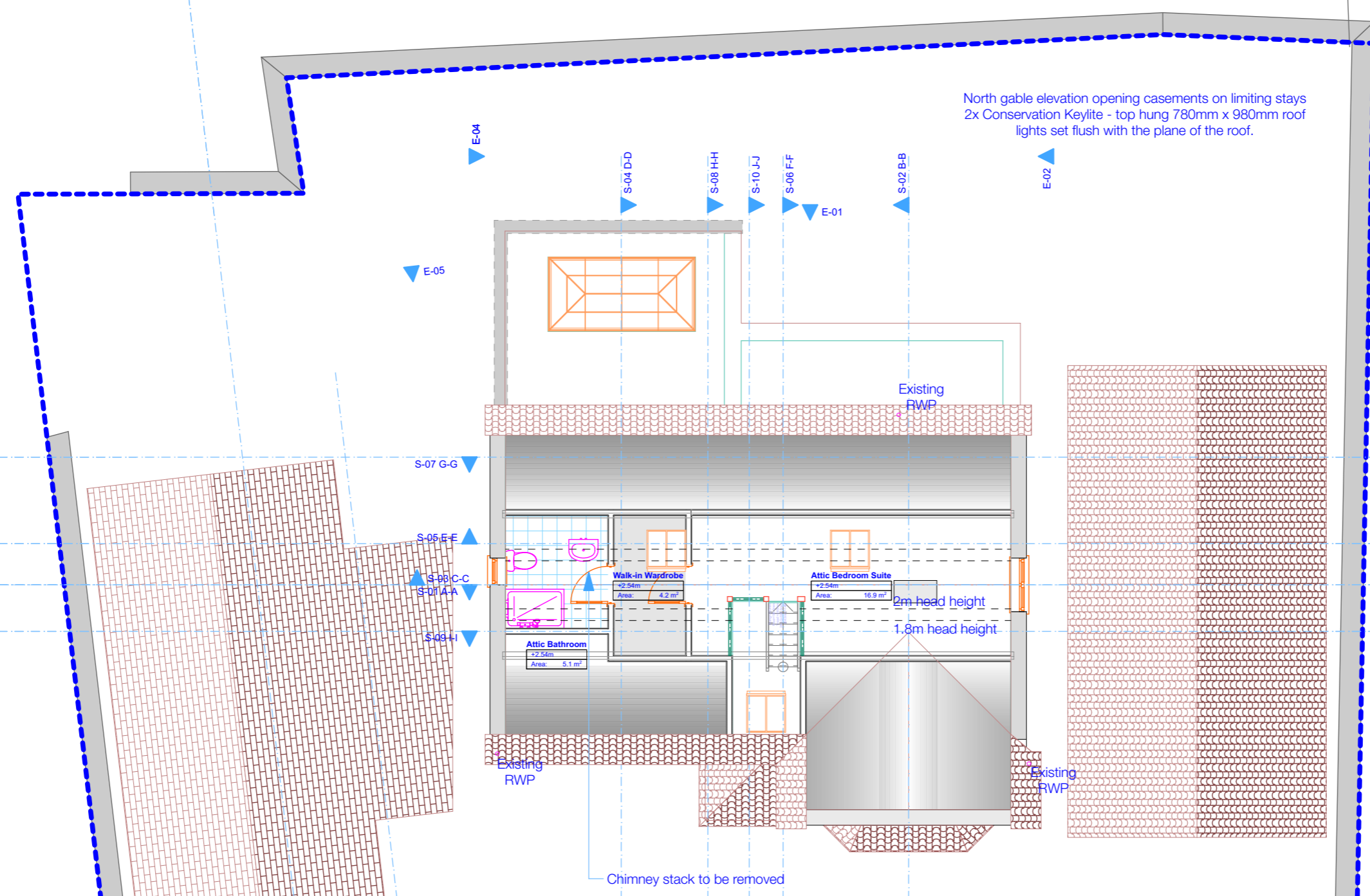
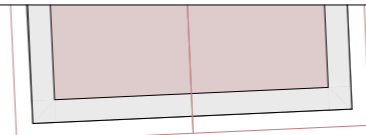

2. 02-Attic Floor Proposed 1:100

Layout Title  
**A3 Attic Floor Layout Proposed 1-100**

Purpose of Issue <b>For Planning</b>	status	Drawn By	Date
		Checked By	Date
		Approved By	Date

Scales @ A3  
**1:100**

Originator  
**Hargreaves:architecture+ design**  
 Tel: 01884 254 518

Project  
**2010-35 Rainbow's End, Morchard Bishop**

Client  
**J Lucas**

Drawing Number	
project	rev
<b>2010-35-01-06</b>	<b>02 - WIP</b>

02 - WIP	03	Ch-10	Scheme changes	New scheme design for attic conversion
01	02	Ch-09	Scheme changes	Client amendments to GF layout and utility space, proposed to replace all rainbow triple bay windows with new 4-gang casements. Also Planning Officer's request to change rear dormer and north gable window
		Ch-05	Scheme changes	Scheme amended to client comments
RevID	Transmittal Set ID	Change ID	Change Name	Change Note