

Notes
 This document and its design content is copyright ©. To be read in conjunction with all other associated project information including models, specifications, schedules and related consultants documents. It is not recommended to scale from this document and no responsibility lies with the authors for scaled dimensions. Check print using the scale bar provided to ensure the document is printed to scale. All dimensions must be checked on site. Immediately report any discrepancies, errors or omissions on this document to the Originator. If in doubt ASK.

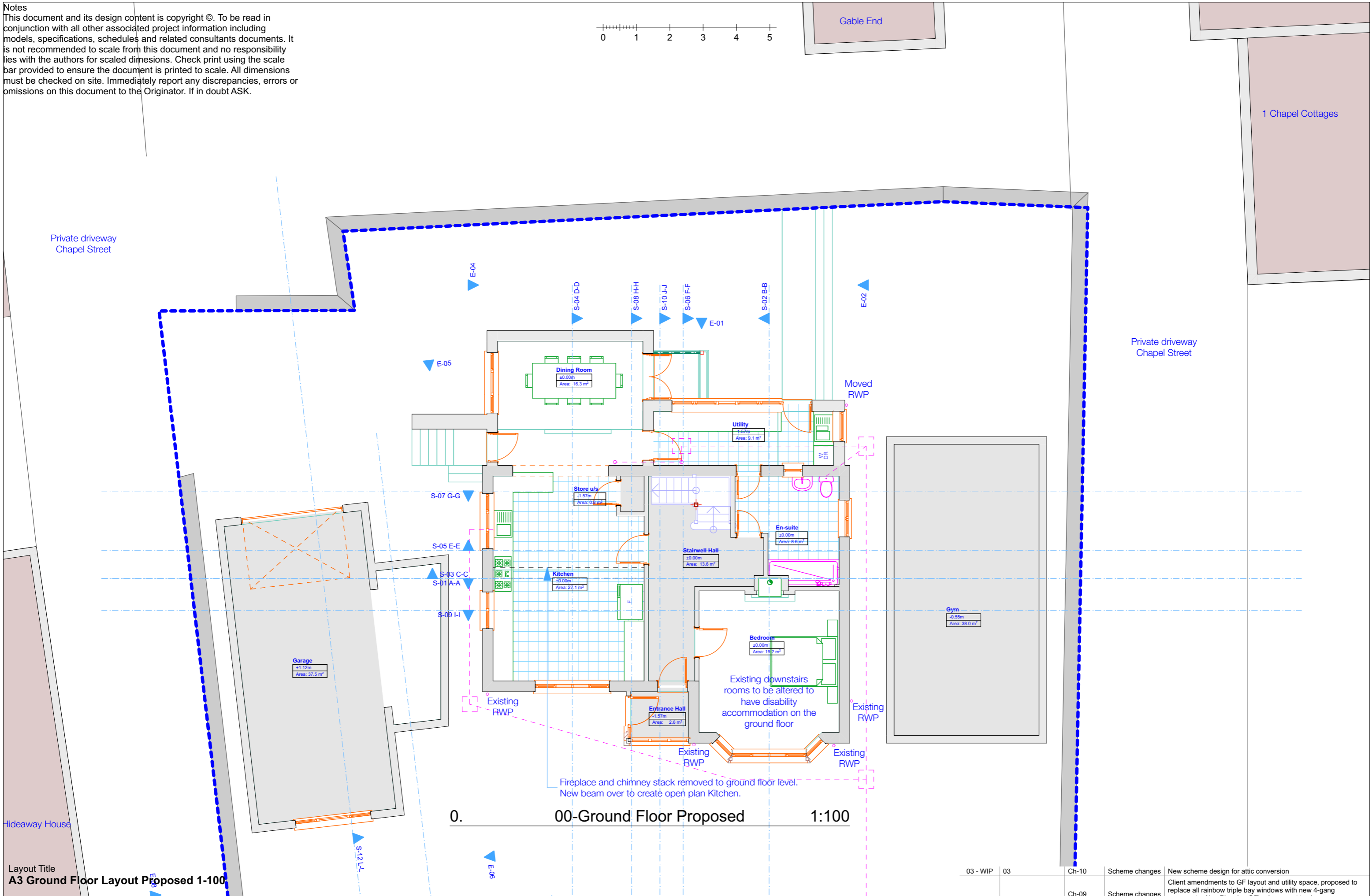

0. 00-Ground Floor Proposed 1:100

Layout Title
A3 Ground Floor Layout Proposed 1-100

Purpose of Issue For Planning	status	Drawn By	Date	Scales @ A3 1:100	Originator Hargreaves:architecture+ design Tel: 01884 254 518	Project 2010-35 Rainbow's End, Morchard Bishop	Client J Lucas	Drawing Number		03 - WIP		
		Checked By	Date					project	rev			
	Approved By	Date						02	02	Ch-10	Scheme changes	New scheme design for attic conversion
								01	01	Ch-09	Scheme changes	Client amendments to GF layout and utility space, proposed to replace all rainbow triple bay windows with new 4-gang casements. Also Planning Officer's request to change rear dormer and north gable window
										Ch-06	Scheme changes	New kitchen door to front elevation
										Ch-05	Scheme changes	Scheme amended to client comments
										Ch-01	Survey	Existing plan
								RevID	Transmittal Set ID	Change ID	Change Name	Change Note