

NOTE	KEY
WATER AND DRAINAGE WILL NOT BE ALTERED.	 CLEAR OPENING FOR NEW 1HR DOORS
	 EXISTING DOORS TO REMAIN

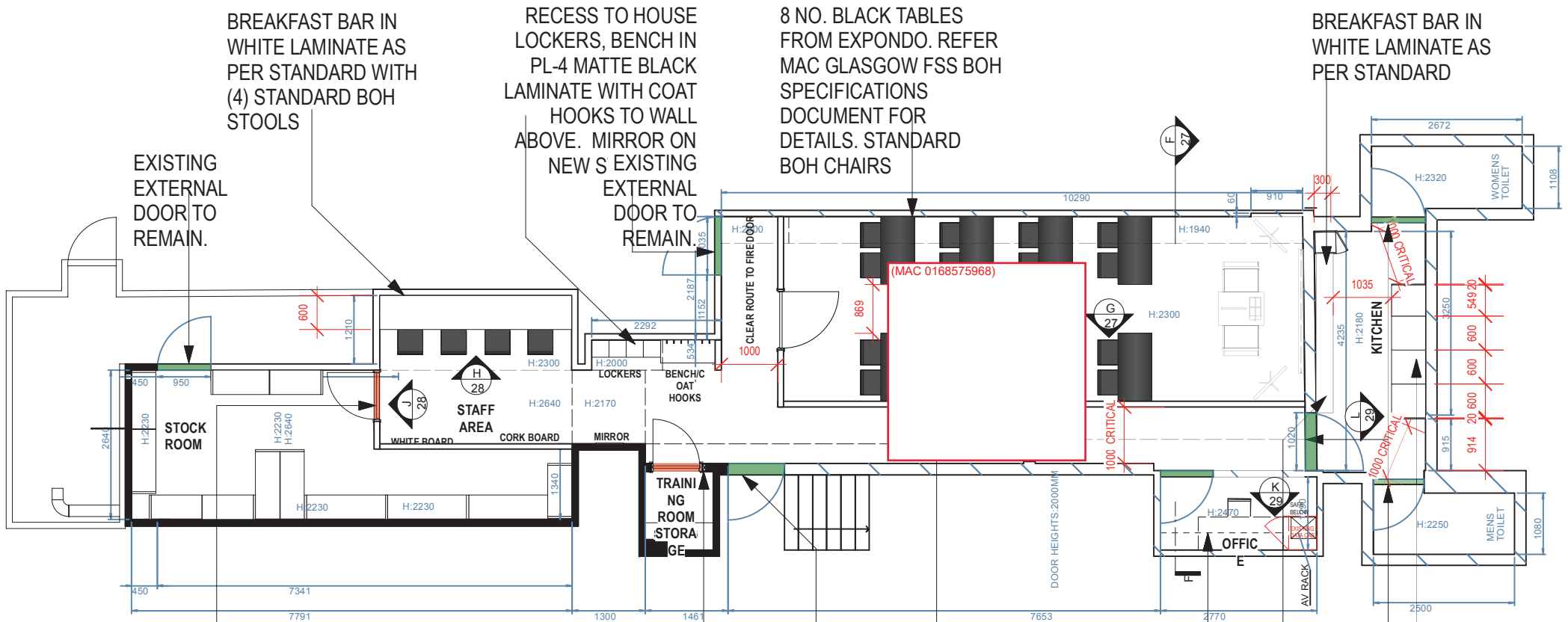

BREAKFAST BAR IN WHITE LAMINATE AS PER STANDARD WITH (4) STANDARD BOH STOOLS

EXISTING EXTERNAL DOOR TO REMAIN.

RECESS TO HOUSE LOCKERS, BENCH IN PL-4 MATTE BLACK LAMINATE WITH COAT HOOKS TO WALL ABOVE. MIRROR ON NEW S EXISTING EXTERNAL DOOR TO REMAIN.

8 NO. BLACK TABLES FROM EXPONDO. REFER MAC GLASGOW FSS BOH SPECIFICATIONS DOCUMENT FOR DETAILS. STANDARD BOH CHAIRS

BREAKFAST BAR IN WHITE LAMINATE AS PER STANDARD

NEW STUD WALL & DOOR, BOTH TO BE 30 MINS FIRE RATED. CARD READER REQ.

ALCOVE TO HAVE STUD WALL BUILD OUT TO ACCOMMODATE NEW DOOR. BOTH TO BE 30 MINS FIRE RATED. NEW SHELVING WITHIN REQ.

EXISTING DOOR TO STAIRWELL TO REMAIN

NEW STUD WALL WITH NEW DOOR - CORRIDOR TO BE MIN 1M. BOTH WALL & DOOR TO BE 30 MIN FIRE RATED.

OFFICE TO TYPICAL BOH STANDARDS. WALL SHELVING TO EXTEND FULL WIDTH. EXISTING DOOR TO REMAIN. DIGI LOCK TO BE REPLACED WITH CARD READER.

CLEANERS CUPBOARD

STANDARD BOH KITCHEN. END PANELS REQ. TO DOOR TO KITCHEN AND 2 No. EXISTING INTERNAL DOORS TO TOILETS TO REMAIN.

BRAND NAME MAC	
PROJECT NAME 131 BUCHANAN STREET, GLASGOW	
DRAWING TITLE PROPOSED PLAN - BASEMENT	
DRAWING NUMBER MAC 1068575968	27
DATE 14/06/23	REVISION DATE 14/12/23
DRAWN BY AS	SCALE As Noted
REVISION NOTES	
REVISION NO.: A DATE: 14/12/23 REQUESTED BY: Local Authorities DESCRIPTION: refer to Local Authorities comments	
GENERAL NOTES	
<ul style="list-style-type: none"> - All works to be carried out in compliance with the Building Standards (Scotland) Regulations 2004, as amended, all relevant British Standards, Codes of Practice and in accordance with all relevant good building practice. - All dimensions are in millimeters unless otherwise noted. - All materials, fittings & components must be installed within the strict guidance of manufacturers installation instructions specifications and details and be compliant with any other British or European Standard named herewith. - All down takings to comply with BS 6187:2011 and Health & Safety at Work Act 1974. - All building elements, products and components to comply with BS 7543 for durability. Levels of workmanship to be in accordance with relevant criteria set out in Section 0.8 of BSSR Technical Handbook for Non-Domestic buildings. - Fitness of materials, fittings and components or parts thereof to comply with any of the standards set out in Section 0.8.4 of BSSR Technical Handbook for Non-Domestic buildings. - All electrical work to be to the IEE wiring regulation latest edition, BS 7671:2018 as amended. - Emergency lighting to be in accordance with BS 5266 Part 1: 2016. 	

1 Proposed Plan - Basement
Scale: 1:1000@A3