

# V4.1 GLASGOW PLANNING VISUAL

1:50 @ A3

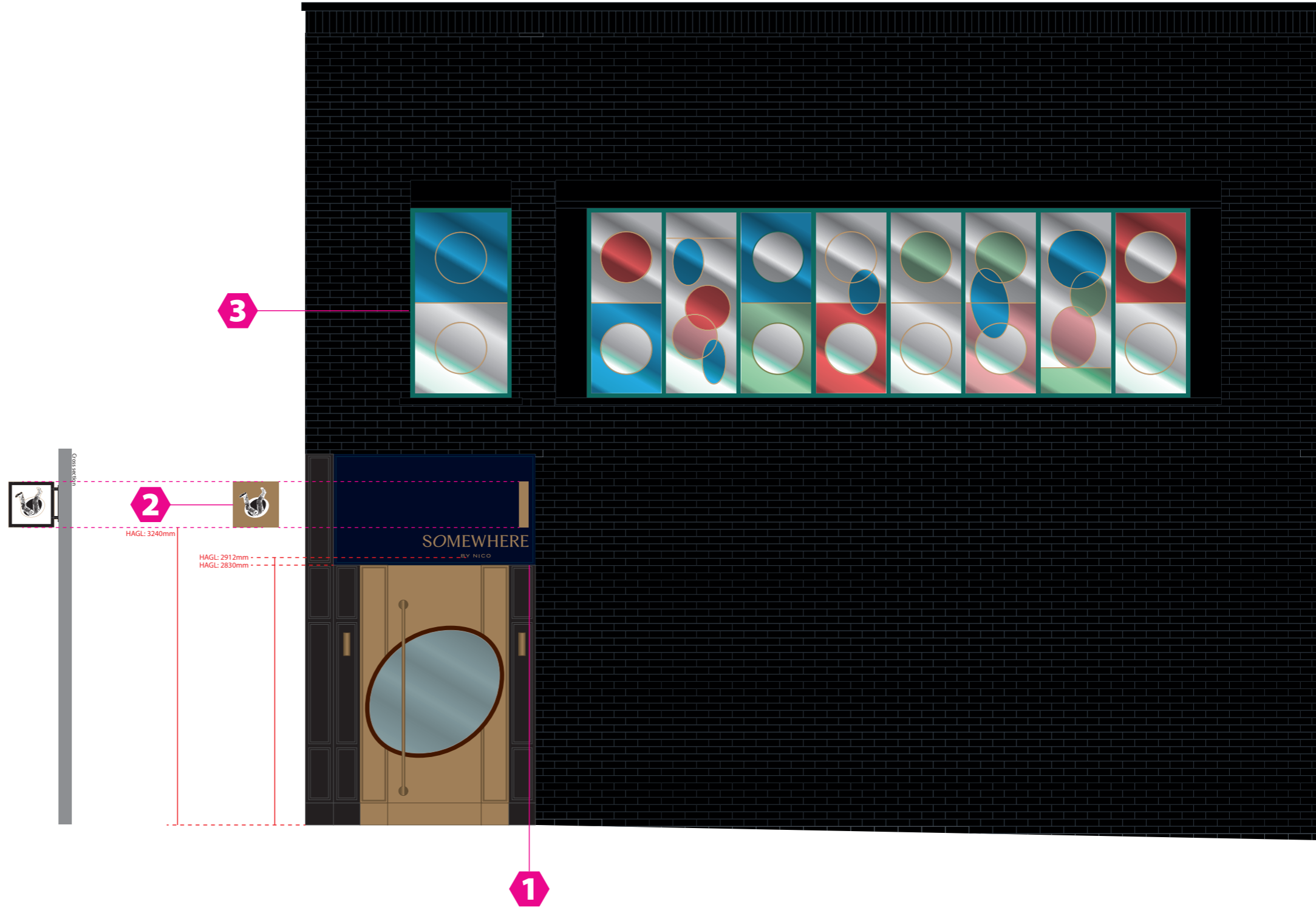

### 1. Main Fascia

Painted ACM tray to match RAL 5004 to replace existing fascia panels. Painted foam PVC frame around edge to match existing frames on panels around doors. 10mm foam PVC painted satin brass lettering to face. Somewhere stood off on brass mechanical fixings. by Nico bonded flat to tray with VHB tape

**Exact Size TBC**



1:10 @ A3

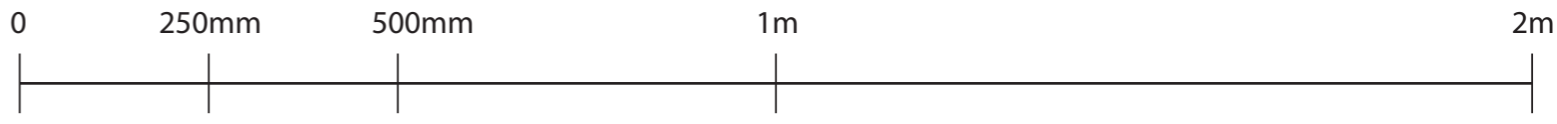

## 2. Projector Sign

Painted back to back Aluminium trays with satin brash finish to create double sided projector sign. Fret cut with pushthrough opal. Fixed to wall on feet with cowl that wraps around feet. Black Vinyl detail to go on opal for logo.

500mm x 500mm

**NEED VECTOR LOGO**

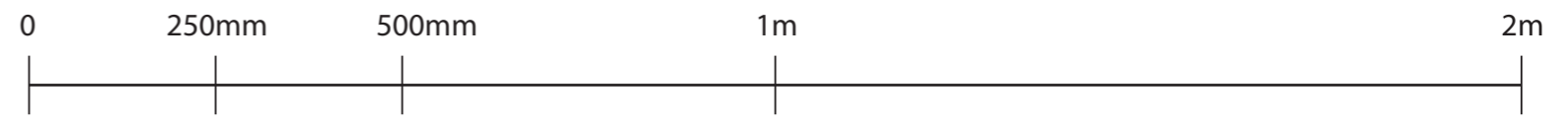
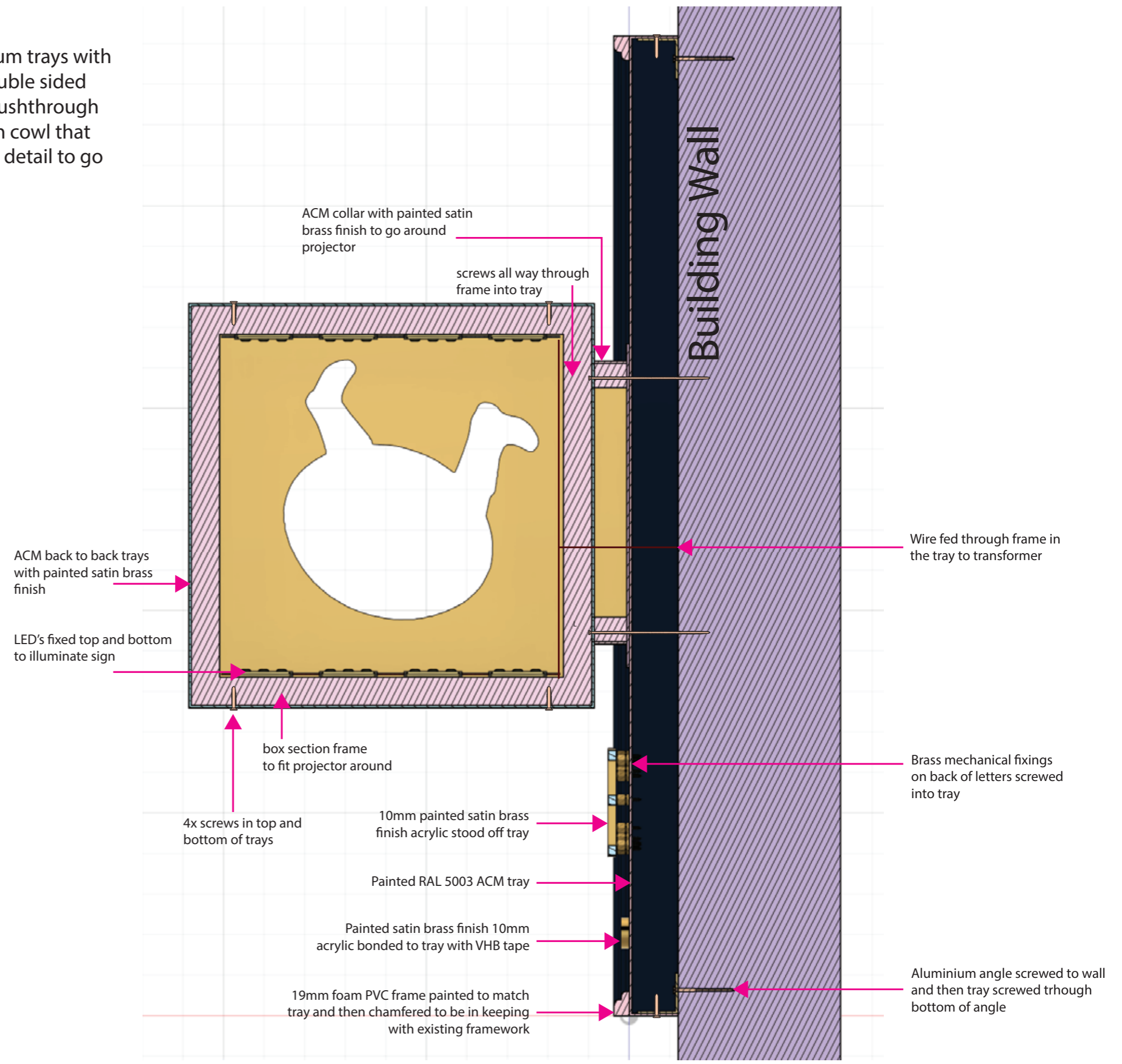

1:10 @ A3

SOMEWHERE  
BY NICO

231019 : 16th JANUARY 2024

V4.1  
GLASGOW PLANNING  
VISUAL





### 3. Windows

Mirror ACM panels with prints on clear overlaid where necessary for coloured detail  
Painted 19mm foam PVC brass finish detail for pattern. Tubes to be 19mm foam inner edge with 3mm foam at 70mm depth wrapped around outside.

**Exact Size TBC**

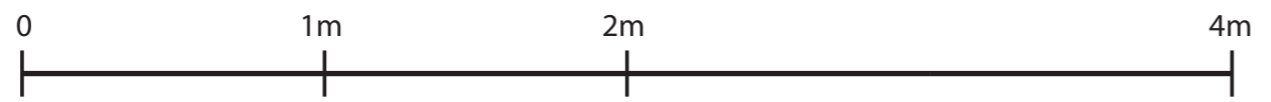
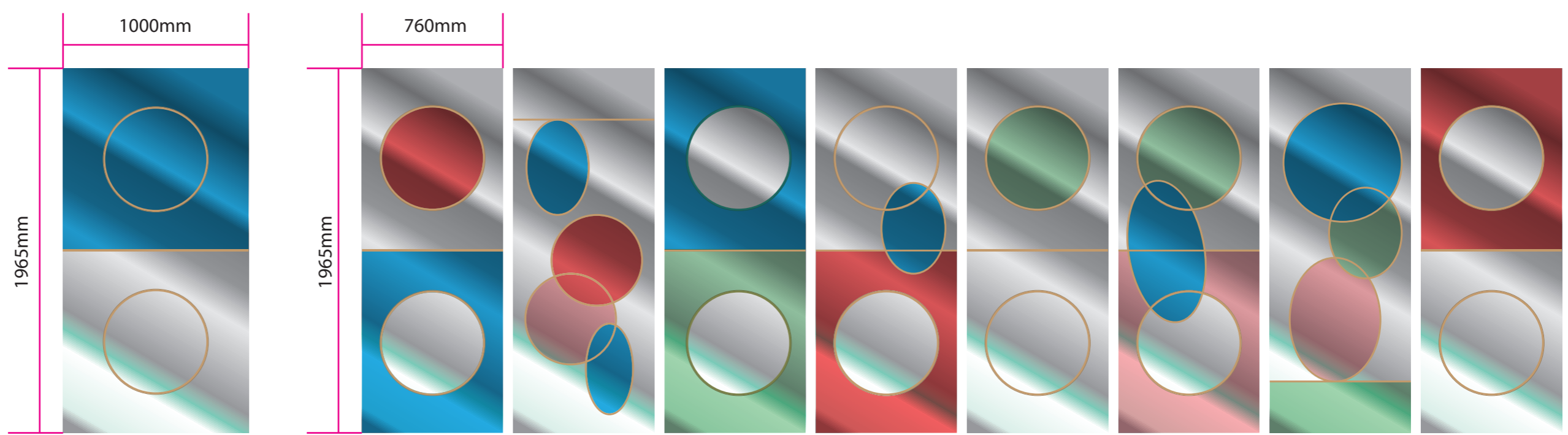

# V4.1 GLASGOW PLANNING VISUAL

1:10 @ A3

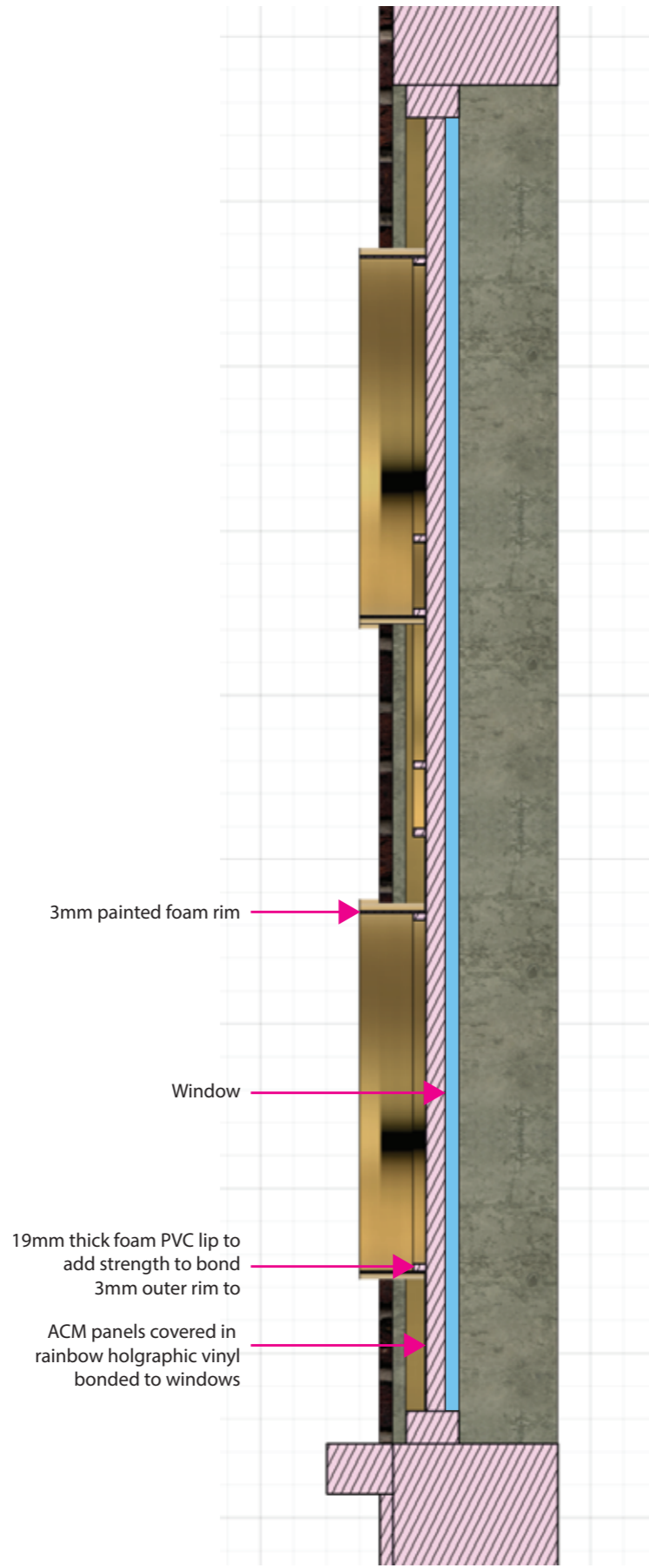



# V4.1 GLASGOW PLANNING VISUAL

