

FOOTPATH  
MARINE PARADE WEST

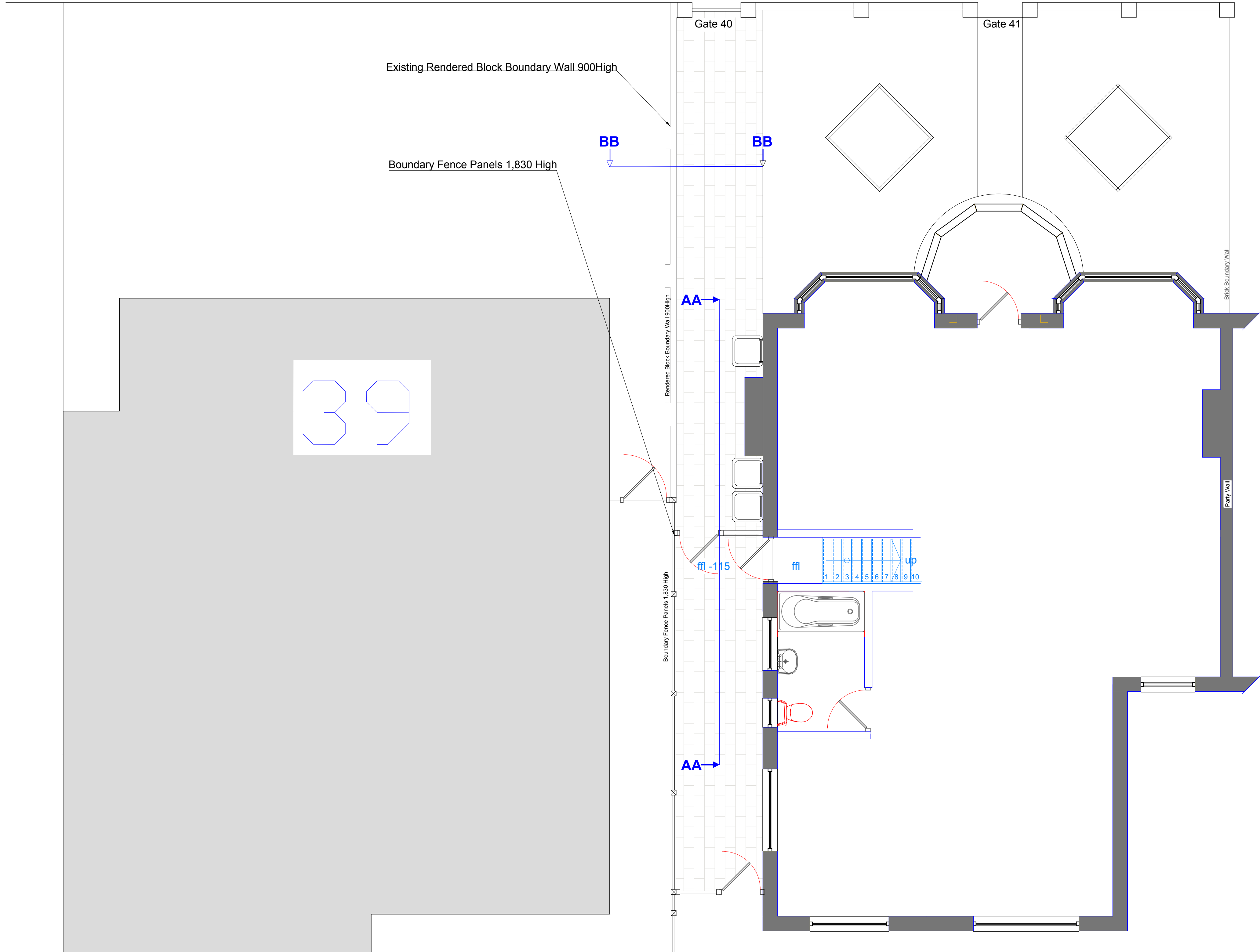

**EXISTING PLAN**

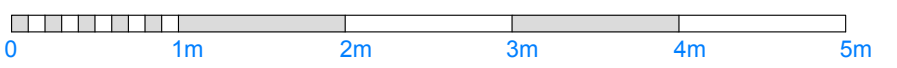

General Notes

1. Dimensions: mm, except as noted
2. Tolerance:  $\pm 5\%$
3. For Elevations see Sheet-5

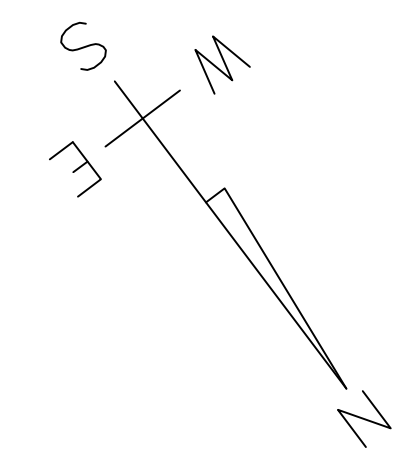

No.	Revision/Issue	Date
A	Initial Issue	24/10/23

Project Description  
**Alterations for  
 Andrew Willis to  
 40 Marine Parade West  
 Lee-On-The-Solent  
 PO13 9LW**

Drawing Title  
**Ground Plan  
 Existing**

Project Number <b>40MPW2024</b>	Sheet <b>Sheet 3 of 6</b>
Date <b>24/10/2023</b>	
Scale <b>As-noted</b>	