

W o o d h a l l C l o s e

Existing Site (Roof) Plan
scale 1:200 @ A3

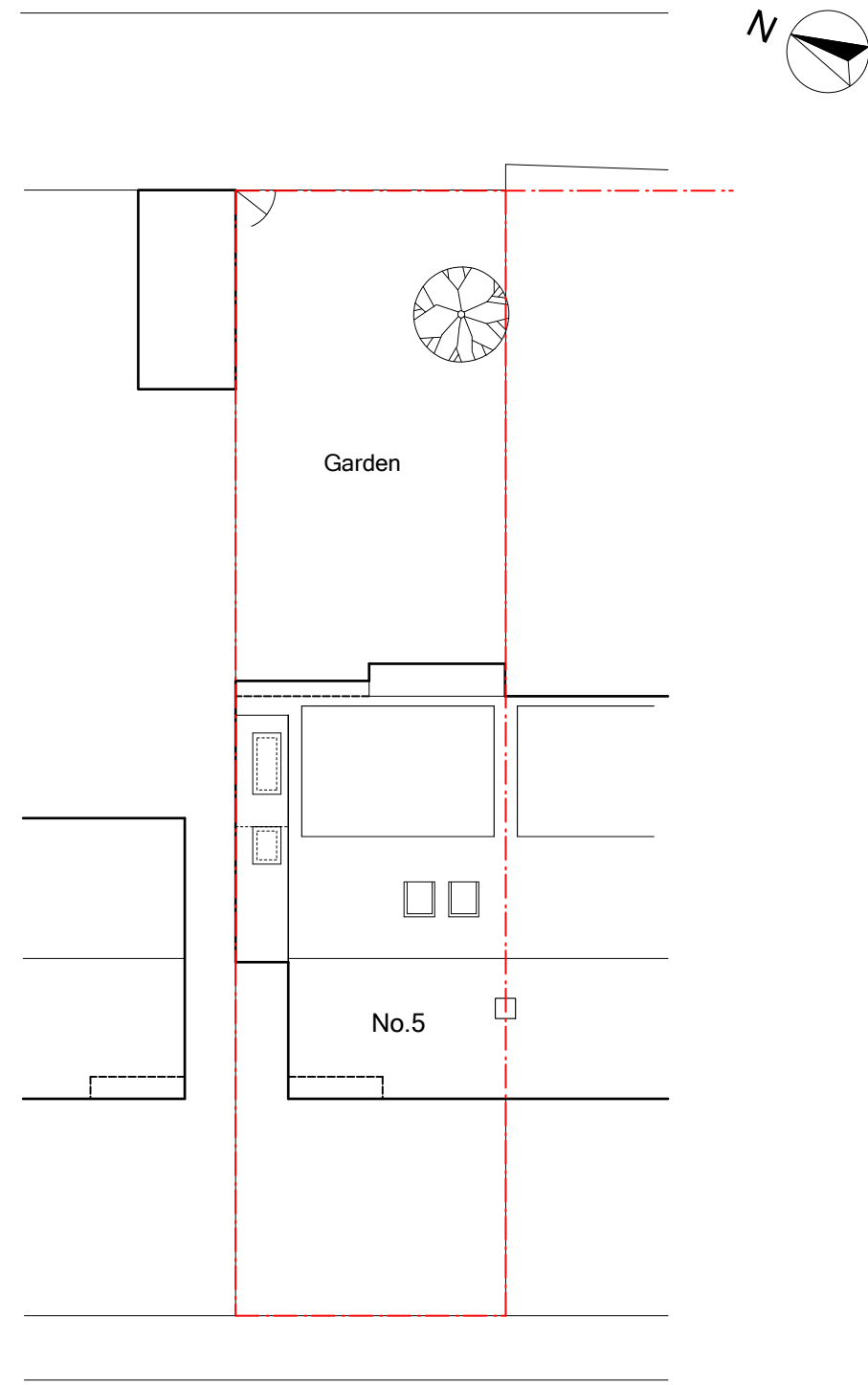

W o o d h a l l C l o s e

Proposed Site (Roof) Plan
scale 1:200 @ A3

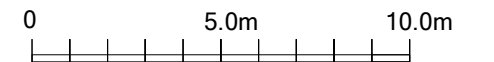

Note:
All dimensions to be checked on site. Any discrepancies to be reported to the Contract Administrator.

Date	Description	Rev.

Project: 5 Woodhall Close, Hertford		Title: Existing & Proposed Site Plan	
Client:		Date: 12.01.24	Scale: 1:200 @ A3
Drwg no.: 352-01	Rev:	Status: PLANNING	
ben lumley/Architect 43 Molewood Road, Hertford, Herts SG14 3AQ. T 07787 792253 email: benlumley1@gmail.com			