

LINN OF DEE PLACE

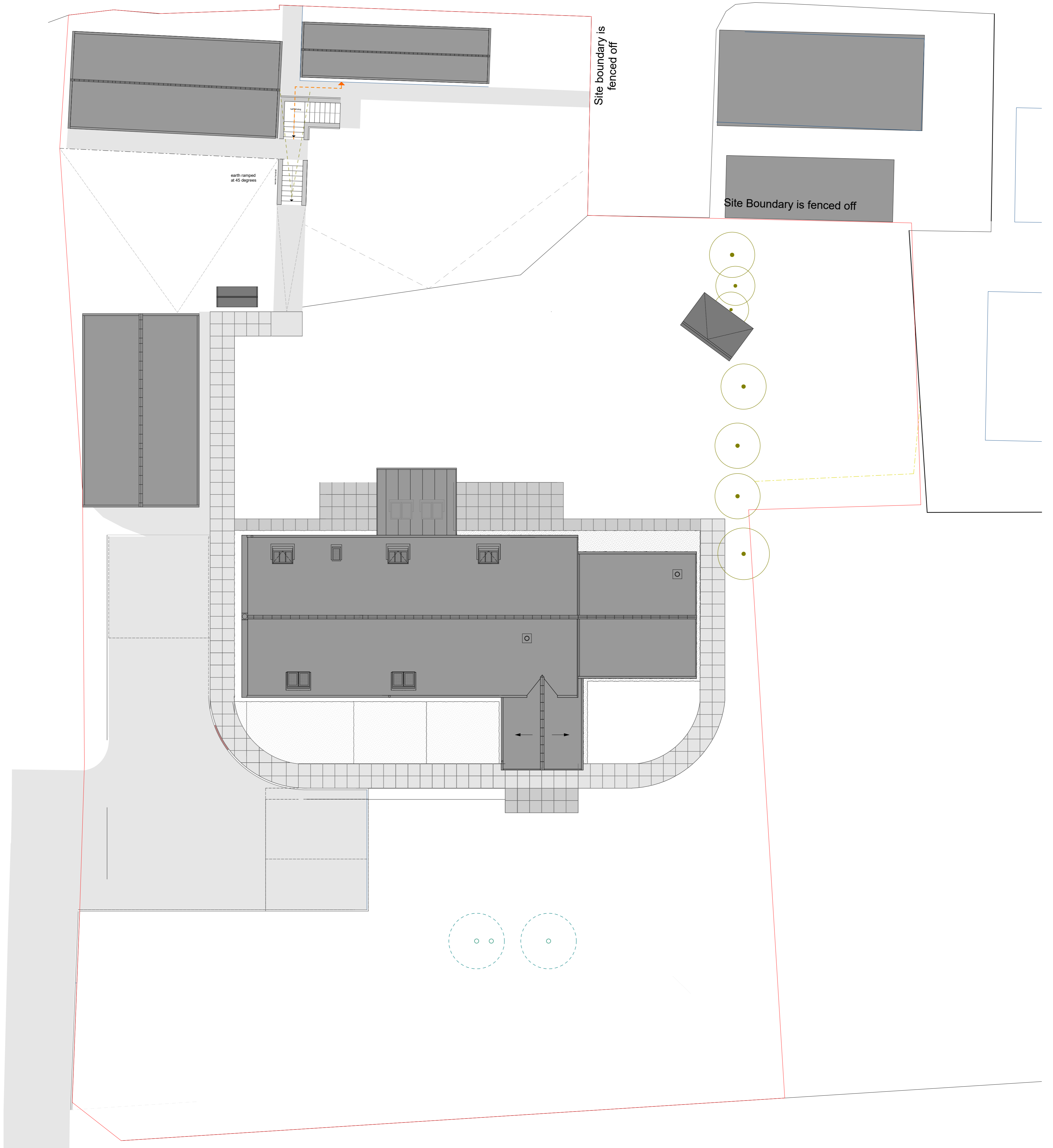

CHAPEL BRAE

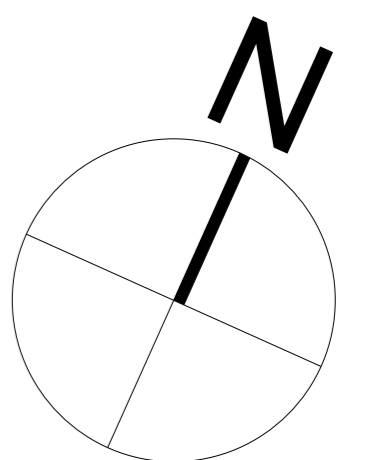
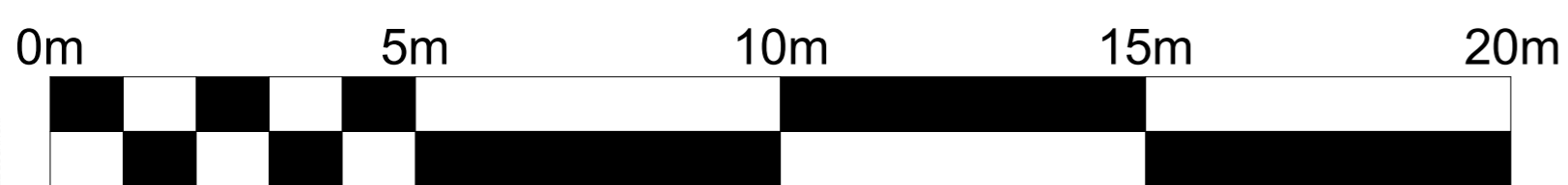

ICDP ARCHITECTS

PROJECT: SOLAR PANELS
 CLIENT: David Sherrard
PLANNING

DATE: 15/01/2024
 DRAWN: CF
 SCALE: 1:100
 PAPER SIZE: A1
 NAME: EXISTING SITE PLAN
 PROJECT: GW764- ICDP - 00 - XX - DR - A - L(-)02

REV	DATE	DRW	REVISION NOTES	CHK	APP
REVISION HISTORY					
STATUS:			SUITABILITY DESCRIPTION:		
REVISION:			REVISION DESCRIPTION:		

FILE LOCATION

Moorpark House, 11 Orton Place, Glasgow, G51 2HF 0141 445 3974
 info@icdparchitects.com www.icdparchitects.com