



All measurements & levels shown are subject to checking on site by the contractor, figured dimensions to take precedence over scaled.

All working dimensions must be taken from, checked & / or verified by the main contractor on site prior to the manufacture of all items & the placing at all work in hand. Working dimensions must not be scaled from this drawing. In all cases of doubt or discrepancy please refer to the architect, surveyor, supervising officer, consultants & / or specialist drawings are read in conjunction with this drawing.

All work must comply with the current building regulations, local authorities by-laws stipulations & requirements of statutory bodies.

Serve all notices to the authorities concerned. All work is to comply with the current editions of the British Standards Institution codes of practice.

All materials & components to comply with the current editions of the British Standards Institution specifications.

Prior to commencing work, the contractor is required to communicate with the relevant authorities, bring them to site & locate the positions and lines of all services (e.g. water, gas, electricity, telephone, telecommunication, sewage etc.) on, over, under & around the site which could in any way effect the positioning of the buildings. Copies of the correspondence & a full report of the findings must be forwarded to the architect, surveyor, supervising officer or consultant before building works commence.

All details in addition to those indicated to conform in all respects with the building regulations & allied legislation. Builder to check all details / dimensions prior to commencement of building works.

*This drawing is copyright*

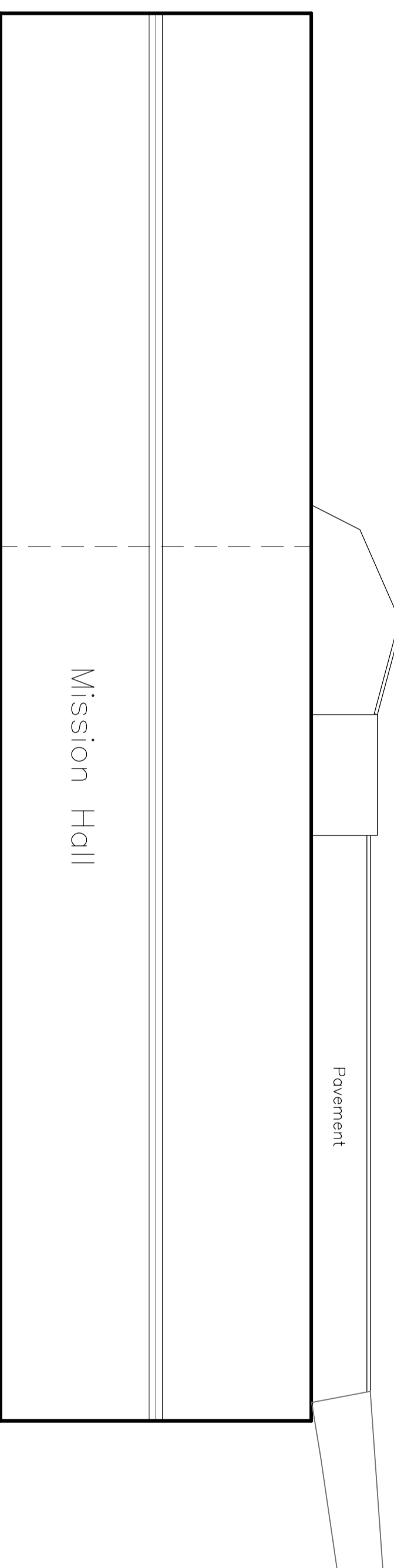

**NOTE:**  
Rear of site not surveyed prior to landscaping

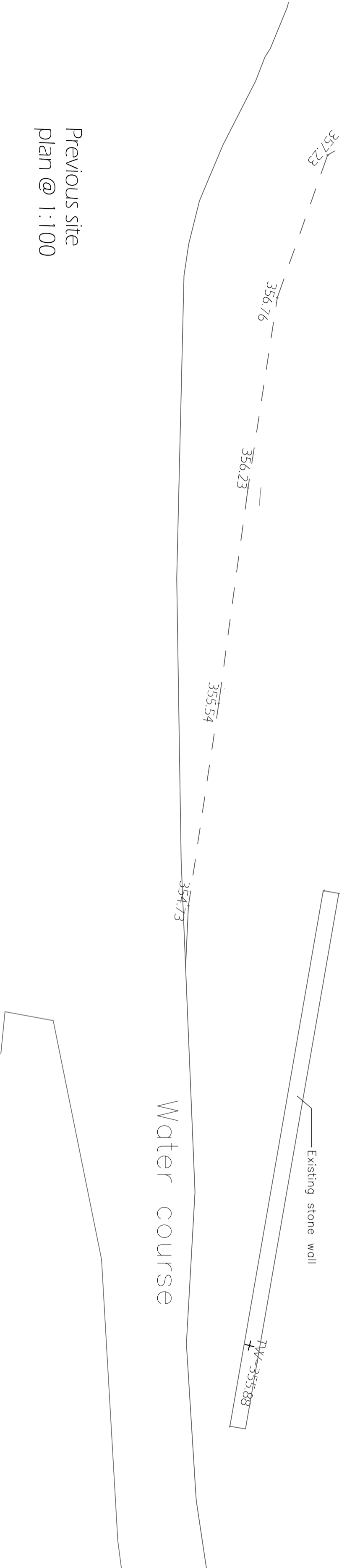

Previous site plan @ 1:100

**Client**

Fochriw Pentecostal Mission.

**Project**

External seating area, erect fence and change of site levels rear of Mission Hall, Guest Street, Fochriw, CF81 9NB

Date: October 2023

Scale: 1:100

Job No: 3207

Drawing No: 01

Revision	Date	Comment
•••••		

**Pemrose**  
architectural  
SERVICES

46 High Street,  
Pegarn,  
Blackwood,  
Gwent,  
NP12 3SZ.  
Tel: 01443 820 270  
www.pemrosewalfords.co.uk