

IMPORTANT NOTE:
ALL BASE DIMENSIONS TO BE WITHIN PLUS OR MINUS 5.0mm UNLESS OTHERWISE STATED

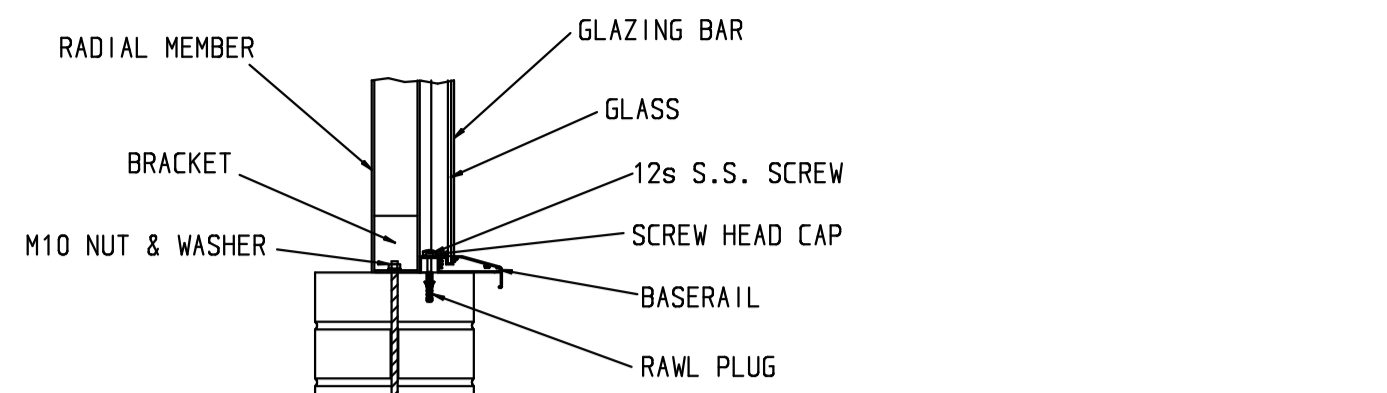

ROD DETAILS FOR 8 LOCATIONS

10mm STAINLESS STEEL ROD RESIN ANCHORED INTO WALL USING KEMFIX KB EPOXY RESIN OR SIMILAR. ROD TO BE THREADED M10 100mm FROM EACH END. (OR SCREWED BAR). PROTRUSION FROM TOP OF WALL TO BE 50mm PLUS OR MINUS 10mm. RODS TO BE INSERTED TO A MINIMUM DEPTH OF 100mm INTO FOUNDATION. HOLE SIZE IN FOUNDATION = 4MM LARGER THAN ROD DIAMETER. THE RODS ARE THE CLIENTS/BUILDERS RESPONSIBILITY.

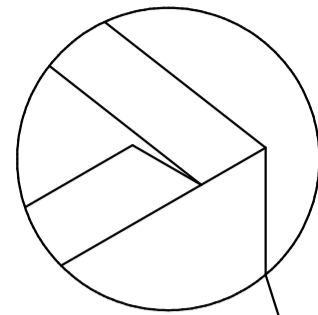

SOLID HEADER BRICK TO BE USED ACROSS WALL TOP - NO HOLES OR FROGS

M10 RODS - 8 POSITIONS - SEE DETAIL A

750±0.0 ABOVE THRESHOLD

IMPORTANT NOTE
IF THE 210mm WALL DIMENSIONS IS TO CHANGE THEN HARTLEY BOTANIC MUST BE NOTIFIED IMMEDIATELY.

PLEASE NOTE: CLIENT / BUILDER TO INSTALL RODS - SEE DETAIL A

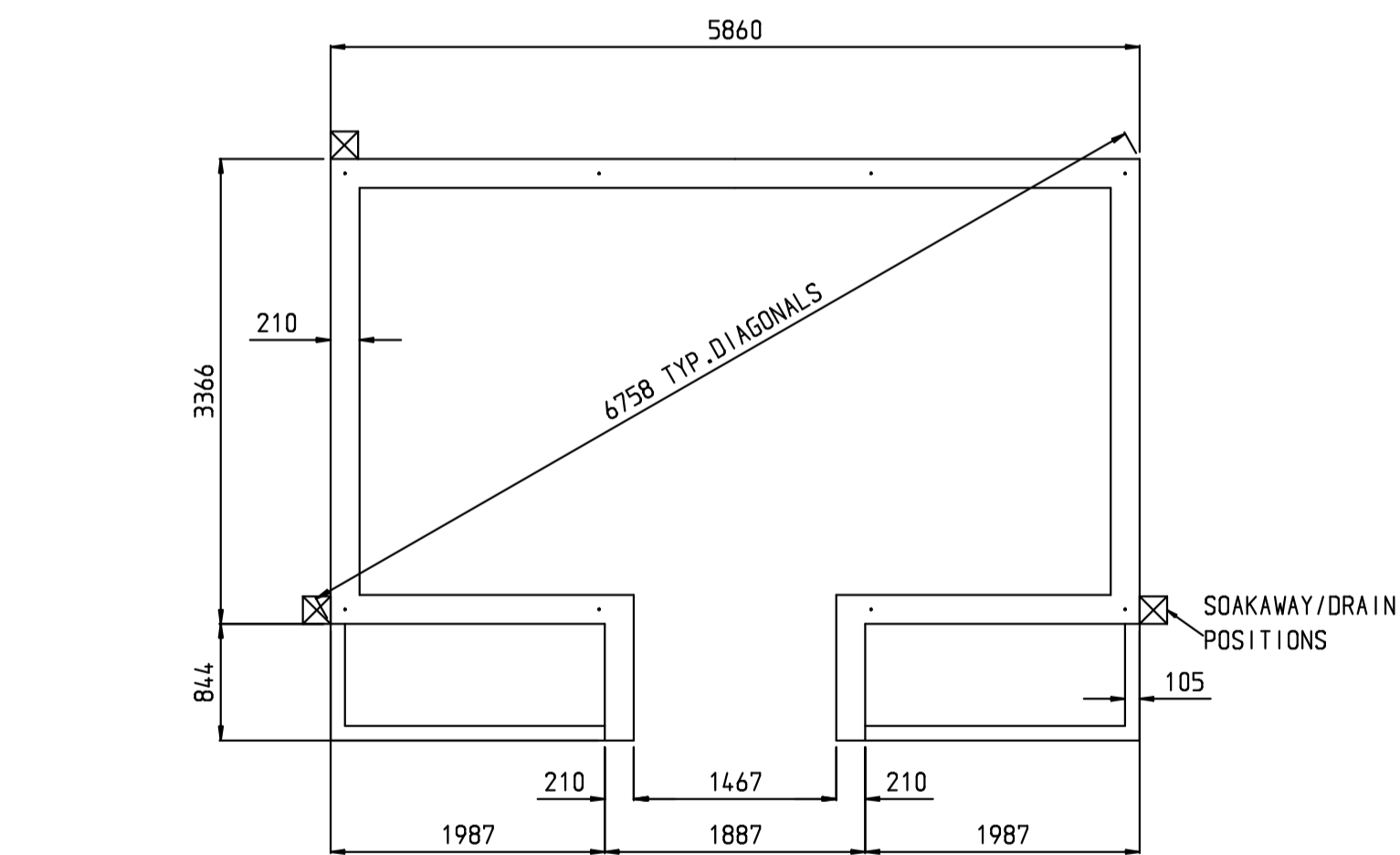

ISOMETRIC WALL LAYOUT

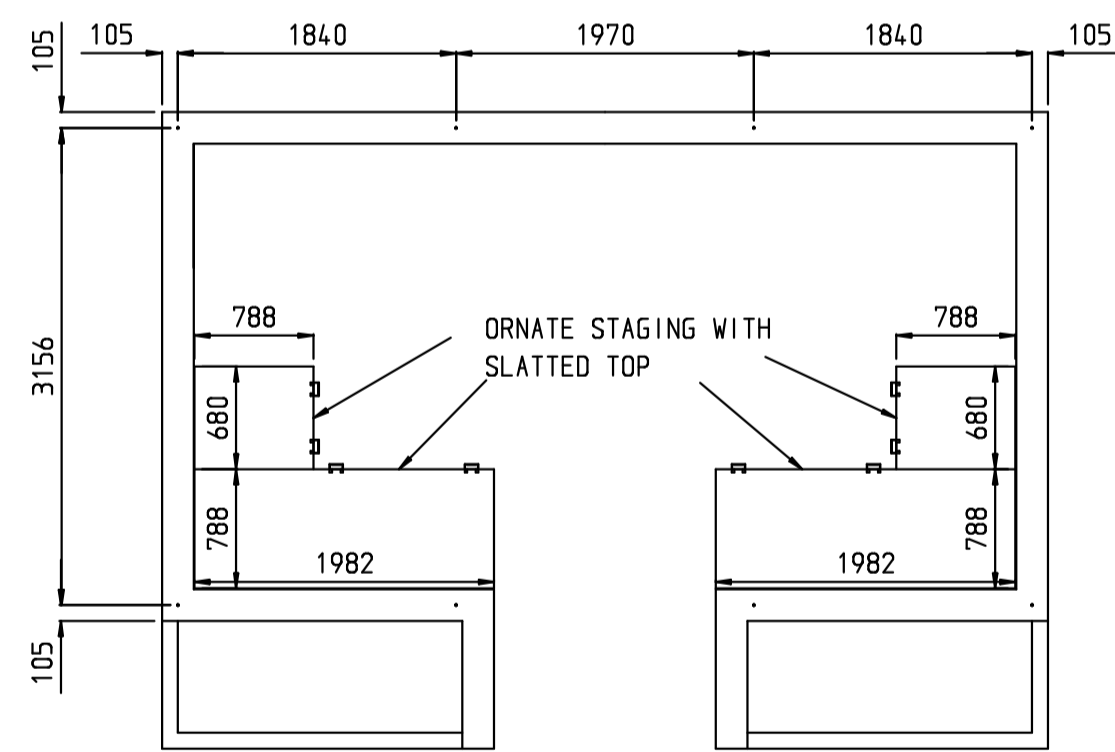

WALL PLAN SHOWING ROD & STAGING POSITIONS - SEE DETAIL A + STAGING

STONE WORK NOTES ARE AVAILABLE ON REQUEST FROM HARTLEY BOTANIC

NOTES RELATING TO FOUNDATION AND WALLING (CLIENTS RESPONSIBILITY)

All brickwork to be constructed with a minimum compressive strength of 20N/mm bricks using mortar designation to BS5268: Part 1:1992 Table 1. See table below for mix details of standard class mortar designation.

Type of Mortar (portion by volume)	1:	1.5 to 6
Cement: Lime: Sand	1:	1.5 to 6
Masonry Cement: Sand	1:	4 to 5
Cement: Sand with Plasticizer	1:	5 to 6

The mixing and use of mortars should be in accordance with the recommendations given in BS5268: part 3 or BS5390. Ready mix mortars should comply with the requirements of BS4721 and be equivalent to the above specification.

All facing brickwork from 150mm above ground level to be constructed using type MN or ML bricks (BS3921) with water absorption not exceeding 12%.

All brickwork up to 150mm above ground level from the top of the foundation to be constructed with engineering class B bricks with water absorption not exceeding 7%.

For fully bonded construction, the brickwork is to be constructed in either of the following:

A: English bond - one course of headers and one course of stretchers alternately.

B: Flemish bond - headers and stretchers alternately in the same course.

C: Stretcher bond - If the wall is to be constructed with two parallel leaves, this is to be half stretcher bond with no cavity. Wall ties are to be provided at centres not exceeding 450mm vertical and 450mm horizontal. All wall ties to be of the stainless steel double triangle type to BS1243 and in accordance with DD140: part 2: 1987 and BS5268: part 3: 1985.

If a damp proof course is to be used, the membrane must have mortar above and below (effectively sandwiched in the mortar bed), and must not lie directly against the brickwork.

If a damp proof course is not used, then it is recommended that a waterproofing agent is added to the mortar mix.

The foundation, or footing should be of a suitable depth to suit local ground conditions. The depth of the foundation is the client/builder's responsibility.

Client/Builder to install wall rods & lead flashing if not otherwise specified.

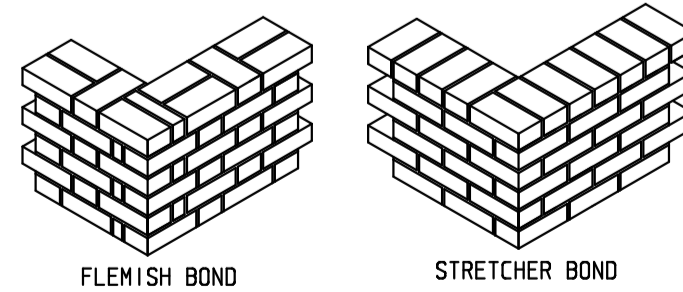

FLEMISH BOND

STRETCHER BOND

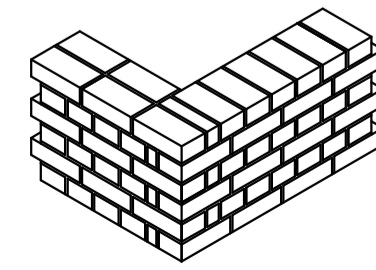

ENGLISH BOND

PLEASE READ ALL INSTRUCTIONS BEFORE COMMENCING. IF YOU HAVE ANY DOUBTS AS TO THE SPECIFICATIONS THAT WE REQUIRE PLEASE CONTACT HARTLEY BOTANIC LTD.

DO NOT SCALE

IF IN DOUBT CONTACT HARTLEY BOTANIC

PLEASE NOTE: A CLEARANCE OF 500mm MINIMUM IS REQUIRED AROUND THE ENTIRE PERIMETER OF THE GLASSHOUSE FOR ACCESS

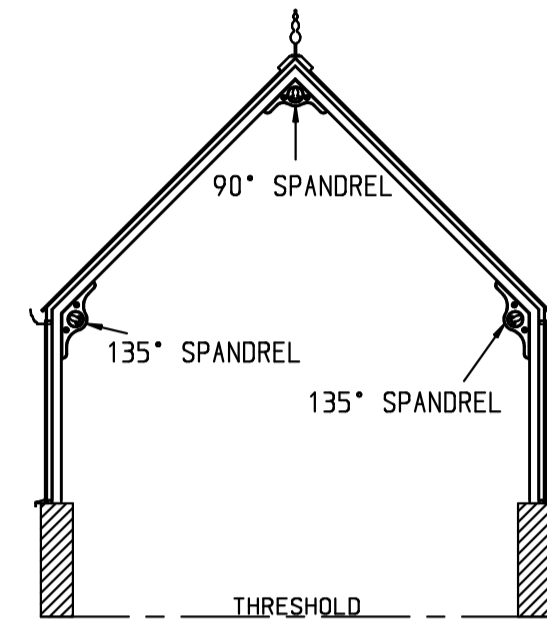

SECTION A - A SHOWING SPANDRELS TO EAVES AND RIDGE

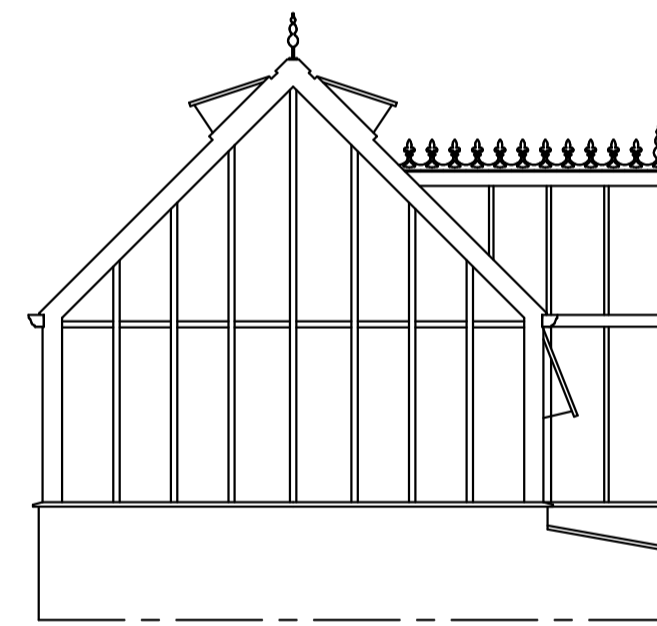

LEFT ELEVATION

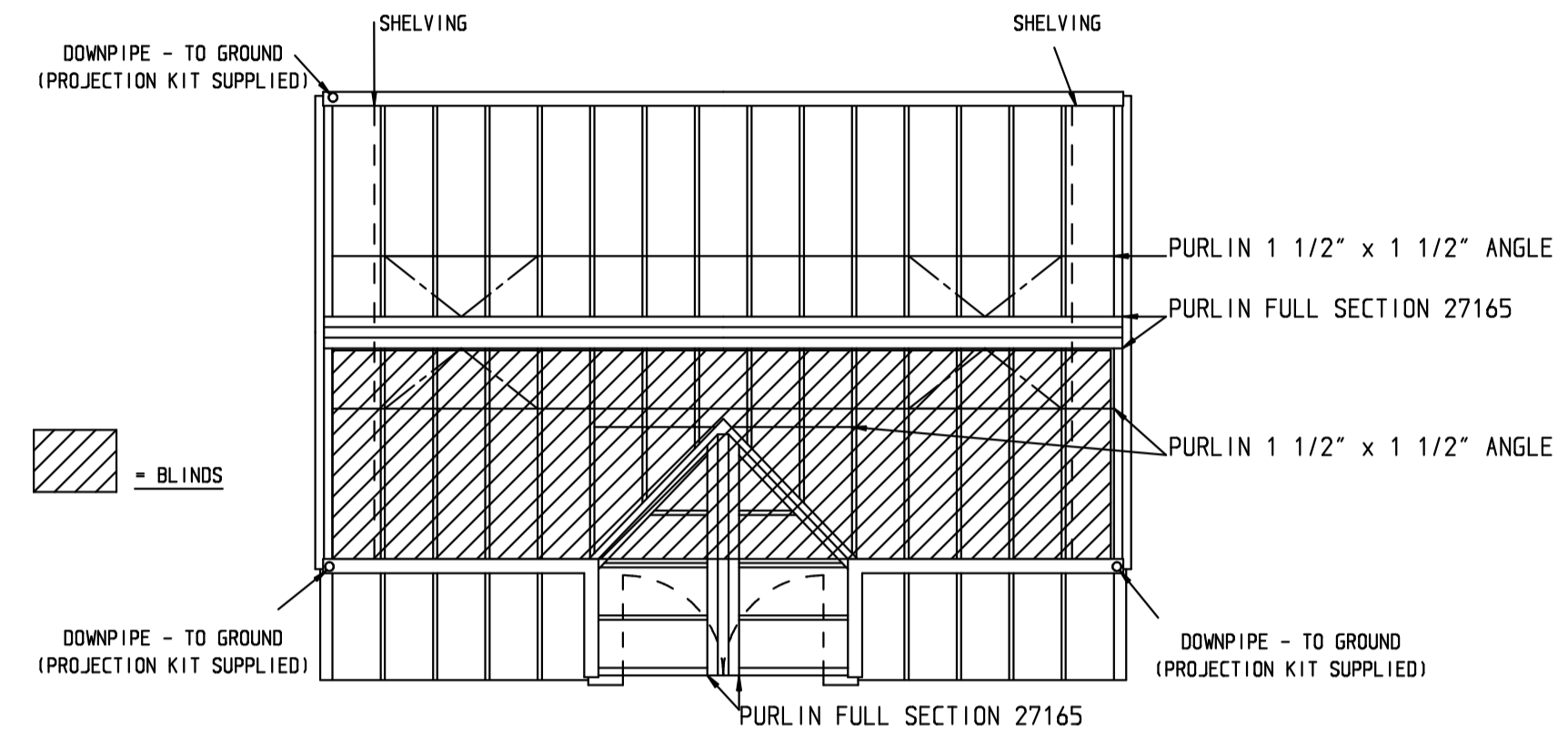

PLAN VIEW

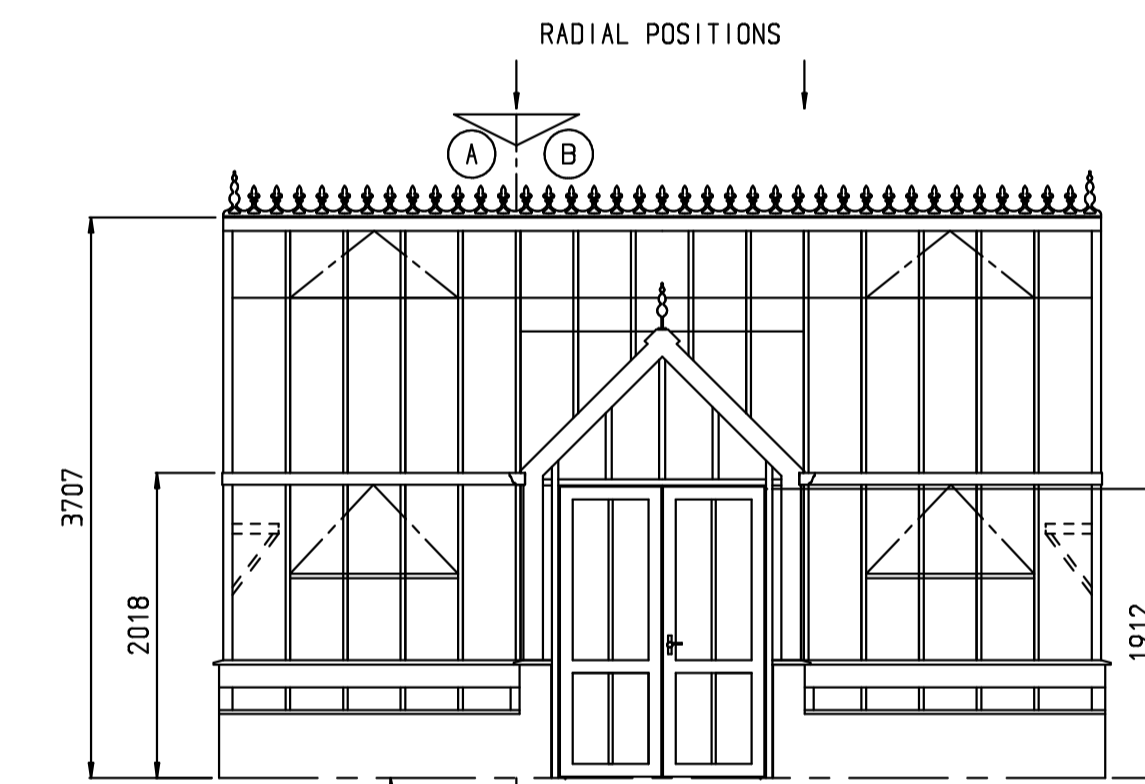

FRONT ELEVATION

THRESHOLD AND INTERIOR PATH LEVEL WHICH SHOULD BE SLIGHTLY ABOVE NORMAL GROUND LEVEL THE THRESHOLD LEVEL IS THE LEVEL AT WHICH THE DOOR WILL OPERATE WITH NORMAL CLEARANCE THIS SHOULD BE THE FINISHED FLOOR LEVEL INSIDE THE GLASSHOUSE WALLTOP TO BE 750mm PLUS OR MINUS 0.0mm ABOVE THRESHOLD.

REAR DOWNPIPE POSITION - PLEASE TICK: LHS RHS

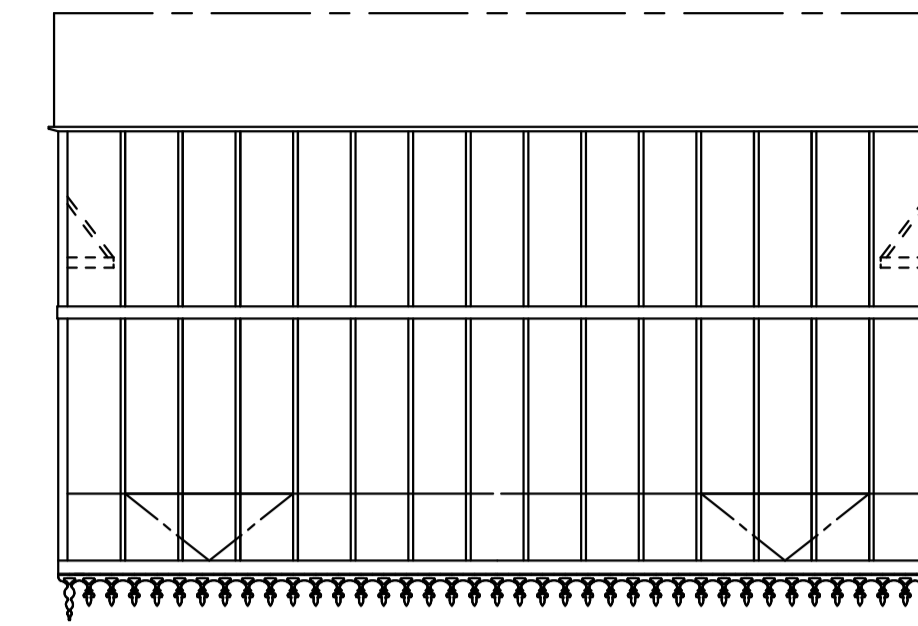

REAR ELEVATION

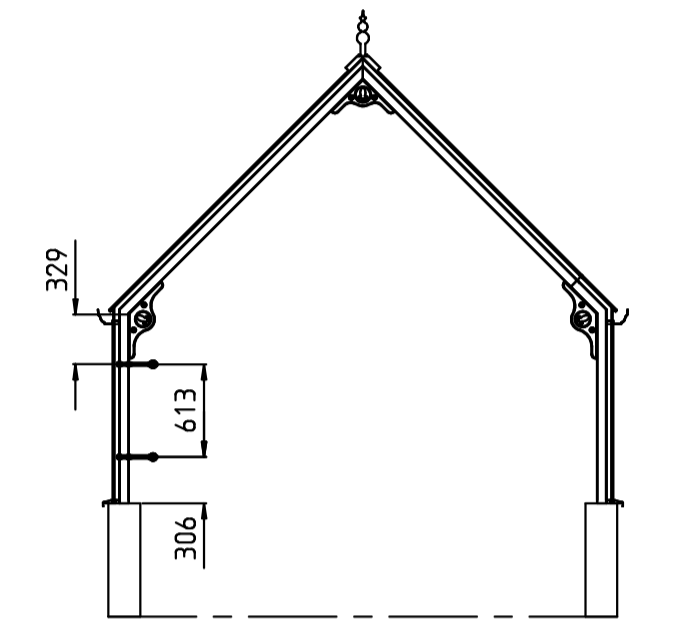

SECTION B - B SHOWING VINE EYE POSITIONS

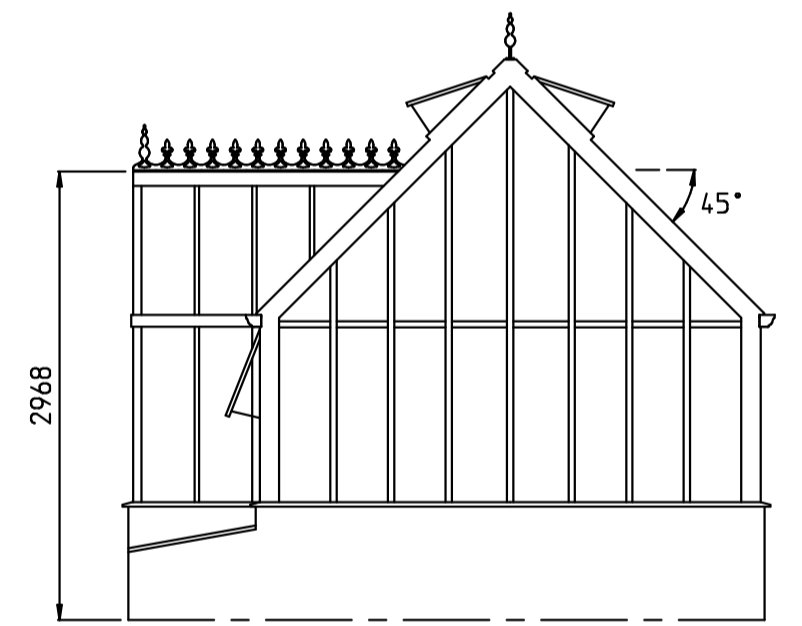

RIGHT ELEVATION

GENERAL NOTES:
STRUCTURE BUILT IN ALUMINIUM ALLOY
POLYESTER POWDER COATED HYPCA WHITE RAL 9910
ROOF VENTS OPERATED BY AUTOVENTS
VERTICAL FACE VENTS OPERATED BY SWING THROWS
GLAZED IN TOUGHENED SAFETY GLASS
CAST ALUMINIUM RIDGE CRESTING & FINIALS FITTED TO RIDGE
ALUMINIUM SWING DOOR COMPLETE WITH LOCKS & POLISHED NICKEL HANDLES
OGEE ALUMINIUM GUTTERS
SHELIVING AS DETAILED
BLINDS AS DETAILED
COLDFRAMES AS DETAILED
STAGING AS DETAILED
SPANDRELS TO EAVES & RIDGE ON ALL MAIN RADIALS
POTTING SHOE
2 x WHITE POWDER COATED LIGHTS HUNG EVENLY IN THE RIDGE
FOR CLIENTS ELECTRICIAN TO WIRE UP
2 x ROWS OF VINE EYES AND WIRE TO ENTIRE REAR ELEVATION

THESE DETAILS MUST BE ADHERED TO
IF YOU HAVE DOUBTS RELATING TO THESE DETAILS
PLEASE CONTACT HARTLEY BOTANIC LIMITED



SCALE FOR DRAWING IN METRES

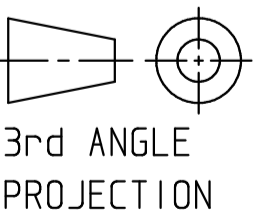

DESCRIPTION:
GENERAL ARRANGEMENT DRAWING
THE VICTORIAN LODGE GLASSHOUSE
WITH DOUBLE DOOR PORCH

CLIENT:- MR & MRS SONTER
SOUTH MERE HALL
DOCKING ROAD
SEDFORD
PE36 5LL

HARTLEY BOTANIC LIMITED
Wellington Road, Greenfield,
Oldham, Lancashire, OL3 7AG.
Tel: 01457 821958 Fax: 01457 821967

DRAWN: BY	MODIFICATION:	CHECKED: PH
DATE: 05/12/2022	SCALE: 1:50	
DRAWING No: HB25326-001	ORDER No: HB25326	
ISSUE A		