

# The Old Railway Line Garden Centre

**LEGEND**  
PLEASE NOTE: INTERNAL LAYOUT INDICATIVE ONLY.

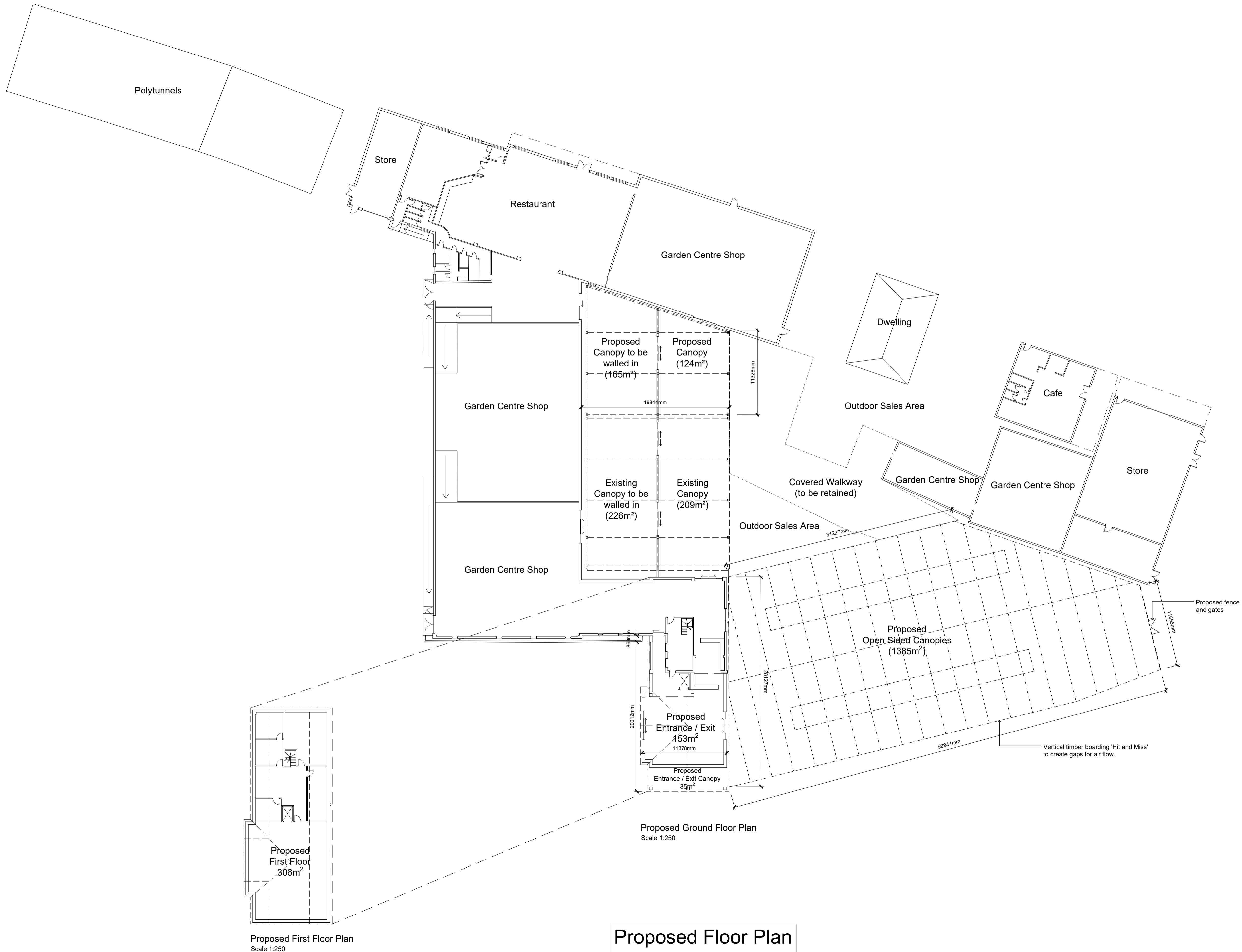

D	Internal layout note added to Legend.	STM	29.08.2023
C	Door and window positions adjusted to Proposed Entrance and Existing and Proposed Canopies to be walled in. Vertical boarding indicated to Proposed Open Sided Canopies.	STM	25.08.2023
B	Overall building layout adjusted. Text labels amended.	STM	27.07.2023
A	Floor Plan amended.	gs	14.06.2023

Rev.	Notes	A/mtd	Date
------	-------	-------	------

<b>DRAWING STATUS:</b> <b>PLANNING</b>	
PROJECT: The Old Railway Line G.C. Site Improvements	
CLIENT: The Old Railway Line G.C.	
TITLE: Proposed Floor Plan	
DATE: March 2023	DRAWN: gs
SCALE: 1:250 @ A1	CHECKED:
DRAWING N°: M14.205(a).D.014	REVISION: D

**PleydellSmithyman**

THIS DRAWING MAY NOT BE USED WITHOUT THE CONSENT OF:

PLEYDELL SMITHYMAN LIMITED  
20a, THE WHARFAGE, IRONBRIDGE, SHROPSHIRE, TF8 7NH.

TEL: 01952 433211 FAX: 01952 433323  
EMAIL: [ps@pleydellsmithyman.co.uk](mailto:ps@pleydellsmithyman.co.uk)  
WEBSITE: [www.pleydellsmithyman.co.uk](http://www.pleydellsmithyman.co.uk)

**Proposed Floor Plan**