

This drawing is COPYRIGHT. It must not be reproduced or disclosed to third parties without our prior permission. Do not scale from this drawing, or, interrogate and use electronic information.

Any discrepancies should be reported immediately.

Any surveyed information incorporated within this drawing cannot be guaranteed as accurate unless confirmed by a fixed dimension. All dimensions are in millimetres unless noted otherwise.

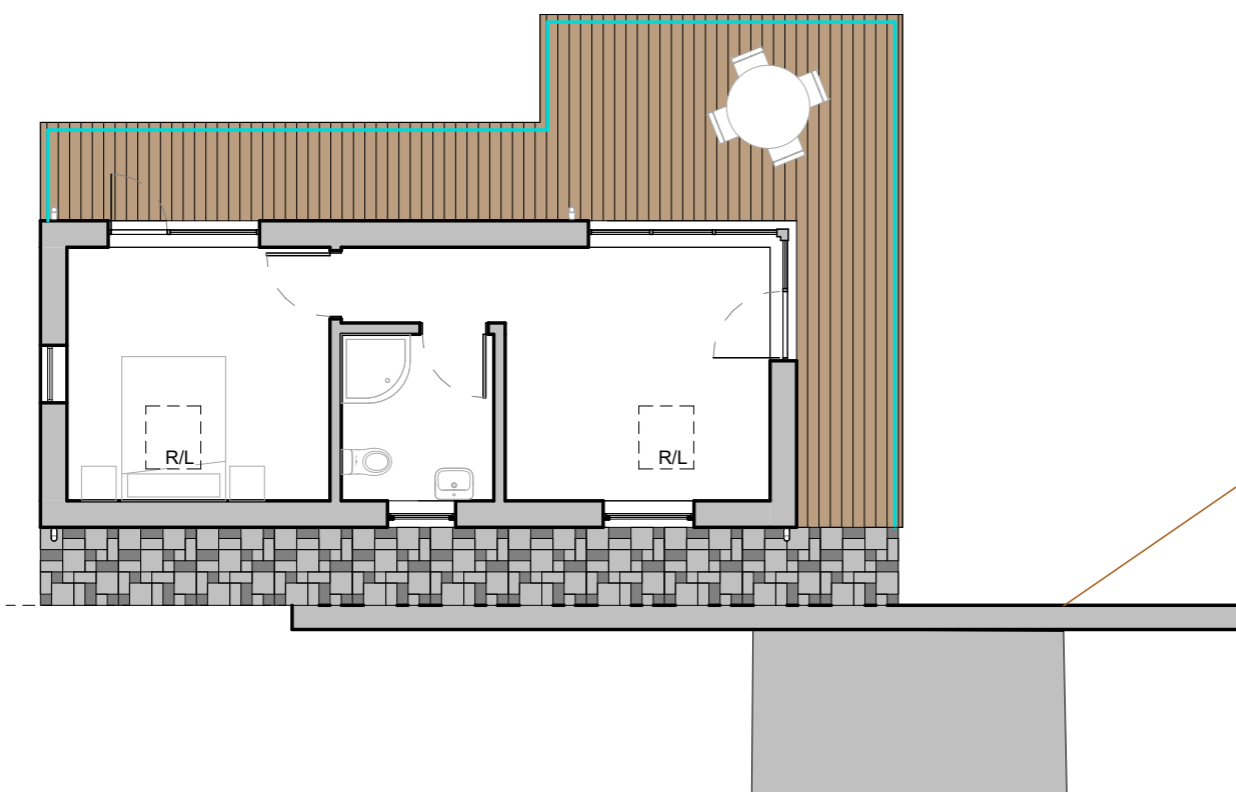

### Key

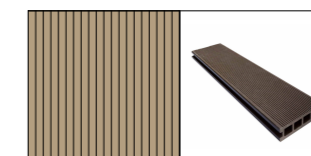

#### Composite Decking

Hatch denotes are to be laid to composite decking. All decking board and fittings etc. to be sourced from Eurocell. Decking boards to be grooved decking boards in Wild Brown.



#### Reclaimed Slab and Cobble Pathway

Hatch shows area of new pathway to comprise of a reclaimed concrete slabs and cobbled stone. New slabs are as per the reference image to the left. New cobbled stone to be Scottish Cobbles (50-75mm) sourced from Paving Direct. Cobbles to be inset into concrete bed to provide a finish similar to that of the image to the left.

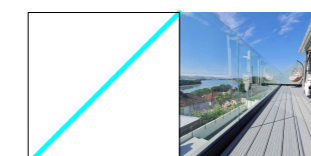

#### New Glass Balustrade

New Sabco Glass Balustrade System to be installed. Balustrade to be sourced from Balustrade Superstore and installed in strict accordance with their guidance and specifications.

## External Landscaping Plan

1 : 100

**HUGHES**  
ARCHITECTS

Head Office  
29 Broad Street  
Newtown  
Powys  
SY16 2BQ  
t - 01686 610311  
w - www.hughesarchitects.co.uk

Project :- <b>New Annex at Pen Y Bont, Cemmaes Road, Machynlleth, Powys SY20 8JY</b>			
Drawing Status :- <b>Stage 3a - DOC</b>		Drawing Title :- <b>Condition 8 - External Landscaping Plan</b>	
Scale :- <b>1 : 100</b>	Date :- <b>11.12.23</b>	Drawing No :- <b>Y038.3a. 3.800</b>	Rev :-
Drawn by :- <b>KT</b>	Checked :- <b>-</b>		