

- General Notes
1. All dimensions are to be checked onsite. Do not scale from these drawings.
  2. Structural information on drawings is shown for quick reference only. Refer to Structural Engineers drawings and calculations for construction information.
  3. Building Regulations compliance is the responsibility of the contractor.

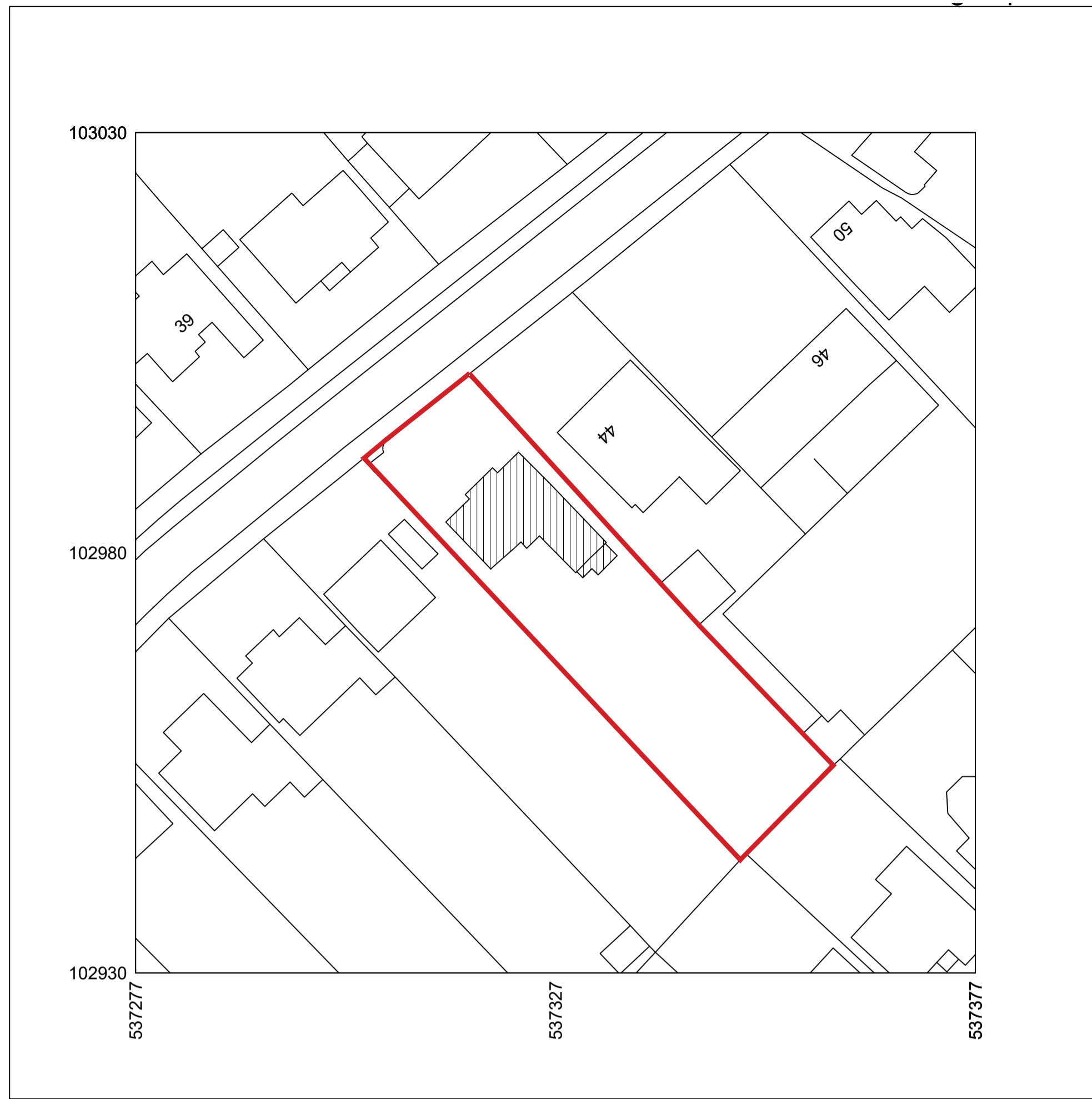

Produced on 04 December 2023 from the Ordnance Survey National Geographic Database and incorporating surveyed revision available at this date.  
 This map shows the area bounded by 537277 102930,537377 102930,537377 103030,537277 103030,537277 102930  
 Crown copyright and database rights 2023 OS 100054135. Supplied by copla ltd trading as UKPlanningMaps.com a licensed Ordnance Survey partner (OS 100054135).  
 Data licence expires 04 December 2024. Unique plan reference: v1e//1033500/1393119

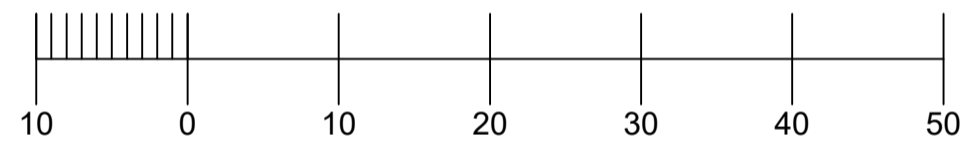

Existing Block Plan 1:500



Produced on 04 December 2023 from the Ordnance Survey National Geographic Database and incorporating surveyed revision available at this date.  
 This map shows the area bounded by 537277 102930,537377 102930,537377 103030,537277 103030,537277 102930  
 Crown copyright and database rights 2023 OS 100054135. Supplied by copla ltd trading as UKPlanningMaps.com a licensed Ordnance Survey partner (OS 100054135).  
 Data licence expires 04 December 2024. Unique plan reference: v1e//1033500/1393119

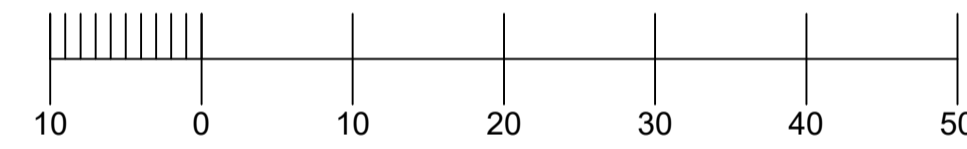

Proposed Block Plan 1:500

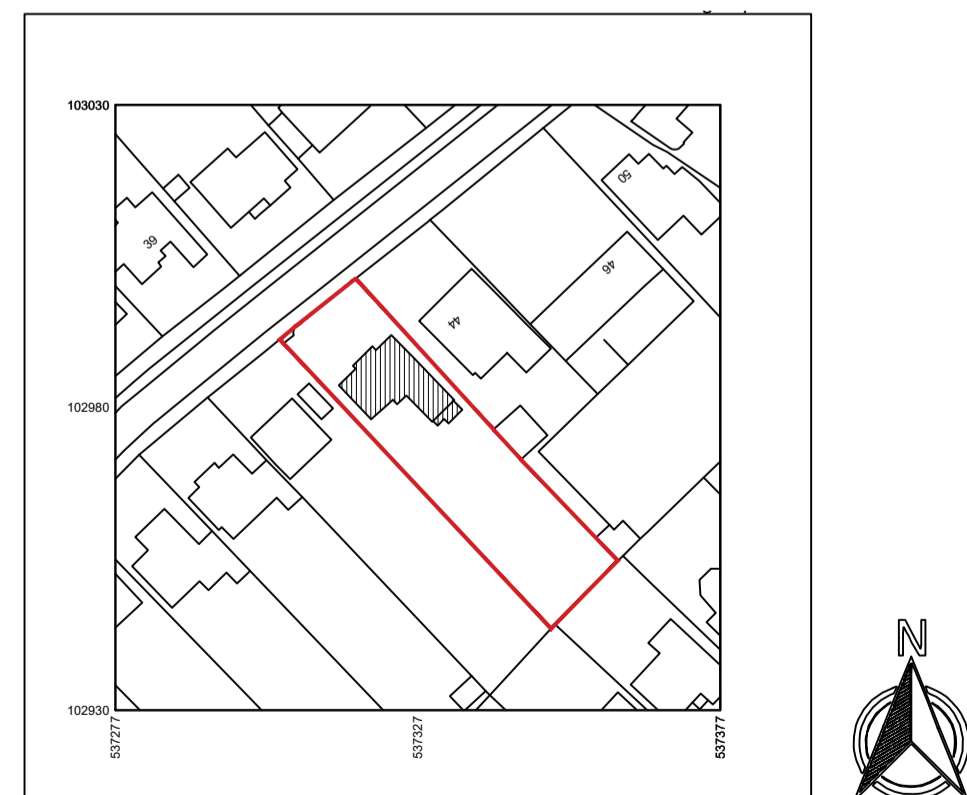

Produced on 04 December 2023 from the Ordnance Survey National Geographic Database and incorporating surveyed revision available at this date.  
 This map shows the area bounded by 537277 102930,537377 102930,537377 103030,537277 103030,537277 102930  
 Crown copyright and database rights 2023 OS 100054135. Supplied by copla ltd trading as UKPlanningMaps.com a licensed Ordnance Survey partner (OS 100054135).  
 Data licence expires 04 December 2024. Unique plan reference: v1e//1033500/1393119



Location Block Plan 1:1250

Rev	Date	Description
-----	------	-------------



puzzlearchitecture.co.uk  
 contact@puzzlearchitecture.co.uk



## Planning

Drawing Ref  
**Block and Location Plan**

Project  
**42 Gorham Avenue, Rottingdean  
 Driveway and Balcony**

Project No	Drawing No	Rev	
22.23.GA	102		
Drawn	Checked	Scale	Date
LC	LC	See details	07.09.23