

NOTES  
Do not scale from this drawing. Only figured dimensions are to be taken from this drawing.

Contractor must verify all dimensions on site before commencing any work or shop drawings.

Report any discrepancies before commencing work to GW Architectural. If this drawing exceeds the quantities taken in any way the practice should be informed before the work is initiated.

Work within the Construction (Design & Management) Regulations 2015 is not to start until a Construction Phase Plan has been produced. All work is to be carried out in accordance with good building practice and any relevant legislation, British Standards, Codes of Practice, etc. in force at the time of the execution of the works.

This Drawing is Copyright and must not be reproduced without consent of GW Architectural

Drawing Status/Type Key:

- F - Feasibility stage drawing
- P - Planning stage drawing
- T - Tender stage drawing
- C - Construction stage
- AB - As Built Status
- TNT - Tenant drawing
- SK - Sketch drawing
- M - Marketing drawing
- L - Landscape Drawing
- S - Survey drawing
- OS - Ordnance Survey drawing

Rev. Description Drawn Date Ch'ked Date

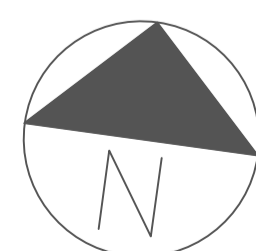
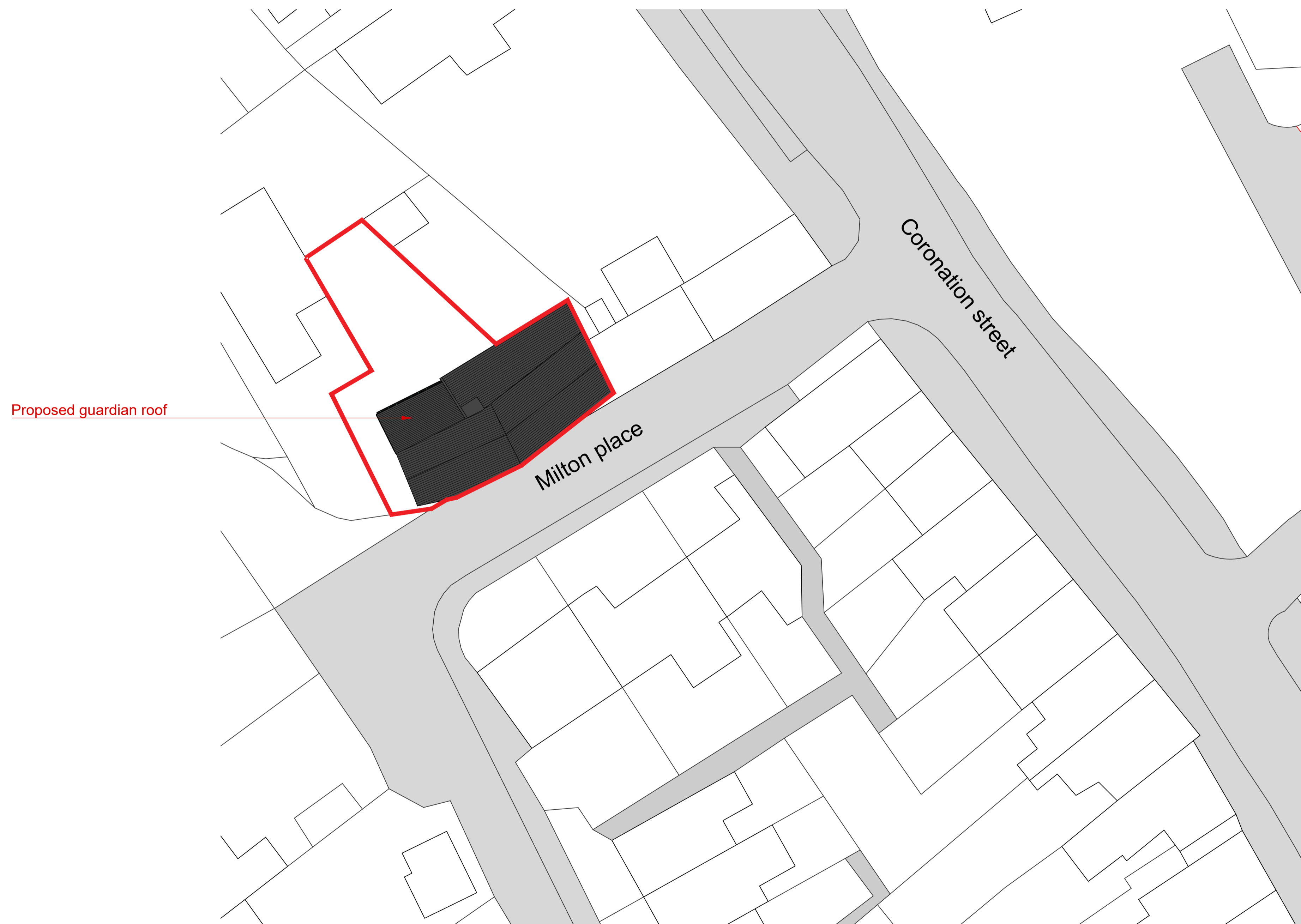

GW Architectural Clavering House, Clavering Place Newcastle upon Tyne NE1 3NG t: 0191 432 4510 e: info@gwarchitectural.co.uk				
PROJECT Christmas cottage 3 Milton Place, Fairwood				
DRAWING TITLE Proposed site plan				
Scale 1:200 @A1	Drawn By CK	Date Drawn 28/11/23	Checked By GW	Date Checked 28/11/23
Drawing No. 23046.F08				Revision *
Drawing Status FEASIBILITY				