







### Site Layout key

-  Bin storage
-  Single cycles shed
-  Double cycles shed
-  Turfed - New lawn areas
-  450 x 450 PCC Patio slabs
-  Electrical vehicle charging point
-  Air source heat pump

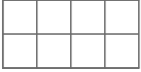

1. This drawing and content is copyright © of coombes : everitt architects limited and should not be copied without their prior written consent.
2. For construction purposes only, do not scale drawing. All dimensions to be checked on site prior to construction and any discrepancies reported to contract administrator.
3. Do not use this drawing for setting out unless drawing specifically indicates setting out points.
4. Engineering information is indicative only and should be taken from structural engineers design.

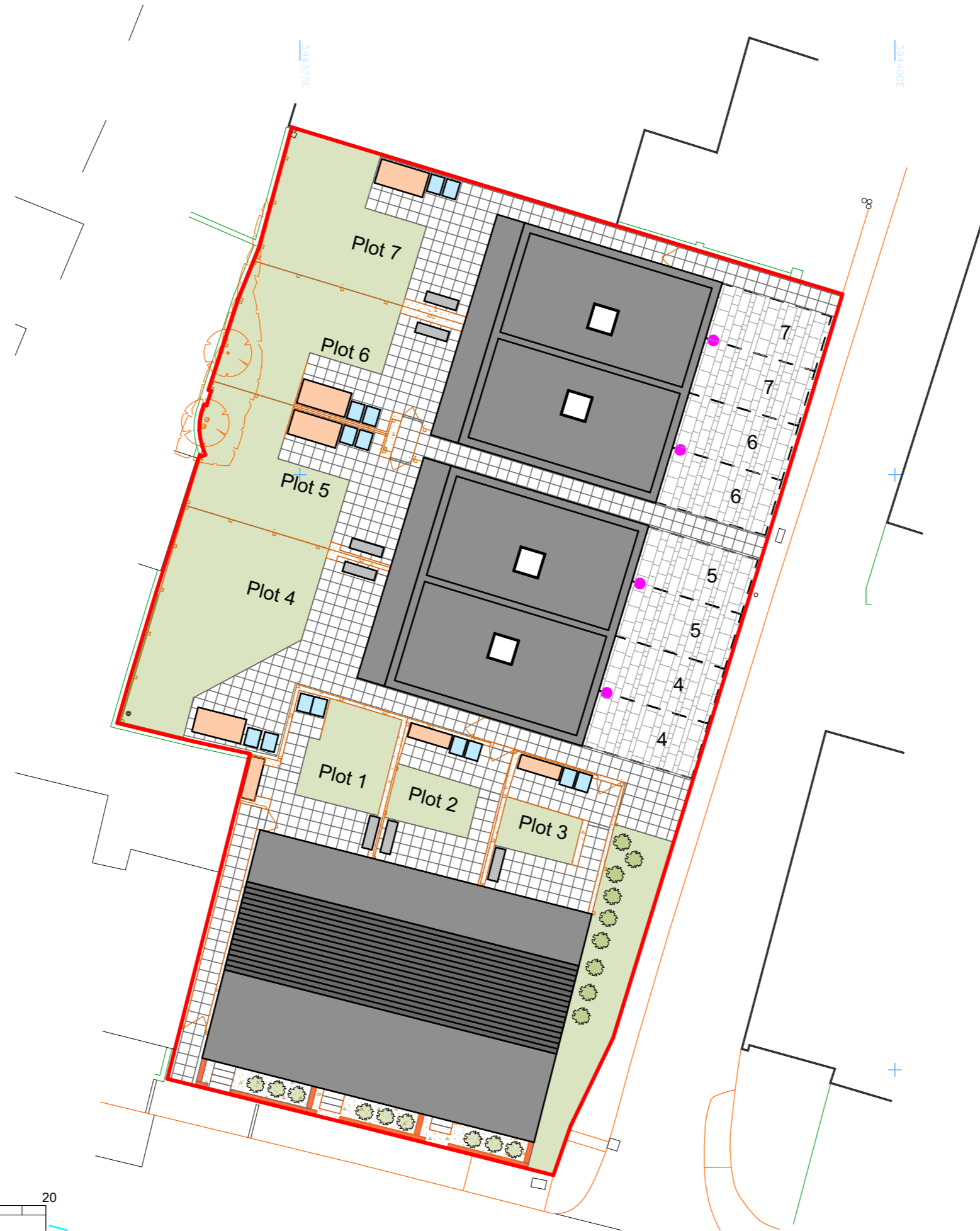
Rev	Initial	Description / Amendment	Date

Drawing title: Site Layout

Project: 7 No. Proposed Dwellings at Former Ski Tyres, Chelt, Glos, GL50 3ND

Scale: 1:200, 1:100 @ A3

Date: Dec 2023

Client: Cape Homes Limited

Drawn by: JG

Drawing No: 23.20.022.PL.150

coombes : everitt architects limited  
 105-107  
 Bath Road  
 Cheltenham  
 Gloucestershire  
 GL53 7LE

t: 01242 807727  
 e: info@ce-architects.co.uk  
 www.ce-architects.co.uk

