

Site Location Plan

Scale: 1/1250

© Crown Copyright
All rights reserved
Licence No: AL 100025996

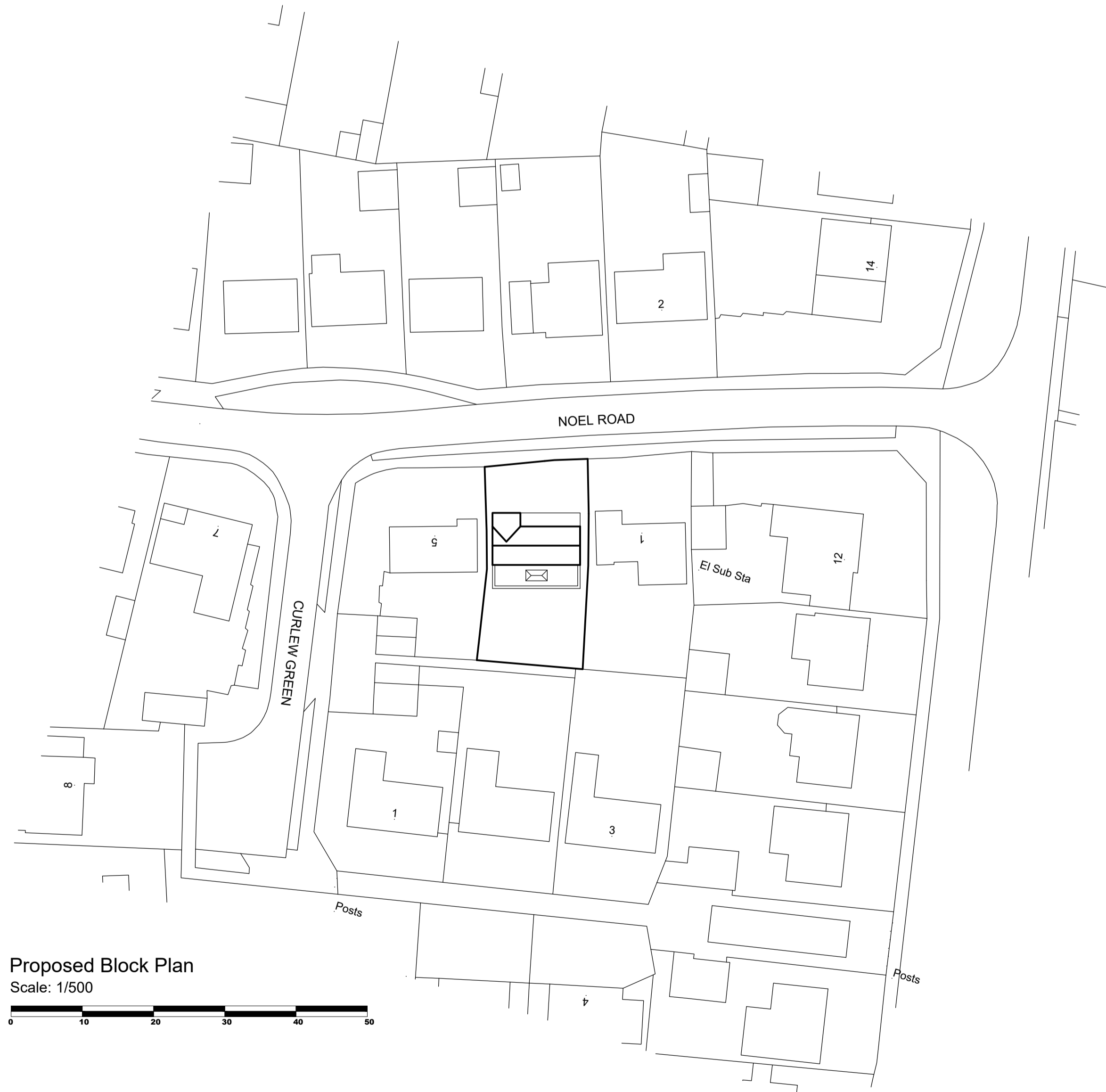
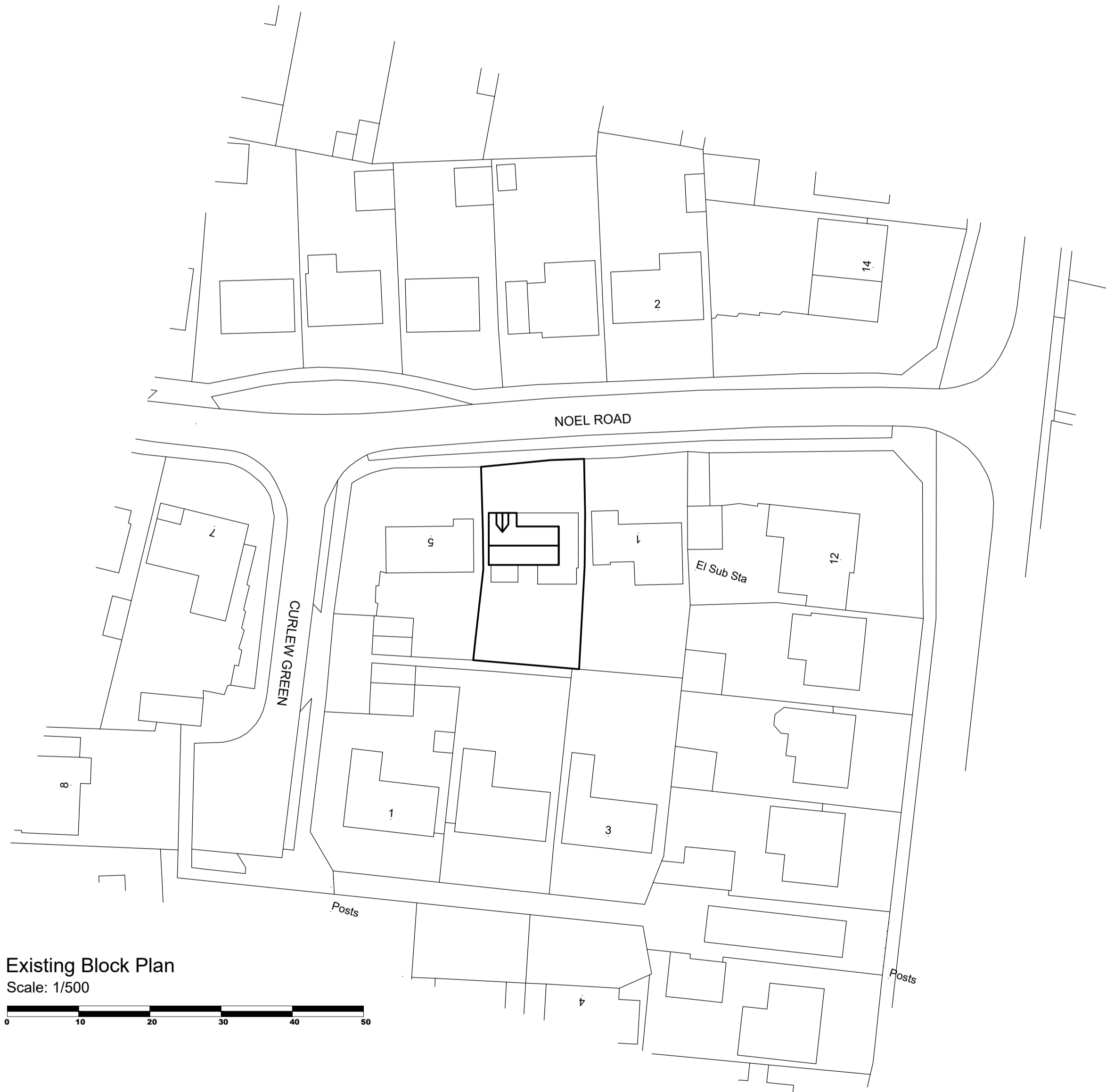
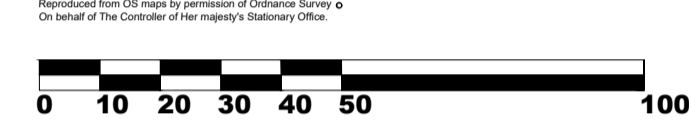

Notes:
This drawing and any design shown upon it are the exclusive copyright of Ian Garrett Building Design Limited, UK. No other person may use this design for any purpose, without prior written permission or discharge being received from in a written form from - Ian Garrett Building Design Limited, UK the copyright holder.
This drawing shall not be scaled, check all site dimensions & from fixed positions. Use dimensions on the plans in preference.
This drawing has been prepared for planning or building regulation purposes only, it thus shall not be regarded as a fully working drawing. All dimensions, levels, foundations, ground conditions, drains, heights, DPC & DPM together with complete drawing shall be checked and agreed prior to any manufacture of any component.
All work, workmanship & materials are to comply with the current applicable BS Code of Practice, building regulations.
Check planning conditions that may be relevant to the application. This drawing shall be read in conjunction with the specifications, engineers designs, details that may be applied to assist.
Any changes to the design or specifications, shall need to be agreed with the Local Authority planning & building control departments. Changes could compromise the design requirements.
No alterations to the drawings or specifications shown may be undertaken other than by Ian Garrett Building Design Ltd the copyright holder.

Revisions:

Dated	Description
1	
2	
3	

**3 Noel Road
Lowestoft
Suffolk
NR32 3JS**

**Client:
Ms Wilson & Mr Mummary**

Site Location and Block Plans

Drawing no: 3146.23.4
Date: November 2023
Scale: 1:50, 1:100, 1:500 & 1:1250