

SHORTWOOD ROAD

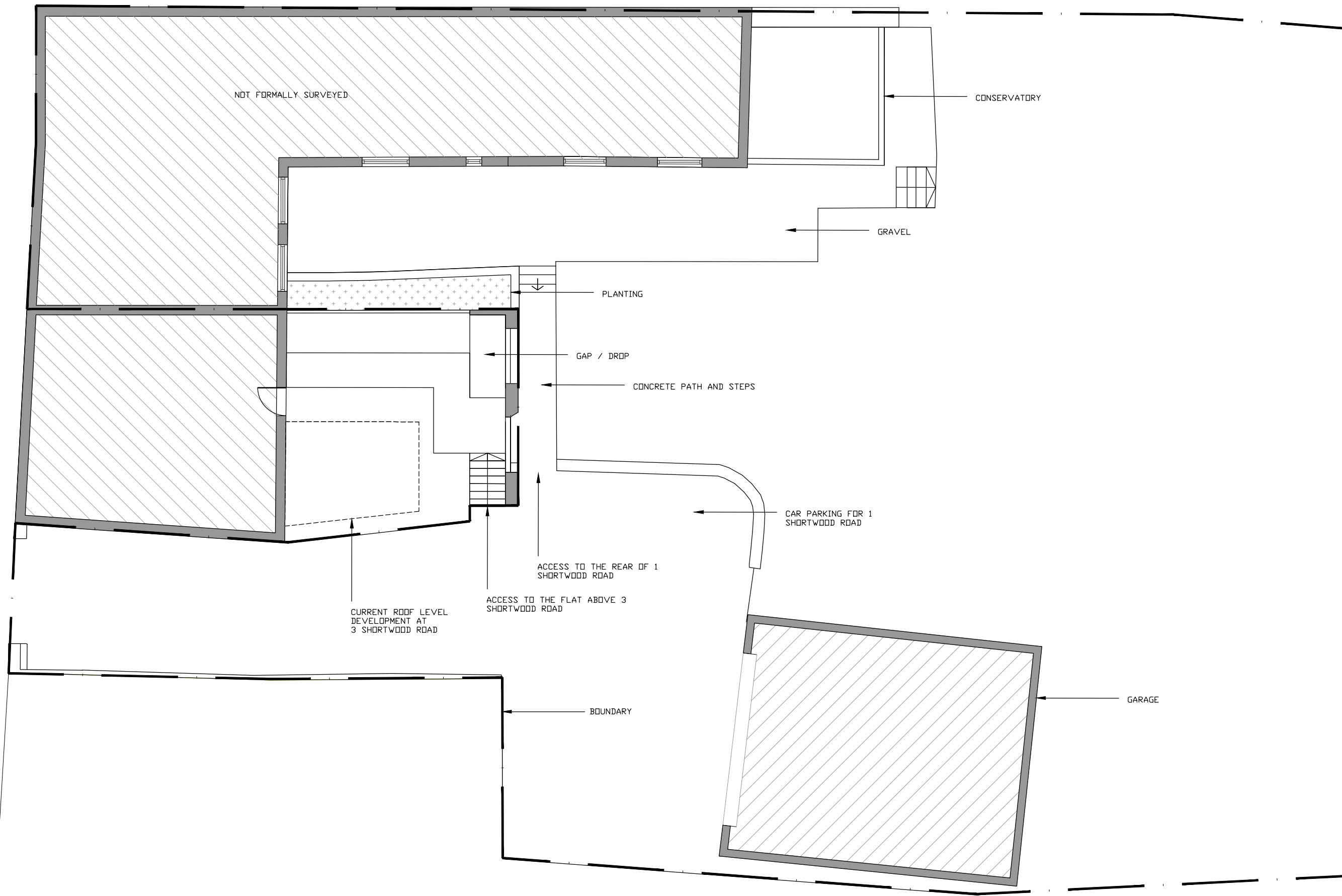

GROUND FLOOR PLAN - EXISTING

SCALE 1:100

PROJECT	1 Shortwood Road, Pucklechurch New Garden Wall		
DRAWING	Ground Floor Plan Existing	DRAWING NO. 020	REV. -
DATE	22.01.24	SCALE 1:50 @ A3	DRAWN EJB CHECKED MC

PLANNING	
NOTE: The level of information in this drawing is issued for PLANNING only. The information shown should not be used for any other purpose (such as building regulations, costing or construction) unless permission is expressly given by client/architect. To be read in conjunction with Civil and Structural and MEP information. Rights for party wall and rights of light lies with the client. A specialist measured survey has not been carried out on the site. All dimensions should be checked on site. Illustrated material subject to copyright	

REVISIONS			
Rev:	Author:	Date:	Description:
-	-	-	-

0 1 5 METRES

KEY
[Symbol] Site Boundary

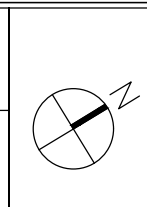

10 - 12 Gloucester Rd,
Third Floor,
Bristol,
BS7 8AE

Tel: 01173 634033
hello@cryerandcoe.co.uk
www.cryerandcoe.co.uk

Cryer&Coe architects