

Location Plan
Scale 1:1250

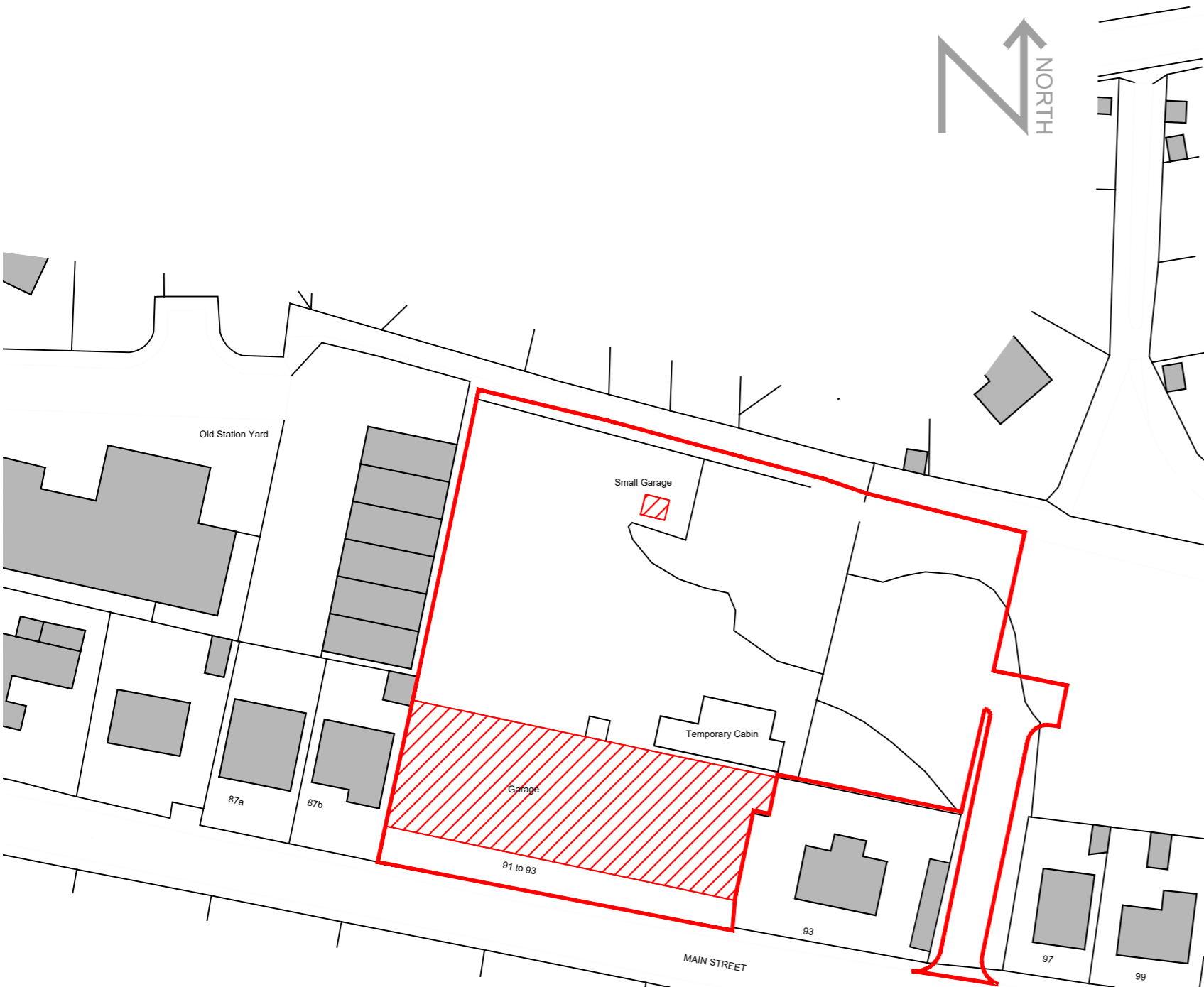

Site Plan
Scale 1:500



OS Map
Scale 1:25,000



General

All works to be carried out in full accordance with the Building Standards 2007 (Scotland) and all latest amendments.
All works are to be carried out in full accordance with the current health & safety standards for demolition works.
All demolition works to be carried out in accordance with the method statement
HSE to be notified when work starts on site.
Works to commence as soon as possible.

Services

All incoming mains services to be temporarily disconnected and 'made safe' by specific qualified bodies if required and in full accordance with their guidelines for the execution of such works
All internal services to be disconnected complete and made safe.
The positions of all services are to be confirmed prior to the commencement of any works.

Drainage

Existing foul drainage to be removed or cut and capped as required.

Site Security

Site to be made safe, as to not allow members of the public to access the site freely during demolition in accordance with regulation 13.
The demolition site is to be fenced off to protect the public from the site unfinished or partially complete works will be kept safe and secure in accordance with regulation 15.
When demolition works are finished the site should be graded + cleared to prevent public access under regulation 10.

Access

The existing site access road is to be retained and used for vehicle and pedestrian access during demolition.
Access of plant, machinery, etc is to be controlled by the site manager / client.

Neighbouring Properties

Any neighbouring properties affected by the demolition work should be protected accordingly and any damage be rectified by the contractor.

Landscaping

Any adjacent landscaping / trees are to be protected during demolition.

Demolition

Take down existing buildings and walling and remove from site all materials and waste.

Contaminated Ground

Should contaminated ground be encountered during demolition the demolition contractor / client should cease work and notify the Scottish Environmental Protection Agency (SEPA) and Aberdeenshire Council environmental health department to discuss remedial works.

Landfill

All demolition material to be disposed of at a registered local land fill site.

Noise Levels

Noise levels during demolition are likely to be normal, expected noise levels, but should be kept to a minimum where possible.

Dust / Debris

Dust and debris levels are to be kept to a minimum at all times during demolition.

| Rev: | Details: | Date: | By: |
|------|-------------------|--------|-----|
| A | Planning Comments | Jan 24 | KH |
| | | | |
| | | | |

Project
Alford Garage Demolition

At: 91-93 Main Street
Alford
Aberdeenshire
AB33 8AD

For: Scott Beattie

Drawing
Site & Location Plan

| | | | |
|----------|---------------|--------|------------|
| Scale | As noted @ A2 | Date | March 2023 |
| Revision | A | Drg No | 2899-002 |

t-01464 841113 | e-office@johnwinkdesign.co.uk
Midtown of Foudland | Glens of Foudland | Huntly | Aberdeenshire | AB54 6AR

Note
Dimensions must not be scaled from this drawing. If in any doubt - ask! All dimensions to be checked prior to work commencing or prior to any components being manufactured.
Any discrepancy to be reported. All work and material to comply fully with all current British Standards Codes of Practice, building regulations, IEE regulations and all HSE acts.

This drawing is copyright of John Wink Design. ©

JOHN WINK DESIGN

CIAT
Registered Practice

CHARTERED PRACTICE