

SCALE IN METERS

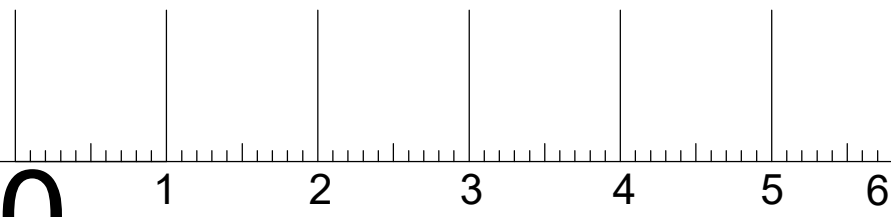

MR AND MRS. LITTLE

PROPOSED INTERNAL ALTERATIONS
 REMOVAL OF EXISTING EXTENSION
 NEW TWO STOREY EXTENSION
 AT 11 ALEXANDER DRIVE
 BRIDGE OF ALLAN

PROPOSED GROUND FLOOR PLAN

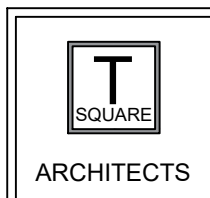

Architecture - Design - Planning

39 Allanvale Road
 Bridge of Allan
 Stirling
 FK9 4PA

Mob: 07596906412

E-mail: claire.gibbons@tsquare-architects.co.uk Web: www.tsquare-architects.co.uk

| | | | |
|-----------------------|------------------|--------------|--------------|
| scale 1:50 | date 22.11.23 | drawn: CG | status: P |
| proj no. 2023-1026 | Dwg no. T-401 | REV | |