

MR AND MRS. LITTLE

PROPOSED INTERNAL ALTERATIONS
REMOVAL OF EXISTING EXTENSION
NEW TWO STOREY EXTENSION
AT 11 ALEXANDER DRIVE
BRIDGE OF ALLAN

ROOF/SITE PLAN

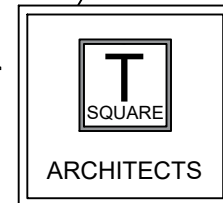

Architecture - Design - Planning

39 Allanvale Road
Bridge of Allan
Stirling
FK9 4PA

Mob: 07596906412

E-mail: claire.gibbons@tsquare-architects.co.uk Web: www.tsquare-architects.co.uk

scale	1:200	date	22.11.23	drawn	CG	status	P
proj no.	2023-1026	Dwg no.	T-701	REV	-		