

Produced on 15 March 2023 from the Ordnance Survey National Geographic Database and incorporating surveyed revision available at this date.  
This map shows the area bounded by 279178 697783, 279320 697783, 279320 697925, 279178 697925, 279178 697783  
Crown copyright and database rights 2023 OS 100054135. Supplied by copla ltd trading as UKPlanningMaps.com a licensed Ordnance Survey partner (OS 100054135).  
Data licence expires 15 March 2024. Unique plan reference: v2c//922458/1244907



MR AND MRS. LITTLE

**PROPOSED INTERNAL ALTERATIONS  
REMOVAL OF EXISTING EXTENSION  
NEW TWO STOREY EXTENSION  
AT 11 ALEXANDER DRIVE  
BRIDGE OF ALLAN**

LOCATION PLAN

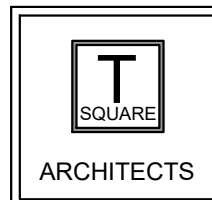

Architecture - Design - Planning

39 Allanvale Road  
Bridge of Allan  
Stirling  
FK9 4PA

Mob: 07596906412

E-mail: daire.gibbons@tsquare-architects.co.uk Web: www.tsquare-architects.co.uk

scale 1:1250	date 22.11.23	drawn: CG	status: P
proj no. 2023-1026	Dwg no. T-101	REV -	