

VOLUME CALCULATION

Rear Dormer

$V_1 = 1.5m^2 \times 6.64m = 9.96m^3$

$V_2 = 3.0m^2 \times 5.20m = 15.60m^3$

$V_3 = 6.2m^2 \times 3.78m = 23.45m^3$

$V_T = V_1 + V_2 + V_3 = 9.96 + 15.60 + 23.45 = 49.01m^3$

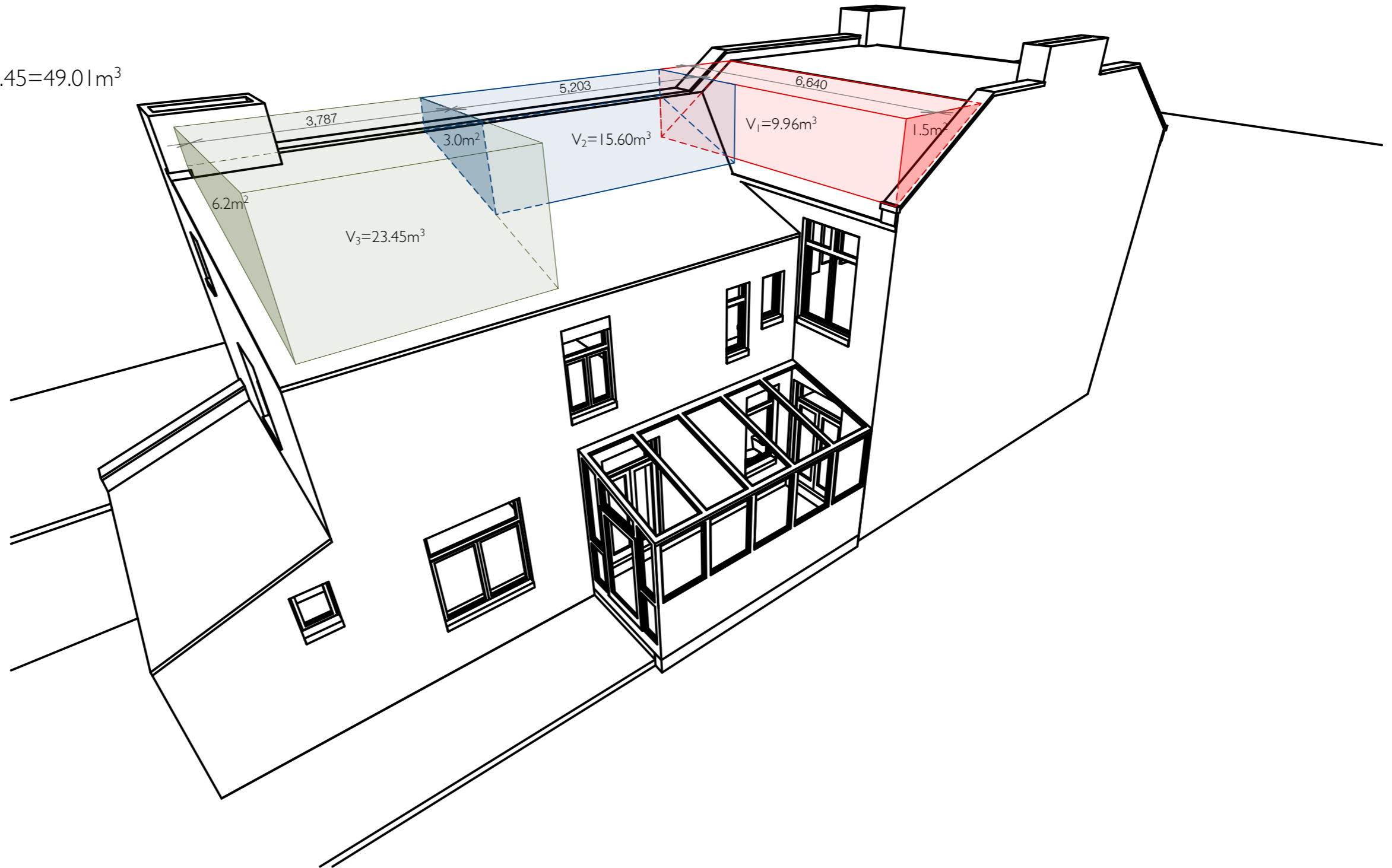

PLANNING

© Eyal Moran Architects LTD. Do not reproduce the drawing without written permission.

© Eyal Moran Architects LTD. Do not reproduce the drawing without written permission.

REV	DATE	DESCRIPTION	BY
PI	21/12/2023	Issued for planning	MN

AS ARCHITECTS
AT STUDIO

Concorde House
Grenville Place
London NW7 3SA

+44 (0)20 3621 8013
studio@emarchitects.co.uk
www.emarchitects.co.uk

PROJECT	88 Hendon Lane London N3 3SL		
CLIENT	...		
SCALE	DATE	DRAWN BY	APPROVED BY
NTS @ A3	21/12/2023	MN	EM

DRAWING	Dormer Volume Calculation	
Purpose:	...	
PROJECT NO / DRAWING NO	32207/P017	REVISION
		PI