

PROPOSED LODGE: 2 BED

BROOK LODGE, TROUGH ROAD, SCORTON, PR3 1DH

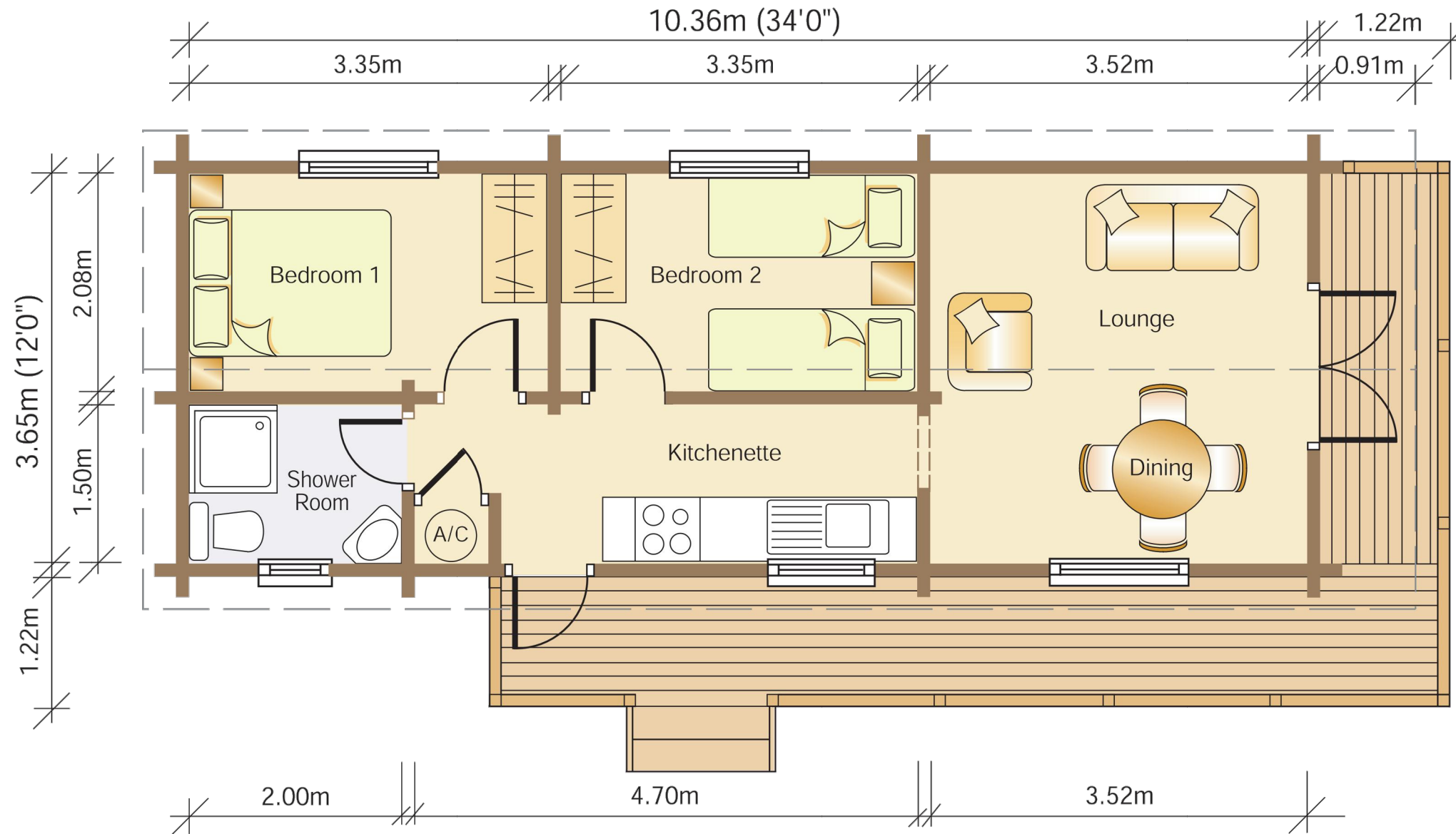

GA ASSOCIATES
planning • architecture • design

2 CROSTON VILLA
HIGH STREET
GARSTANG
PRESTON
PR3 1EA

T: 01995 604514
E: Info@GrahamAnthonyAssociates.com
W: www.GrahamAnthonyAssociates.com

CLIENT: MR HINDE
DWG STATUS: PLANNING PURPOSES ONLY

DRAWING TITLE / PROJECT: **PROPOSED LODGE: 2 BED**
BROOK LODGE, TROUGH ROAD, SCORTON, PR3 1DH

DRAWING No: GA3175-2BED-01
SCALE: 1:50 (A3)
DATE: JUL '18

ALL DIMENSIONS TO BE CHECKED ON SITE AND ANY DISCREPANCIES TO BE REPORTED TO GRAHAM ANTHONY ASSOCIATES PRIOR TO PROCEEDING WITH ANY WORKS. DO NOT SCALE OFF DRAWING AND REFER TO WRITTEN DIMENSIONS. THIS DRAWING IS SUBJECT TO COPYRIGHT ©