

General Notes:

1. Dimensions should not be scaled from the drawings where accuracy is essential.
2. Details dimensions and levels to be checked on site by builder prior to commencement of works. Any works commenced prior to all necessary local authority approvals are entirely at the risk of the owner & builder.
3. Structural details are subject to exposure of existing construction and verification by L.A Surveyor and any necessary revised details are to be agreed with the L.A Surveyor prior to carrying out the affected works.
4. All materials are to be used in accordance with the manufacturers' guidelines and all relevant British Standards Codes of Practice & Regulation 7 of Building Regs.
5. All works are to be carried out in accordance with Local Authority requirements.
6. The intended works fall within the Party Wall Act 1996 and any adjoining owners affected must be notified prior to commencement of any works.
7. Thames Water Authority permission to be obtained if building over or adjacent to sewers within 3 metres. (Tel: 08459 200 800)
8. No part of the extension to project into adjoining boundary lines.

When printing off PDF drawings, it is the responsibility of the user to verify that the resulting prints are to scale on the appropriate sized sheet. Also the scale bar on the plan measure correctly.



Client: Mr Sujit Patel

**Site Address:
14 Civic Square
Tilbury, Essex
RM18 8AD**

**Project:
New Offices/Surgery In The Rear Building.**

Title: Site Location And Block Plans

Architect: Gaetano Paternostro

Drawing No.: TPLA0065PP/01

Scale: 1:1250; 1:200 & A3

Date: 18 December 2023

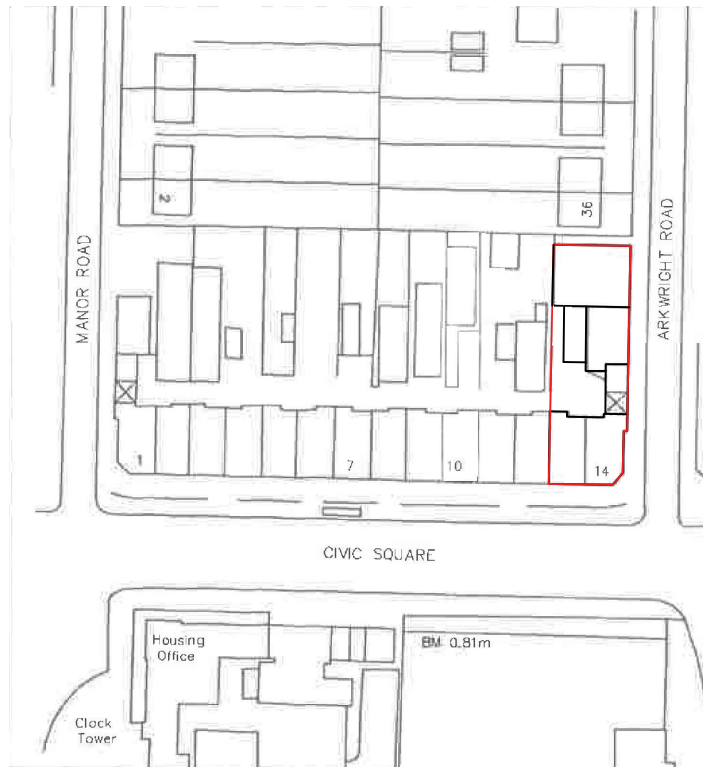

**Site Location Plan
Scale 1:1250**

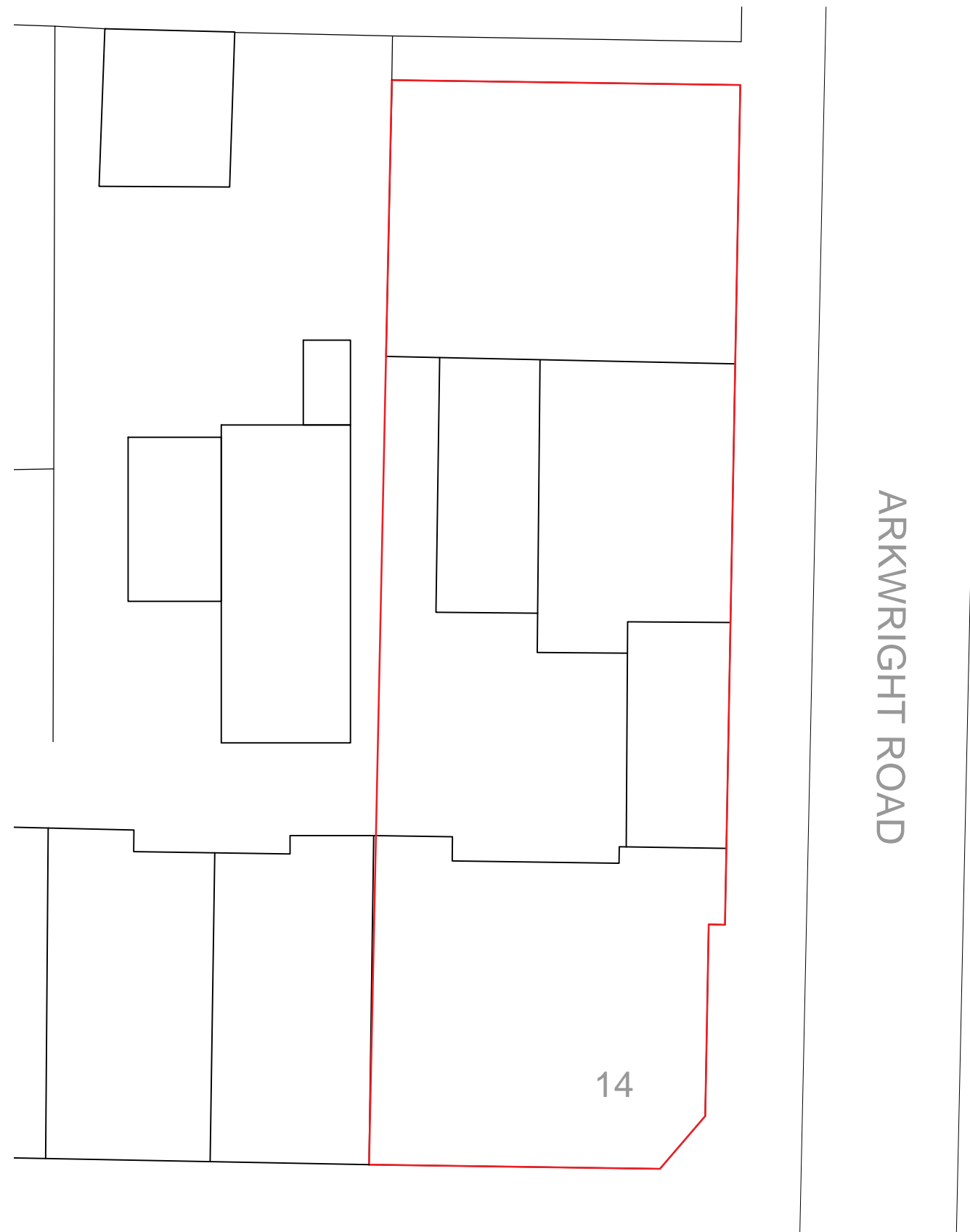

ARKWRIGHT ROAD

14

**Block Plan
Scale 1:200**

