

**SPECIFICATION FOR LANDSCAPE WORKS**

**PLANT STOCK**  
All stock to be in accordance with the relevant British Standard 3926 part 2.

**Handling and Planting:** Plant material to be handled, supplied, and planted in accordance with the committee on Plant Supply and Establishment publications. In all cases the plant material should comply with the relevant British Standard.

**Species:** Plants to be supplied exactly true to name.

**Delivery of plants:** Ensure that adequate protection is given to all plants and their root system to preclude failure due to lack of moisture or exposure due to transportation to site, and between delivery and planting.

**PREPARATION**  
Emag granular fertilizer to be incorporated into the topsoil in accordance with manufacturers recommendations.

**TREE PLANTING**  
Tree pits: Excavate in positions shown on the drawing a pit measuring 900mm diam x 600mm deep, the base of the pit to be broken up to a depth of 150mm.

**Backfill:** To comprise approved topsoil and 20l tree and shrub planting compost evenly mixed and well firmed around the root area.

**Staking:** Trees should be secured by means of single stake and rubber belt or double stake with crossbar tied below the crown.

**Even, vigorous growth.**  
Pruning: Following planting the crown of each tree to be lightly pruned to remove any damaged twigs and buds and to promote

**SHRUB PLANTING**  
Set out: Evenly within the planted areas in accordance with the drawing and schedule giving due consideration to future growth.

**Planting:** Should be in a pit that comfortably accommodates the container. Each plant to be placed in an upright balanced stance and backfill returned. Well heal in to ensure no air pockets are left and leave plants firm.

**Pruning:** Lightly prune if necessary to encourage bushy growth and establishment.

**WATERING**  
Ensure all trees and shrubs are watered to field capacity following planting.

**MULCH**  
Place a 60mm layer of amenity grade bark mulch to all planted areas and tree bases.

**Local climate and soil types will vary the requirement.**  
For guidance, during the first growing season newly planted trees shall be irrigated following any four-week period without appreciable rainfall.

**For reasonable growth irrigation shall be applied at fortnightly intervals to moisten the soil so that the full rooting depth of the soil is saturated.** The amount of water required will vary considerably according to the texture and structure of the soil but as a guide a heavy standard tree will require at least 20 litres and a small transplant approx. 10 litres for each watering. Soils with a low water holding capacity will only need smaller amounts of water but with more frequent application.

**Water must always be applied so that the soil is moistened to the depth of the root zone.**

**Ensure a minimum of one meter diameter weed-free area is maintained around each tree base by herbicide application or mulching.**

**Mechanical trimmers and mowers must not be used near the base of the trees as they can seriously damage the bark.**

**(National Plant Specification-Handling and Establishment, Nov 1995)**

**Weeds competing for moisture and nutrients shall be eliminated until the plants are well established, for at least two years.**

**Ensure a minimum of one meter diameter weed-free area is maintained around each tree base by herbicide application or mulching.**

**(National Plant Specification-Handling and Establishment, Nov 1995)**

**Weed control during the establishment phase**

**WATERING**  
Provide moisture during the establishment phase

**Local climate and soil types will vary the requirement.**

**For guidance, during the first growing season newly planted trees shall be irrigated following any four-week period without appreciable rainfall.**

**For reasonable growth irrigation shall be applied at fortnightly intervals to moisten the soil so that the full rooting depth of the soil is saturated.** The amount of water required will vary considerably according to the texture and structure of the soil but as a guide a heavy standard tree will require at least 20 litres and a small transplant approx. 10 litres for each watering. Soils with a low water holding capacity will only need smaller amounts of water but with more frequent application.

**Water must always be applied so that the soil is moistened to the depth of the root zone.**

**Ensure a minimum of one meter diameter weed-free area is maintained around each tree base by herbicide application or mulching.**

**Mechanical trimmers and mowers must not be used near the base of the trees as they can seriously damage the bark.**

**(National Plant Specification-Handling and Establishment, Nov 1995)**

**Weeds competing for moisture and nutrients shall be eliminated until the plants are well established, for at least two years.**

**Ensure a minimum of one meter diameter weed-free area is maintained around each tree base by herbicide application or mulching.**

**(National Plant Specification-Handling and Establishment, Nov 1995)**

**Weed control during the establishment phase**

**WATERING**  
Provide moisture during the establishment phase

**Local climate and soil types will vary the requirement.**

**For guidance, during the first growing season newly planted trees shall be irrigated following any four-week period without appreciable rainfall.**

**For reasonable growth irrigation shall be applied at fortnightly intervals to moisten the soil so that the full rooting depth of the soil is saturated.** The amount of water required will vary considerably according to the texture and structure of the soil but as a guide a heavy standard tree will require at least 20 litres and a small transplant approx. 10 litres for each watering. Soils with a low water holding capacity will only need smaller amounts of water but with more frequent application.

**Water must always be applied so that the soil is moistened to the depth of the root zone.**

**Ensure a minimum of one meter diameter weed-free area is maintained around each tree base by herbicide application or mulching.**

**Mechanical trimmers and mowers must not be used near the base of the trees as they can seriously damage the bark.**

**(National Plant Specification-Handling and Establishment, Nov 1995)**

**Weeds competing for moisture and nutrients shall be eliminated until the plants are well established, for at least two years.**

**Ensure a minimum of one meter diameter weed-free area is maintained around each tree base by herbicide application or mulching.**

**(National Plant Specification-Handling and Establishment, Nov 1995)**

**Weed control during the establishment phase**

**WATERING**  
Provide moisture during the establishment phase

**Local climate and soil types will vary the requirement.**

**For guidance, during the first growing season newly planted trees shall be irrigated following any four-week period without appreciable rainfall.**

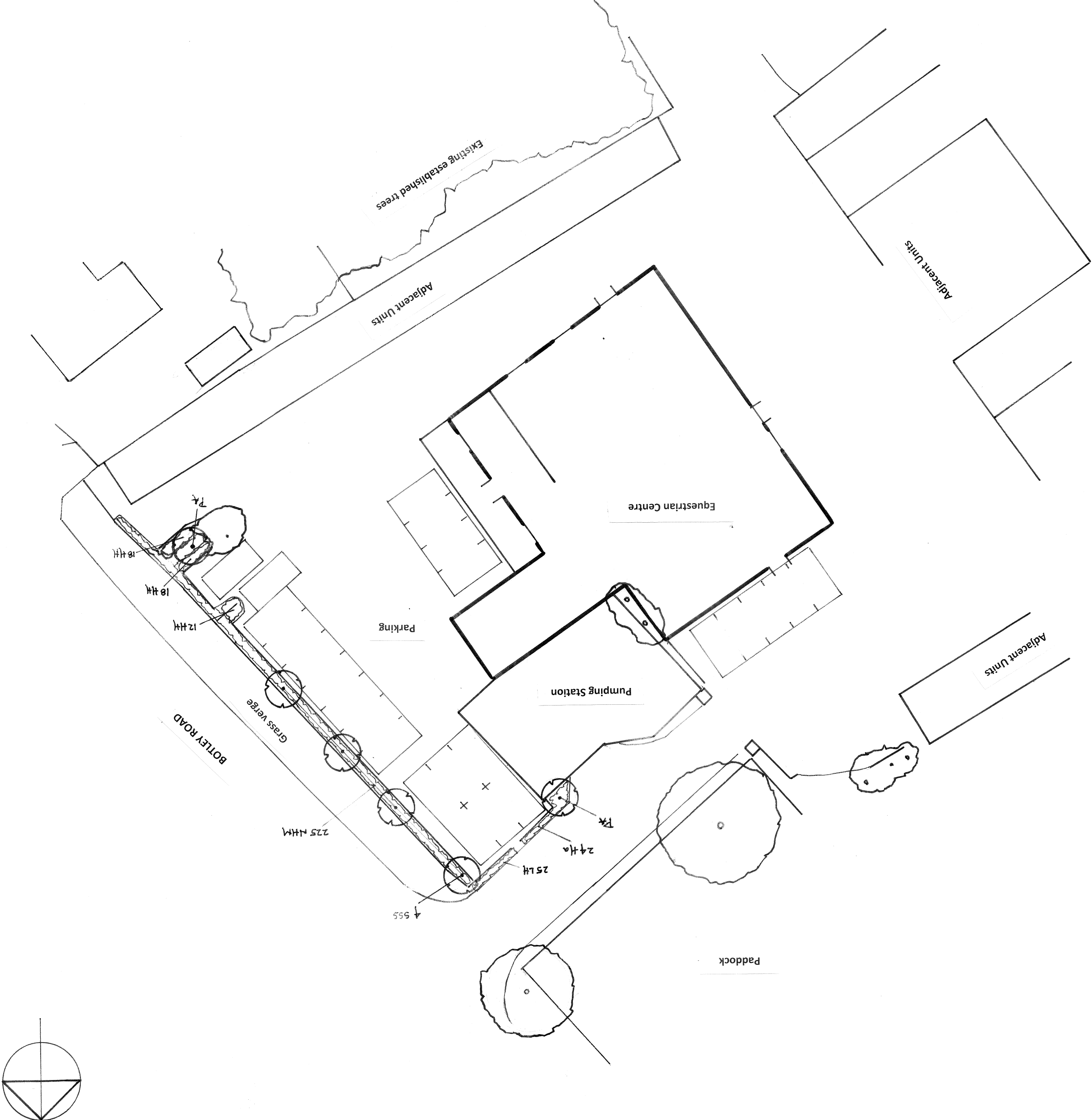

**NOTES**  
Landscaping to be implemented in accordance with building programme, or during the first planting season following building works.  
Planting and landscaping to be maintained by property owners or appointed management company. Landscaping to be maintained for a period of five years and any part of the approved planting scheme that fails to establish within the first five years shall be replaced by another of the same species and size in the same position during the first available planting season.

**MICHAEL NICHOLAS**

**E-MAIL** mikenicholas@utilitywarehouse.org.uk  
**TEL** 07801277249

**PROJECT** Shedfield Equestrian Centre.  
**CLIENT** Shedfield Equestrian.

**DRAWING** Landscape Proposals  
**SCALE** 1:250

**DATE** January 2023  
**DWG No** MPN SEQC

**PLANTING SCHEDULE**

TRACES	2 No PA	10-12cm	3.0-3.50m hgt
4 No SSS	Sorbus "Sheerwater Seedling"	10-12cm	3.0-3.50m hgt
<b>NATIVE HEDGE MIX (NHM)</b>			
225 No supplied 60-90cm planted in random species mix of 7-11 set out in a double staggered row at 5/1in m.			
30 No Cornus sanguinea			
50 No Acer campestre			
65 No Crataegus monogyna			
50 No Ilex aquifolium			
30 No Prunus spinosa			
<b>SHRUBS</b>			
24 No Ha	Hypericum androsaemum	20-30cm	3/m2
25 No LH	Lavandula "Hidcote"	15-20cm	5/m2
48 No HH	Hedera "Hibernica"	20-30cm	6/m2