

Existing Block Plan

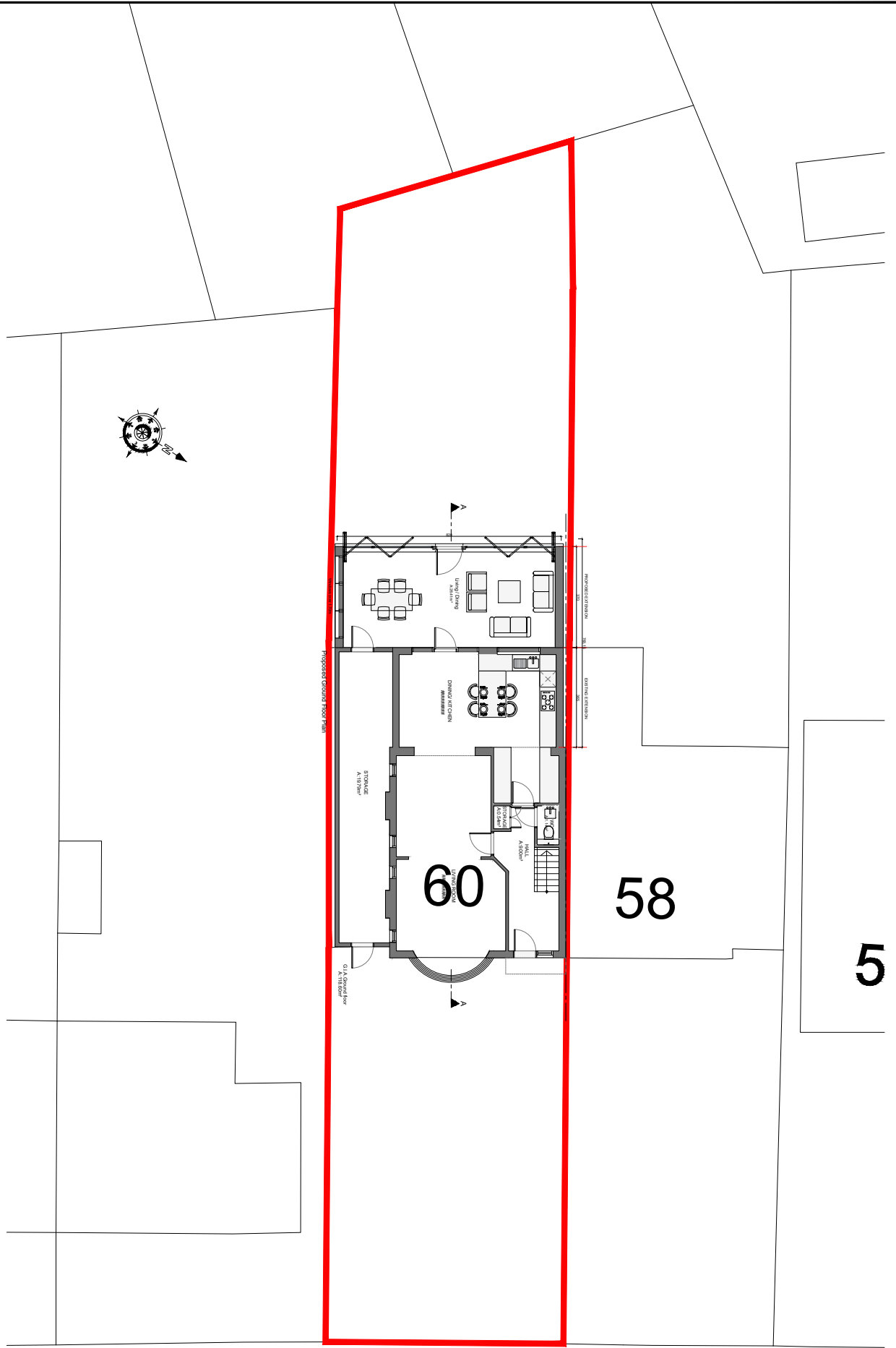

Proposed Block Plan

copyright:
The design and drawings remain the property of Anna-Maria Tsamasfyra Architects. The client for this project will be licensed to use this design and documents on this site only upon full payment of architectural fees. This license is non-transferable. The design and drawings shall not be reproduced, up-loaded to the internet or traced without the permission of Anna-Maria Tsamasfyra Architects.

dimensions:
This drawing has been prepared from a survey drawing that was based on rough survey measurements that were taken for OUTLINE DESIGN PURPOSES ONLY, which is NOT likely to be as precise as a full measured survey. As a result, no warranty as to be precision of the dimensions indicated or illustrated can be given. While this drawing can be used as a base drawing for construction and quotation purposes, due to the nature of the measurements on which it is based, it is VERY IMPORTANT that all dimensions are checked carefully before any work commences or any materials are ordered. If any discrepancies are noticed between this drawing and any other contact document then please contact Anna-Maria Tsamasfyra Architects immediately.

revision notes:

rev:	by:	chkd:	appd:	ai no:	date:	revision:
/	AMT	AMT	/	n/a	19/06/2023	first issue drawing using survey data as per dimension note
A
B
C
D
E
F
G
H
I
J
K
L

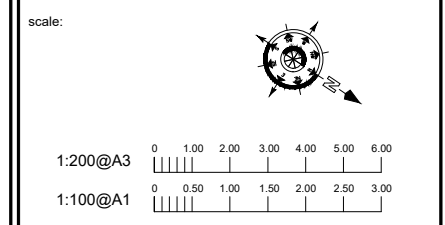

project name:
**60 Church Hill Road,
East Barnet**

post code:
EN4 8UZ

issue:
Planning

date: **Jun 2023** drawn by: **AMT** chkd: **AMT**

drawing note:
Not for construction

drawing name:
**Existing and Proposed
Block Plans**

project number: **A230601** dwg no: **PL00** revision: **-**

M: +447925690969
E: annamt88@gmail.com

Anna-Maria Tsamasfyra
Architect DipArc, MA

ARB, RIBA Chartered Architect