

Legend

Proposed Soft Landscape

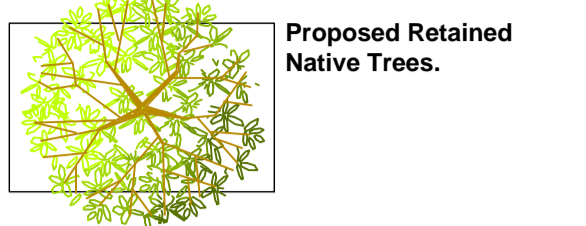

Proposed Retained Native Trees.



Proposed Native Tree Planting.

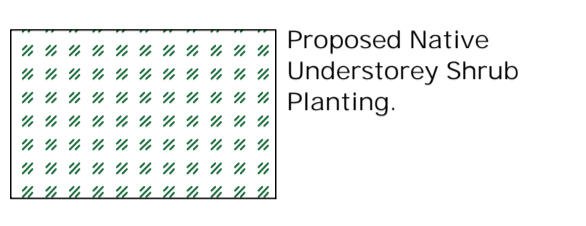

Proposed Native Understorey Shrub Planting.



Proposed Native Mixed Species Hedgerow Planting.



Proposed Native Species Wildflower Planting.
Emorsgate EH1F - Wild Flowers for Hedgerows (or equal and approved)

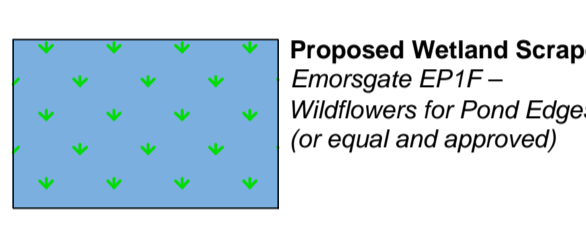

Proposed Wetland Scrape.
Emorsgate EP1F - Wildflowers for Pond Edges (or equal and approved)

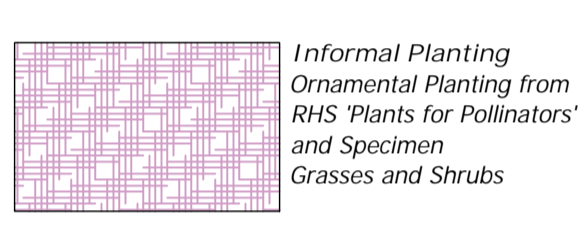

Informal Planting
Ornamental Planting from RHS 'Plants for Pollinators' and Specimen Grasses and Shrubs

Proposed Native Understorey Shrub Planting.
Ecological habitat and screening from the proposals.
Bareroot Whips, 60-90cm, or 3l pot grown, 3/sqm.
Corylus avellana
Crataegus monogyna
Sambucus nigra
Frangula alnus
Viburnum opulus
Cornus sanguinea
Euonymus europaeus

Base of shrubs seeded with Emorsgate EH1F - Wild Flowers for Hedgerows (or equal and approved)

Proposed Native Mixed Species Hedge Planting.
To surround the site and provide connectivity.
Bareroot Whips, 60-90cm
Planted in double staggered row, 400mm apart.
Whips planted at 400mm centres.

At least 5no. of:
Corylus avellana
Crataegus monogyna
Rosa canina
Sambucus nigra
Frangula alnus
Viburnum opulus
Cornus sanguinea
Euonymus europaeus

Base of shrubs seeded with Emorsgate EH1F - Wild Flowers for Hedgerows (or equal and approved)

Informal Planting
Ornamental Planting from RHS 'Plants for Pollinators' and Specimen Grasses and Shrubs

Proposed Retention of Native Trees.

Proposed Native Understorey Shrub Planting.
Ecological habitat and screening from the proposals.
Bareroot Whips, 60-90cm, or 3l pot grown, 3/sqm.
Corylus avellana
Crataegus monogyna
Sambucus nigra
Frangula alnus
Viburnum opulus
Cornus sanguinea
Euonymus europaeus

Base of shrubs seeded with Emorsgate EH1F - Wild Flowers for Hedgerows (or equal and approved)

Proposed New Native Trees.
Alnus glutinosa
Betula pendula
Malus sylvestris

Proposed Shady Wildflower
Shade and Damp-tolerant Species
Seeded with Emorsgate EH1F - Wild Flowers for Hedgerows (or equal and approved)

Proposed Wetland Scrape
Shallow (c.60cm) Shelving Scrape.
Seeded with Inundation-tolerant Species
Seeded with Emorsgate EP1F - Wildflowers for Pond Edges (or equal and approved)

Make use of presence of overhead cables here (and necessity to keep vegetation low) to allow light into scrape at this end.

Informal Planting
Ornamental Planting from RHS 'Plants for Pollinators' and Specimen Grasses and Shrubs

Informal Planting
Ornamental Planting from RHS 'Plants for Pollinators' and Specimen Grasses and Shrubs

Proposed Native Mixed Species Hedge Planting.
To surround the site and provide connectivity.
Bareroot Whips, 60-90cm
Planted in double staggered row, 400mm apart.
Whips planted at 400mm centres.

At least 5no. of:
Corylus avellana
Crataegus monogyna
Rosa canina
Sambucus nigra
Frangula alnus
Viburnum opulus
Cornus sanguinea
Euonymus europaeus

Base of shrubs seeded with Emorsgate EH1F - Wild Flowers for Hedgerows (or equal and approved)

Informal Planting
Ornamental Planting from RHS 'Plants for Pollinators' and Specimen Grasses and Shrubs

Proposed Retention of Native Trees.

Proposed Native Understorey Shrub Planting.
Ecological habitat and screening from the proposals.
Bareroot Whips, 60-90cm, or 3l pot grown, 3/sqm.
Corylus avellana
Crataegus monogyna
Sambucus nigra
Frangula alnus
Viburnum opulus
Cornus sanguinea
Euonymus europaeus

Base of shrubs seeded with Emorsgate EH1F - Wild Flowers for Hedgerows (or equal and approved)

Proposed Native Understorey Shrub Planting.
Ecological habitat and screening from the proposals.
Bareroot Whips, 60-90cm, or 3l pot grown, 3/sqm.
Corylus avellana
Crataegus monogyna
Sambucus nigra
Frangula alnus
Viburnum opulus
Cornus sanguinea
Euonymus europaeus

Base of shrubs seeded with Emorsgate EH1F - Wild Flowers for Hedgerows (or equal and approved)

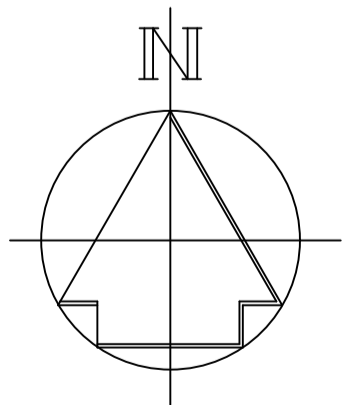

0 5 10m

Scale: 1:200@A1

Challens

Landscape Masterplan
Land South of 63 Street End Lane
GS240.StreetEndLane.LMP
Version: 7
Date: 05.01.24