

The drawing is copyright of SIXTHART LTD. This drawing shall not be scaled. All dimensions are in mm unless otherwise stated. All dimensions shall be checked on site prior to commencing the works and any discrepancies to be reported to SIXTHART LTD. All works shall conform to the current edition of the building regulations and other statutory requirements. All materials and workmanship shall conform with the relevant British Standard specifications and codes of practice. If this drawing forms part of an application for planning permission, it shall not be used for any other purpose without the express permission of SIXTHART LTD. This drawing may incorporate information from other professionals. SIXTHART LTD cannot accept responsibility for the integrity and accuracy of such information. Any clarification and/or additions that are required appertaining to such information should be sought from the relevant profession or their appointment representative.

Drawings, specifications and schedules are to be read in conjunction with the following where applicable: Employer's Requirements documents, Agreements to Lease, Structural Engineer's drawings and specifications, Civil Engineer's drawings and specifications, Survey Drawings, Party Wall/Boundary Awards, Other specialist design consultant's requirements as appointed by the Main Contractor. Other specialist design sub-contractor's requirements as appointed by the Main Contractor.

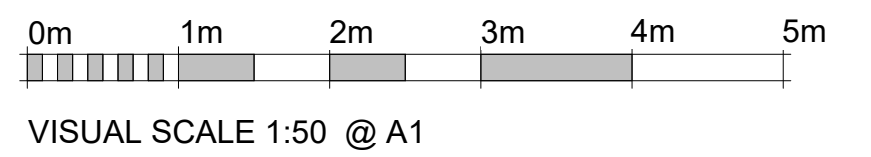
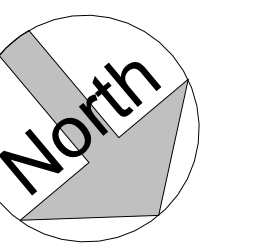
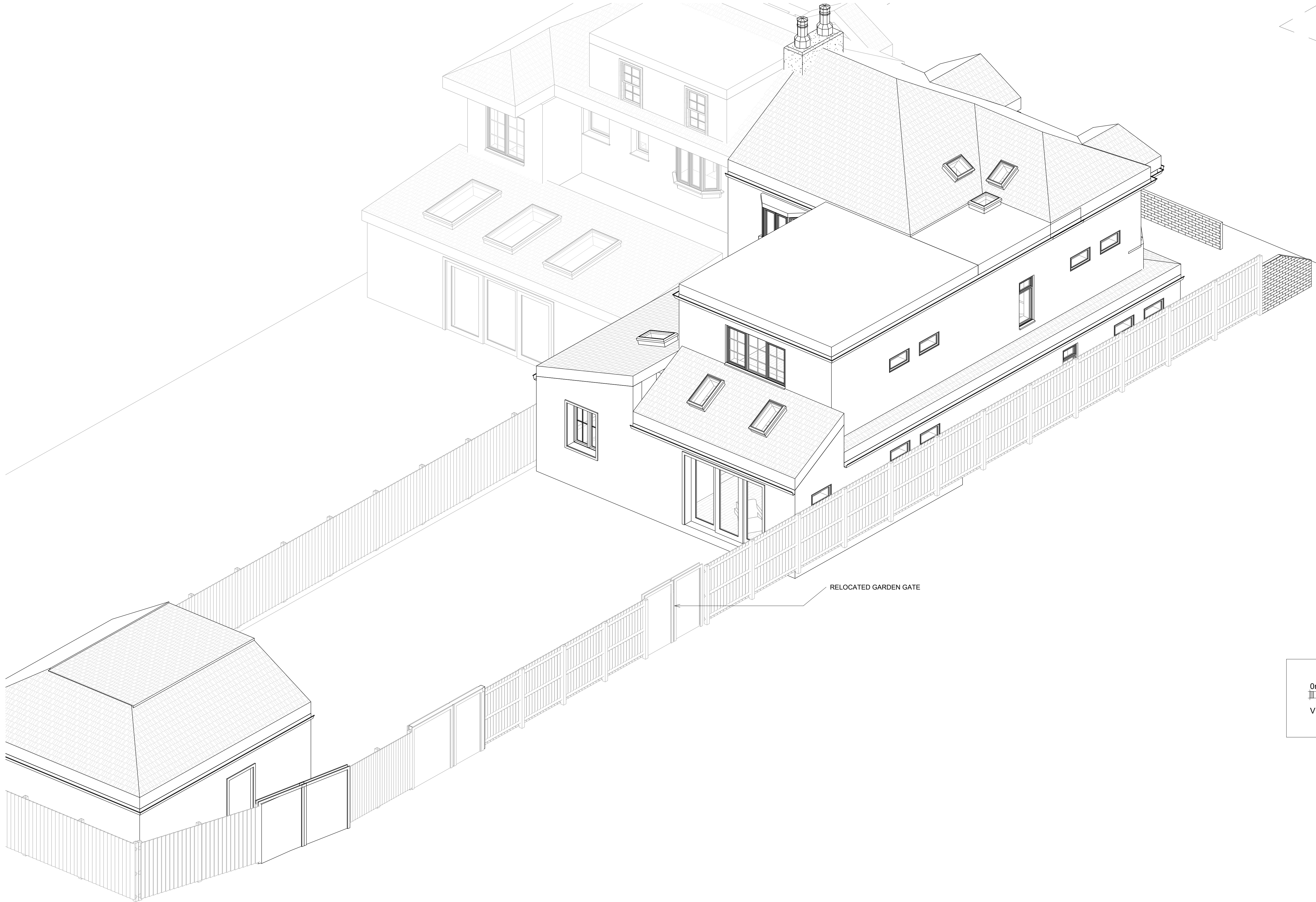

125 CARDINAL AVENUE KT2 5RZ

REAR EXTENSION		
Royal Borough of Kingston upon Thames		
TITLE		
PROPOSAL PERSPECTIVE 1		
DATE	PROJECT	PROJECT NUMBER
Issue Date		200057
STAGE	REVISION	DRAWING NO
_PP		125/PP/405/20122023
SCALE		

1 Perspective 1