

**KEY**

- Tree Crown Spread
- Root Protection Area (RPA)
- Tree Stem
- T1 Tree No.
- Tree Condition Category**
- A
- B
- C
- U

The surveyed trees are illustrated on this Constraints Plan which is prepared in accordance with British Standard BS5837: 2012 'Trees in Relation to Design, Demolition and Construction - Recommendations'

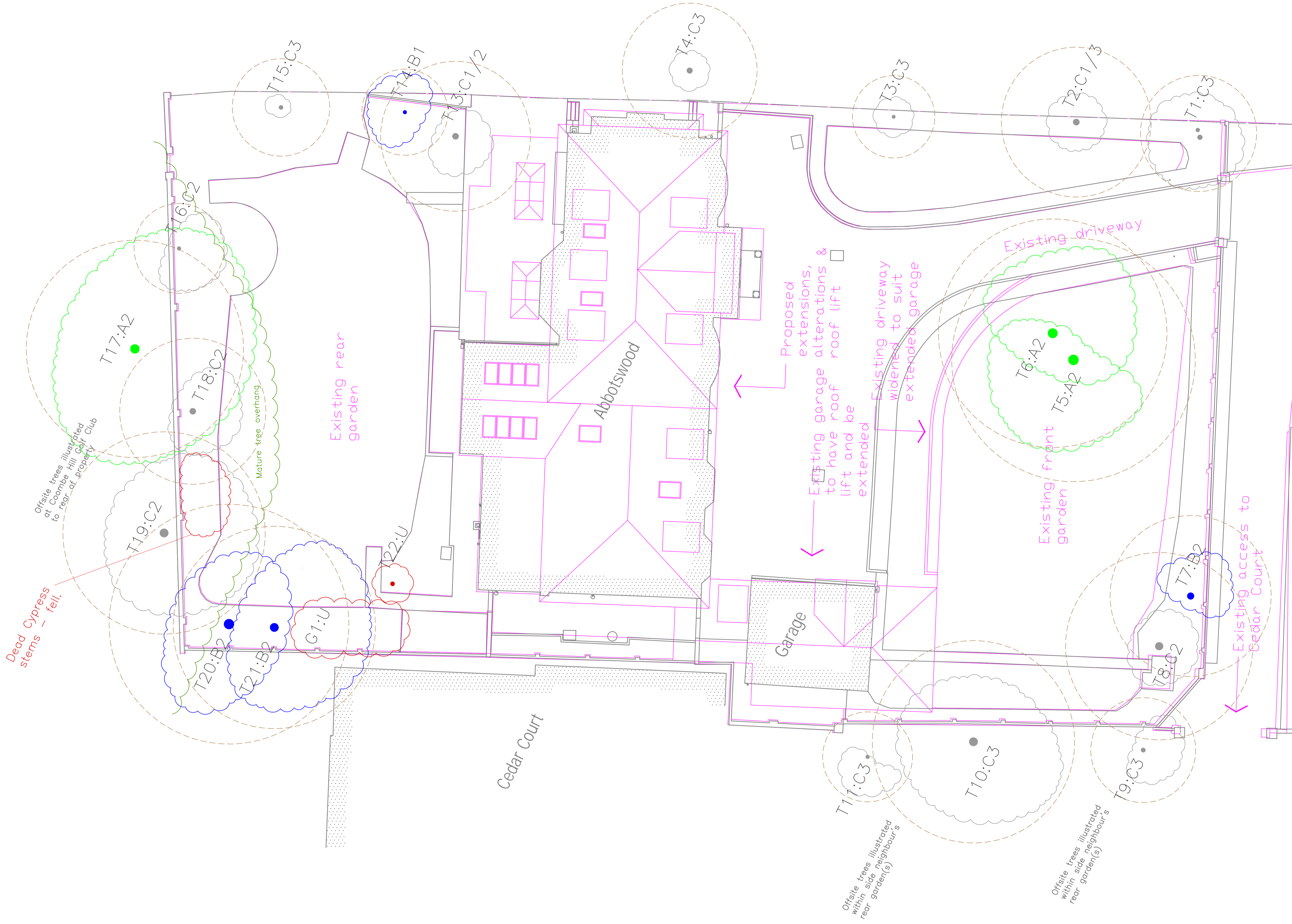

Dead Cypress stems - fell.

Offsite trees illustrated at Coombe Hill Golf Club to rear of property

Mature tree overhang

Existing rear garden

Cedar Court

Abbotswood

Garage

Existing driveway

Existing front garden

Existing access to Cedar Court

Proposed extensions, alterations, & roof lift  
Existing garage to have roof lift and be extended  
Existing driveway widened to suit extended garage

Offsite trees illustrated within side rear garden(s)

Offsite trees illustrated within side rear garden(s)

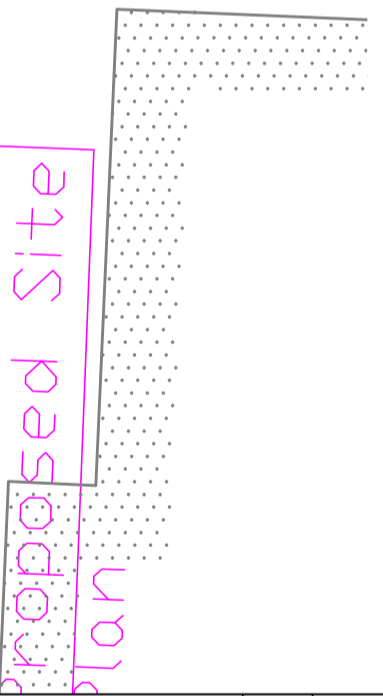
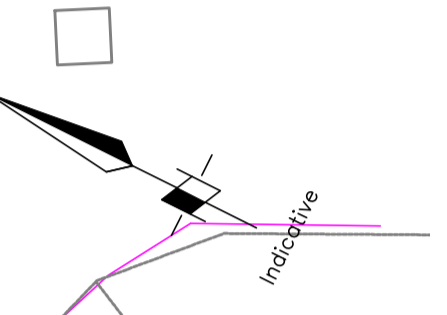

DO NOT SCALE FROM DRAWING  
The original of this drawing was produced in colour - a monochrome copy should not be relied upon.



A	Scheme overlay for review	TB	AT	07/12/23
REV.	DESCRIPTION	DWN	CHK'D	DATE

CLIENT

PROJECT 17294.23/A1  
Abbotswood, Coombe Hill Road,  
Kingston Upon Thames, KT2 7DU

TITLE  
Tree Constraints Plan  
(TCP / Scheme Overlay)

DWN	DATE	CHK'D	DATE	APP'D	DATE	SCALE
RCK	28/07/2017	AT	31/07/2017			1:100



(Mail) Second Floor, 1 Hunter's Walk, Canal Street, Chester, CH1 4EB  
Telephone: 0333 123 7080 www.indigosurveys.co.uk

Drawing Number 17294.23/TCP/01  
REV. A

THIS DRAWING IS CONFIDENTIAL AND MUST NOT BE REPRODUCED WITHOUT THE CONSENT OF INDIGO SURVEYS LTD.