

Note:  
 Studio Q1.3 Ltd shall have no responsibility for any use made of this document other than for that which it was prepared and issued.  
 All dimensions and levels to be checked on site.  
 Any discrepancies should be reported to Studio Q1.3 Ltd.  
 This drawing should not be used without written permission from Studio Q1.3 Ltd.

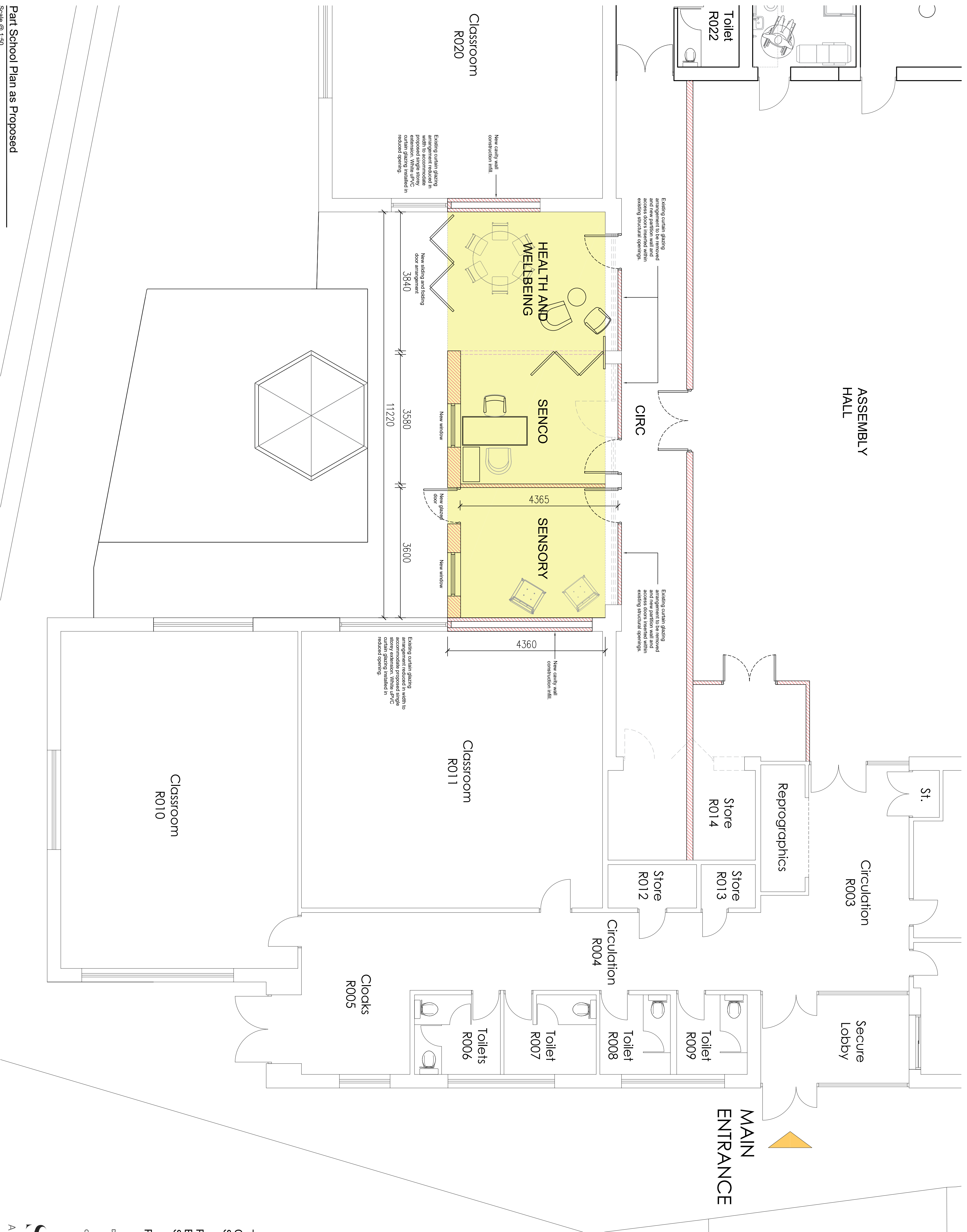

**FOR PLANNING**

No. Date Description Issued by

The School Governors of East Crompton St. James C.E. Primary School, Shaw, Oldham

Proposed Single Storey Extension to provide dedicated SEN Provision

Part School Plan as Proposed

Project number	305-11
Date	10.07.2024
Drawn by	DM
Checked by	CL3
Scale	As indicated