

Craggan Chaise, Glenlivet

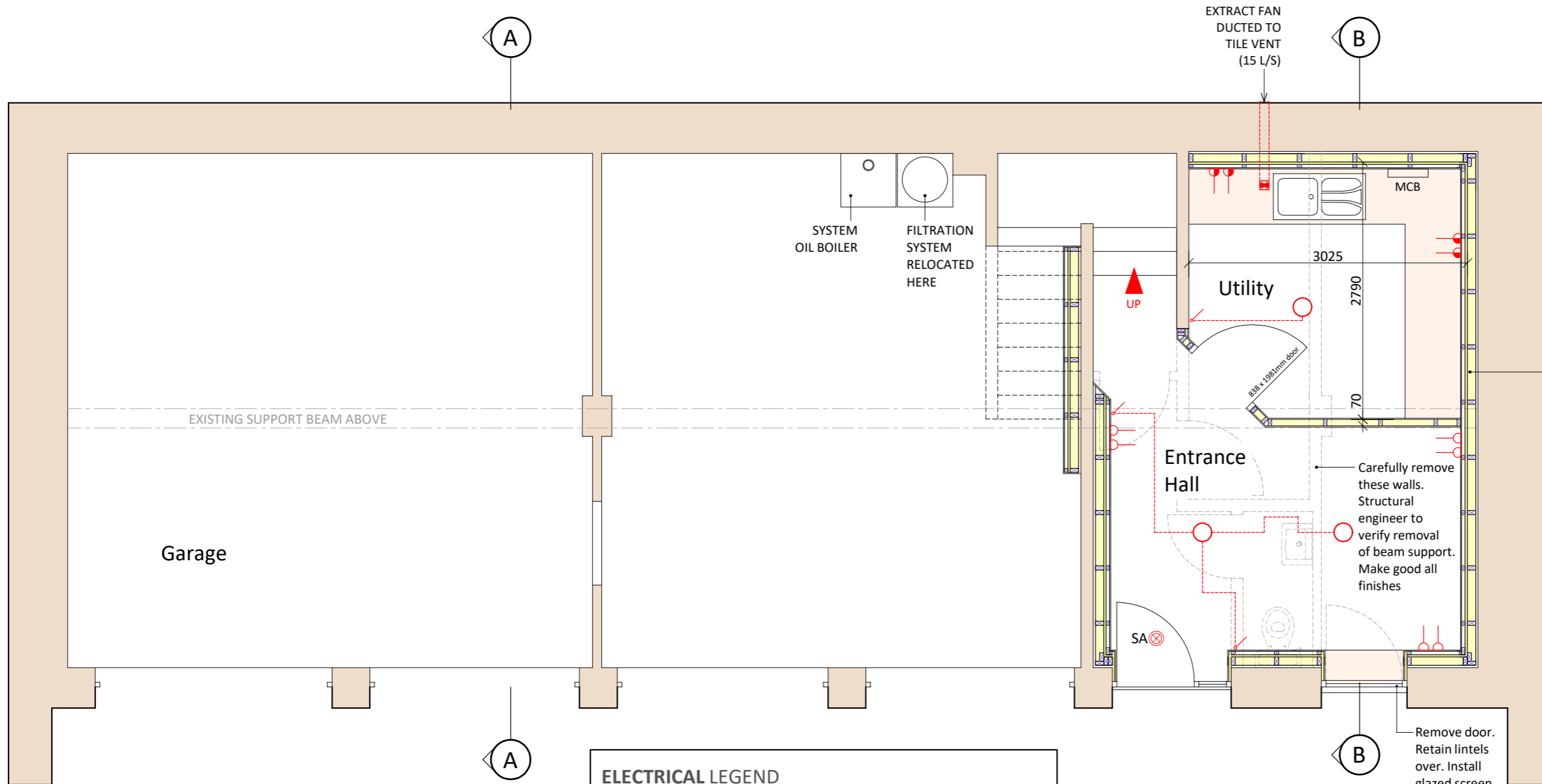

IMPROVED EXTERNAL HOUSE WALLS AT GROUND FLOOR (U-value 0.16 w/m2k)
Strip back walls to stone block face. Install damp proof membrane 1.1m up the stone wall to avoid any damp.

Form 25mm clear cavity using short lengths of 25mm diameter alkathene pipe between inner face of stone and new timber frame.

Timberframe panel to consist of Frameshield / Tyvek breather membrane. 9mm thick ext. grade plywood sheathing. 90 x 45mm treated w/w studs at 600mm max. centres, 90 x 45mm top and bottom runners with 90 x 45mm dwangs between and 90 x 45mm tie rail on top).

Insulation as below -
90mm FRAMETHERM 35 glasswool insulation between 90mm studs. 50mm PIR Kingspan insulation fixed across the face of the studs internally.

38mm service void formed by means of 38 x 45mm treated timber battens. 12.5mm thick VC plasterboard, screw fixed with taped and filled finish.

Remove door. Retain lintels over. Install glazed screen as denoted

ELECTRICAL LEGEND

- PENDANT
- LED DOWNLIGHTER
- LIGHT SWITCH
- EXTRACT FAN
- DOUBLE 13A OUTLET AT SKIRTING LEVEL (400mm)
- DOUBLE 13A OUTLET AT WORKTOP LEVEL (1100mm)
- SA ⊗ SMOKE ALARM
- HD ● HEAT DETECTOR
- CM ● CARBON MONOXIDE DETECTOR
- CD ● CARBON DIOXIDE MONITOR

GROUND FLOOR PLAN

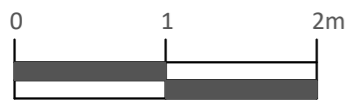

SCALE 1:50

DATE	SCALE	DRG. NO.
MAY 2023	AS STATED (A3)	DAMER / BW / 01

Proposed conversion of apartment above detached garage to holiday accommodation at Craggan Chaise, Glenlivet, Ballindalloch AB37 9EB For Mr P.Damer

S Reid Design
CHARTERED ARCHITECTURAL DESIGN SERVICE

S.REID MCIAT
CHARTERED ARCHITECTURAL TECHNOLOGIST
THE SMA GLEN, ROTHES, ABERLOUR, AB38 7AG
M - (07598) 299753
M - (07926) 151101
E - info@sreiddesign.co.uk
W - www.sreiddesign.co.uk