

Location Plan 1: 1250

Sunroom Ventilation:
 Ventilation provided by Sunroom.
 1no. 4-part patio door – 2.61m²,
 2no. TnT windows – 1.52m² (each).
 2no. trickle vent provided head of each TnT window, providing a min' 6000mm² vent area each.

Fixings.
 Sunroom bolted to house wall with 10mm dia' expanding bolts at 450mm c/c. Cills fixed to dado walls with 140x10mm dia' fisher fixings at 600mm c/c.

Sunroom Windows/ Doors:
 Rosewood/ White PVCu framed double glazed windows and doors. All glazing to comply with BS6262 & 6206. U-value of windows/doors – 1.20W/m²k.

New Solid Roof Construction: (0.12W/m²k)
 Britmet roofing system, with A-A surface spread of flame classification, layed straight onto breathable membrane roofing felt (supplied by roof manufacturer) on 9mm OSB with 70mm Kingspan Kooltherm Phenolic insulation bonded to OSB layed onto aluminium rafters and 18mm OSB with 100mm GEPS insulation bonded to OSB layed inbetween aluminium rafters. All OSB/insulation boards fixed down onto rafters as per manufacturers instructions. Roof finished internally with 37.5mm thk ins' backed plasterboard. Wet skim plaster finish to be applied to plasterb'd. For full sectional details refer to drg C6007/04.

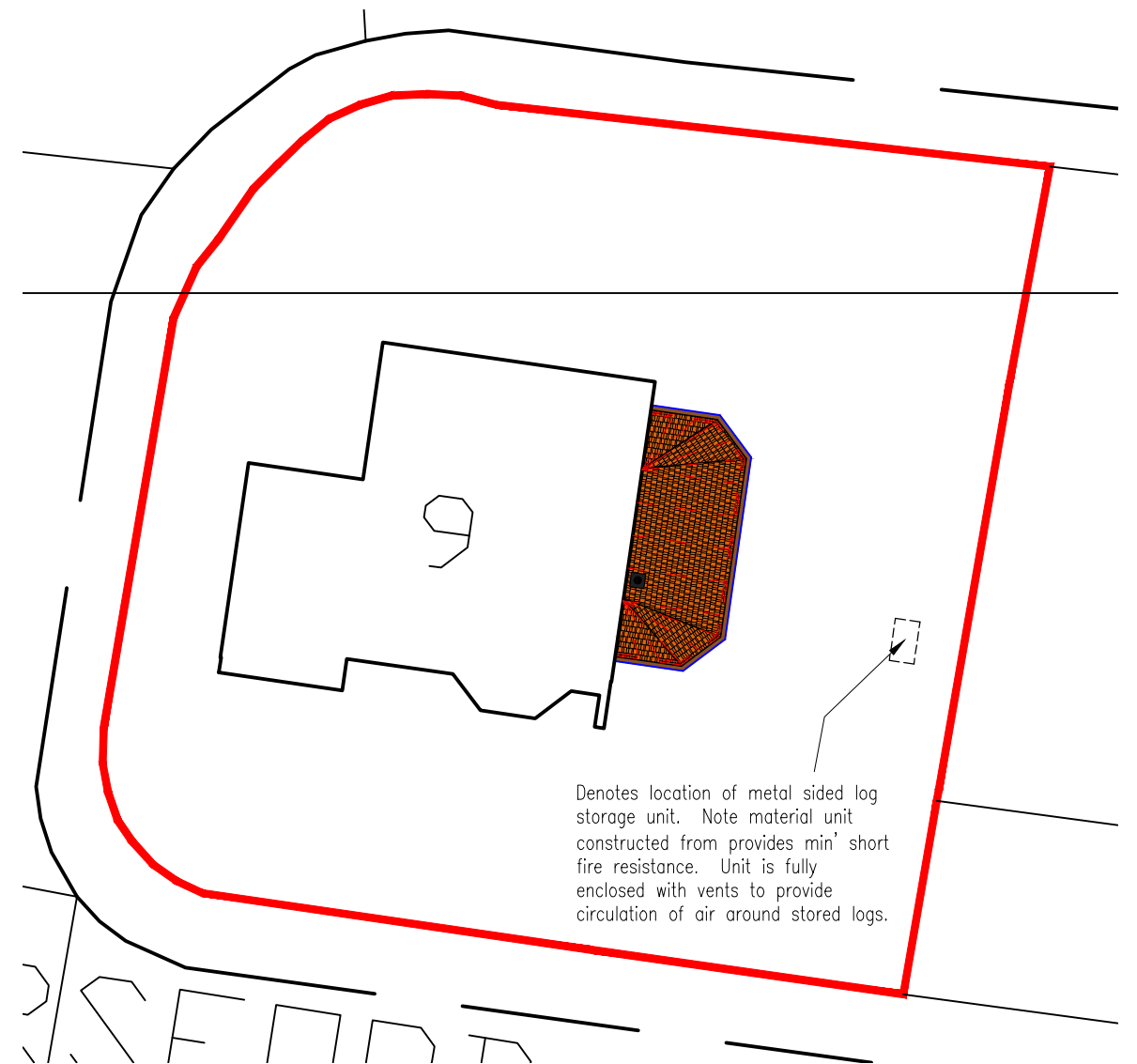

Denotes location of metal sided log storage unit. Note material unit constructed from provides min' short fire resistance. Unit is fully enclosed with vents to provide circulation of air around stored logs.

Proposed Site Plan 1: 200

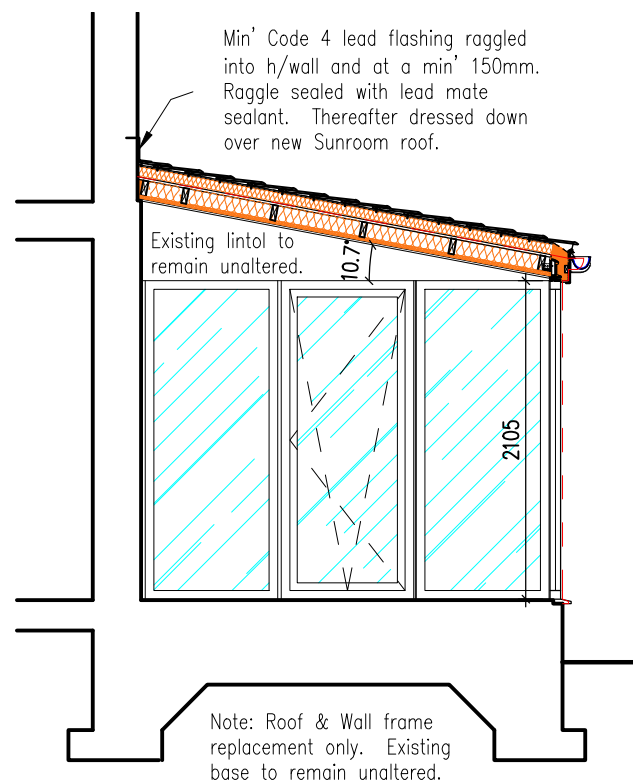
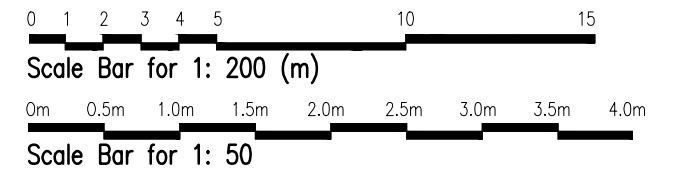

Proposed Section A-A 1: 50

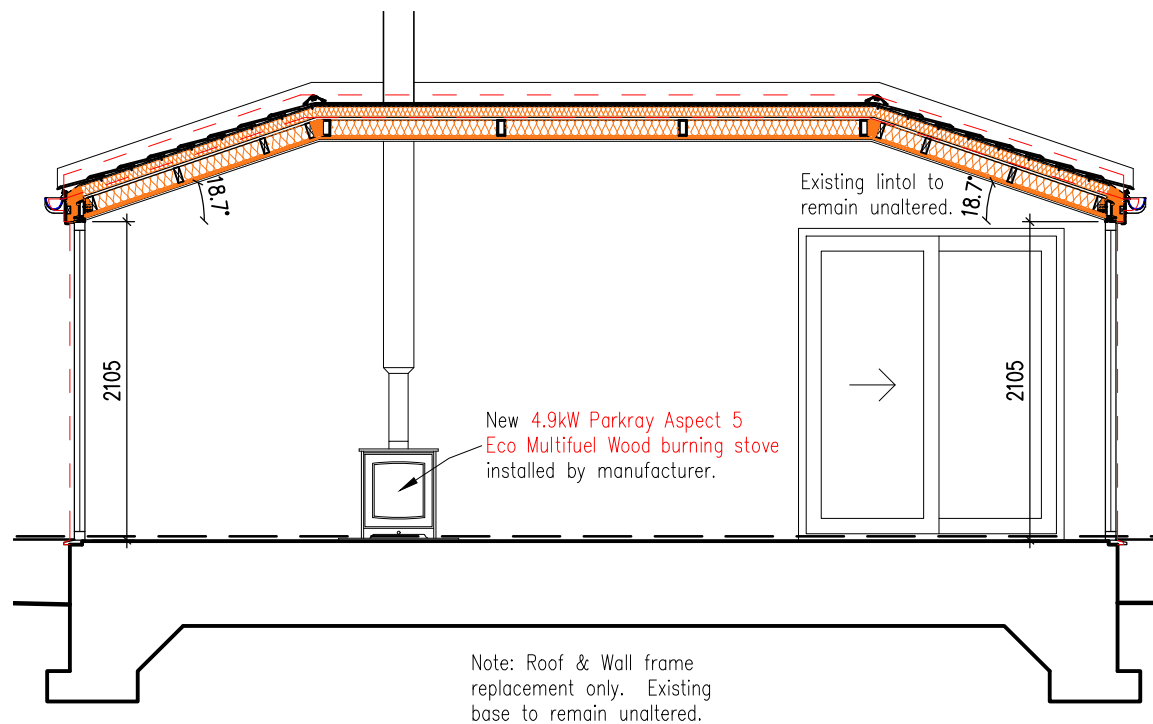

Proposed Section B-B 1: 50

Bryant Cairns
 WINDOWS & CONSERVATORIES
 AND
 2/3 Borthwick View
 Pentland Industrial Estate,
 Loanhead,
 Midlothian,
 Scotland EH20 9QH.
 Tel: 0131 440 2855
 Fax: 0131 448 2096
 Web: BryantandCairns.co.uk

Proposed Sunroom
 at: 9 Spilmersford View, Pencaitland
 for: Mr & Mrs J. Cormack

Work: Home:
 drawing title:
 Site, Location Plans & Sections

drawing no. C6007/03	revision: A	drawn by: TO	date: 15.01.24	scale: see drg
-------------------------	----------------	-----------------	-------------------	-------------------