



FF01



FF02



FF05



FF09



FF12



FF13



FF14



FF15

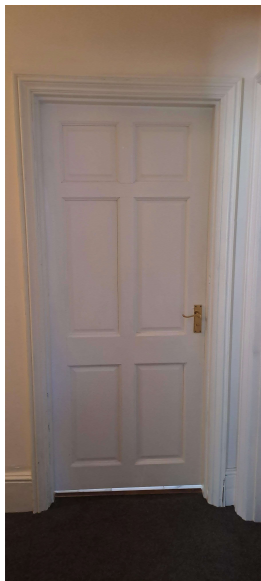

FF16



FF18

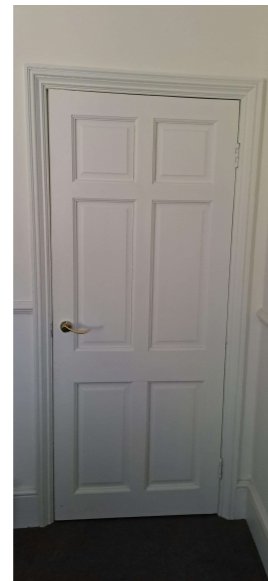

FF19



FF21



FF22



FF24



FF26

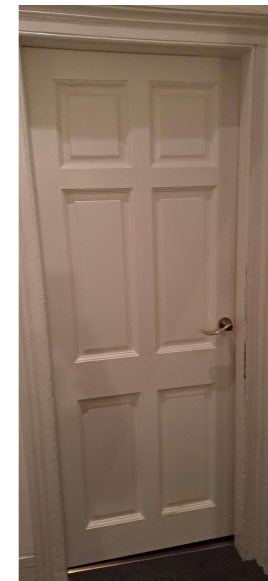

FF28

FF01, 02, 05, 09, 12-16, 18, 19, 21, 22, 24, 28
Existing panelled door upgraded to FD30's
FF26 Existing door FF26 widened to 750mm clear width – existing modern door casing removed and upgraded to FD30's
FF30 New FD30's door to match existing
 (refer drawing No PL_03.6 for specifications)



2F01 corridor

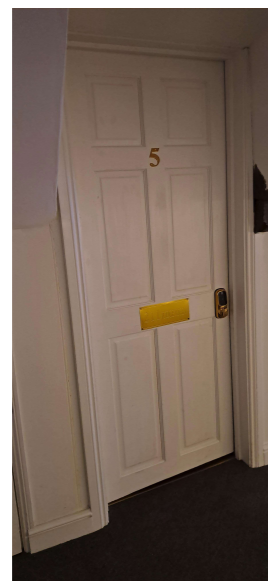

2F03



2F04

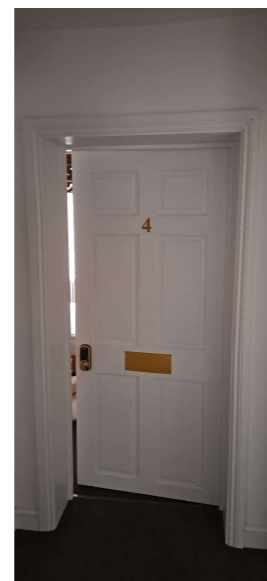

2F05



2F07

2F01, 03, 04, 05, 07
Existing panelled door upgraded to FD30's
2F08 New FD30's door
 (refer drawing No PL_03.6 for specifications)

New REI60 minute rated fire curtain to create a protected means of escape from fire. Curtain to be fixed to a new bulkhead, scribed around existing historic cornice to ensure no damage to historic fabric. Installation to be fully reversible.

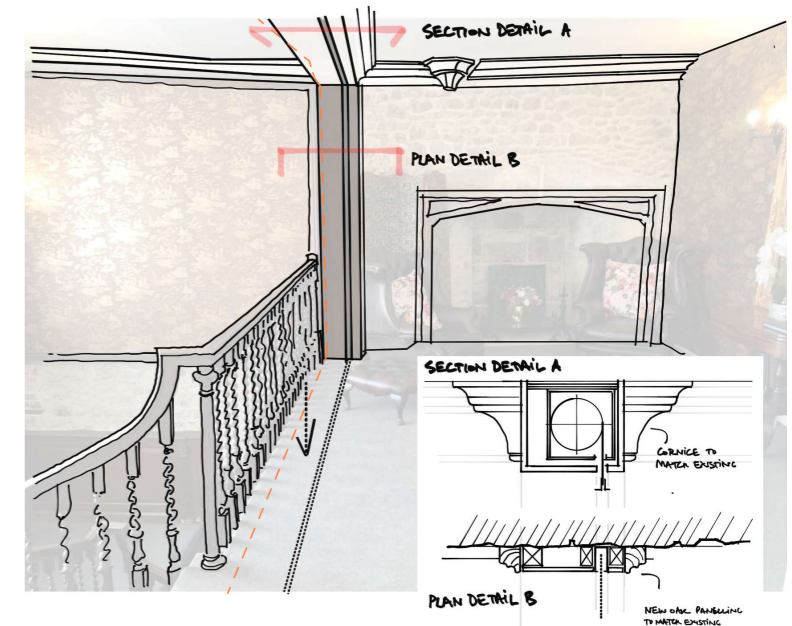

Photographic door schedule - First floor + Second floor

Planning and Listed Building Consent