

Notes: This drawing is the copyright Paddock Johnson Partnership Limited and may not be used without their prior written consent. Written dimensions to be taken in preference to scaled dimensions. Due to the inaccuracies of scanning, scanned images should not be scaled.

REV:	DATE:	DESCRIPTION:	BY:
A	12.01.24	Status updated to 'Planning'	OM

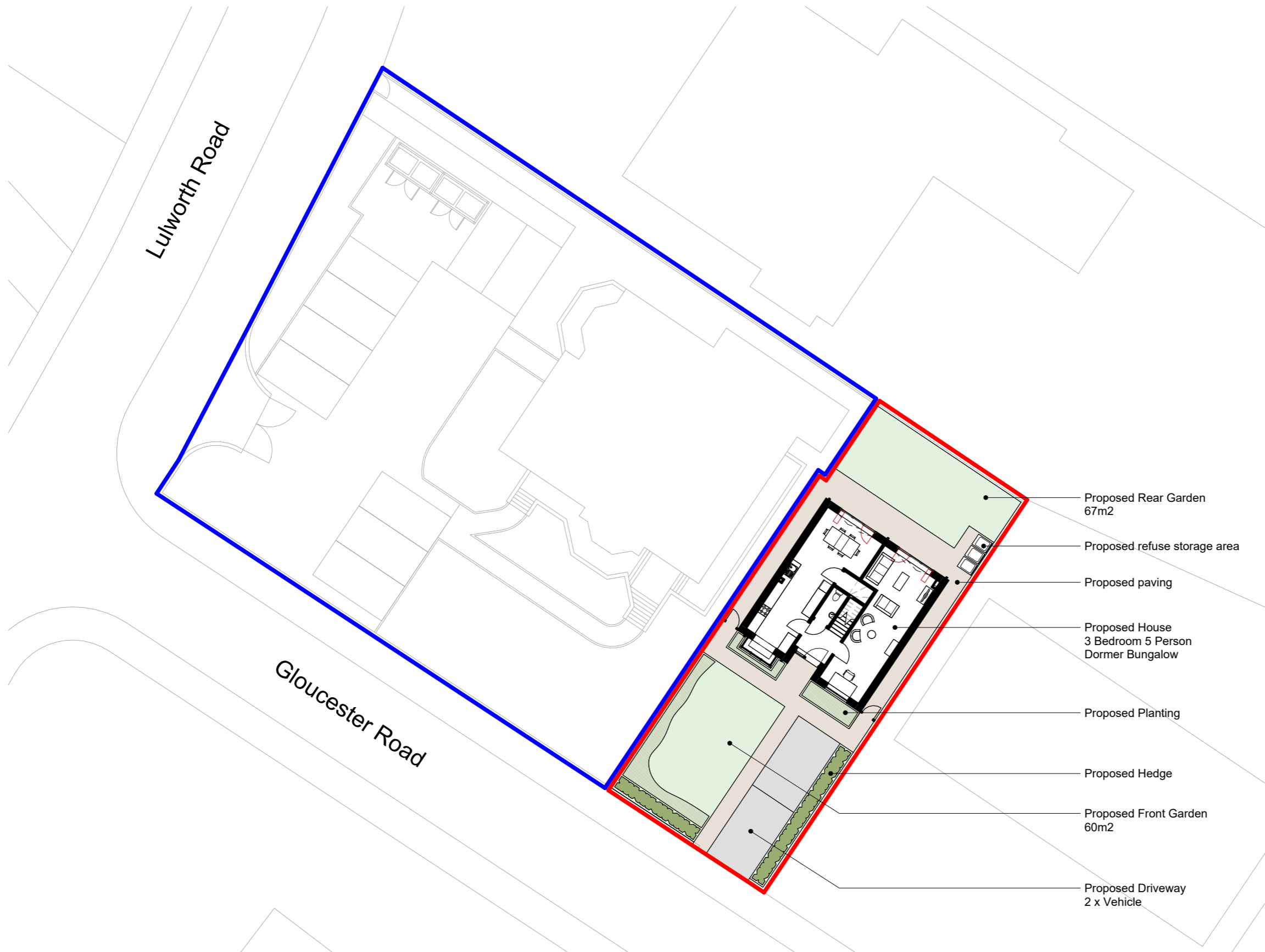

- Proposed Rear Garden 67m<sup>2</sup>
- Proposed refuse storage area
- Proposed paving
- Proposed House 3 Bedroom 5 Person Dormer Bungalow
- Proposed Planting
- Proposed Hedge
- Proposed Front Garden 60m<sup>2</sup>
- Proposed Driveway 2 x Vehicle

**1 00 Proposed Site Plan**  
Scale: 1 : 250

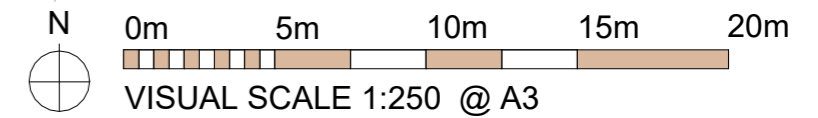

CLIENT: Mart Build

PROJECT: New House  
1E, Gloucester Road, Southport,  
PR8 2AU

DRAWING TITLE: Proposed Site Plan

DRAWING NUMBER: **24005-PJA-00-ZZ-DR-A-1200-A**

SCALE: 1 : 250@A3

DATE: 11.01.24

STATUS: **PLANNING**

BY: OM

CHECKED: SH



Studio 2, The Lyceum,  
Bath Street, Port Sunlight,  
Merseyside, CH62 4UJ  
0151 643 1234  
admin@paddockjohnson.com  
www.paddockjohnson.com  
Paddock Johnson Partnership  
Limited. Registered in England  
and Wales. No. 06684275