

EXISTING SHOP FLOOR PLAN
SCALE 1:50

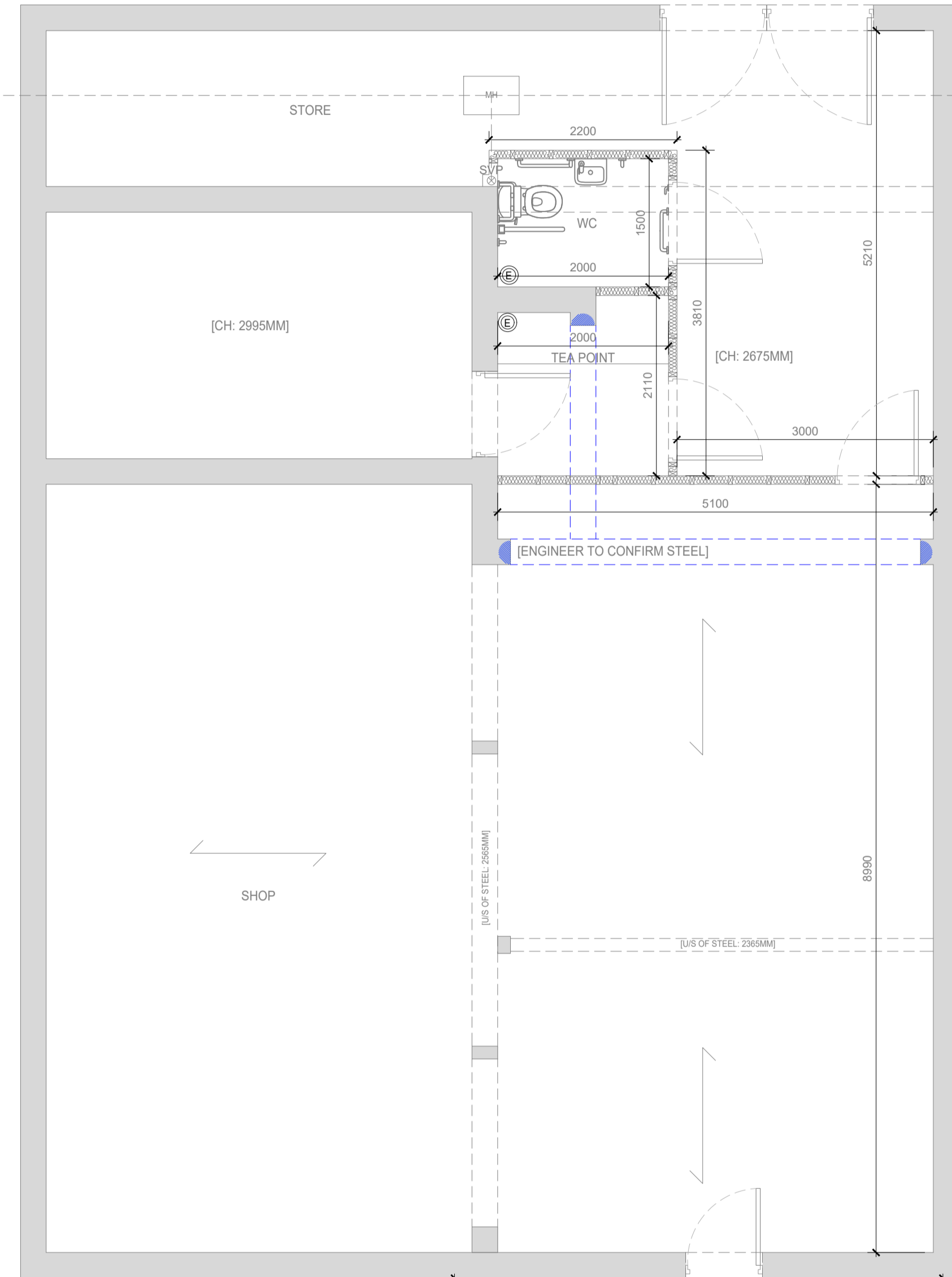

PROPOSED SHOP FLOOR PLAN
SCALE 1:50

LEGEND

FULL FILL CAVITY WALL
To achieve minimum U Value of 0.18 W/m²K.
New cavity wall to comprise of 100mm suitable facing brick. Full fill cavity with 175mm Rockwool Cavity insulation as manufacturer's details. Inner leaf to be 100mm medium block. 0.45 W/m²K. Internal finish to be 12.5mm plasterboard on dabs. Walls to be built with 1:1.6 cement mortar.

FULL FILL CAVITY WALL
To achieve minimum U Value of 0.18 W/m²K.
20mm two coat sand/cement render to comply to BS EN 13914-1 with waterproof additive on 100mm standard block. 0.45 W/m²K. Fully fill the cavity with 175mm Rockwool cavity insulation as manufacturer's spec. Inner leaf to be 100mm standard block. 0.45 W/m²K. Internal finish to be 12.5mm plasterboard on dabs. Walls to be built with 1:1.6 cement mortar.

INTERNAL STUD PARTITIONS
100mm x 50mm softwood treated timbers studs at 400mm cts with 50 x 100mm head and sole pieces and solid intermediate horizontal noggins at 13 height or 450mm. Provide min 10kg/m² density acoustic soundproof quilt tightly packed (eg 100mm Rockwool or Iso wool mineral fibre sound insulation) in all voids the full depth of the stud. Partitions built off doubled up joists where partitions run parallel or provide noggins there at right angles, or built off DPC on thickened concrete slab if solid ground floor. Walls faced throughout with 12.5mm plaster board with skim plaster finish. Taped and jointed complete with beads and stops.

INTERNAL MASONRY PARTITIONS (BLOCKWORK)
Construct non load bearing internal masonry partitions using dense concrete blocks built off thickened floor slab and face at 200mm centres with proprietary steel profiles or block bonded to all internal and external walls. Walls faced throughout with 12.5mm plasterboard on dabs with skim plaster finish or 13mm lightweight plaster.

SUPPORTING BEAM
New steel beams to be encased in 12.5mm Gyproc FireLine board with staggered joints. Gyproc FireCase or painted in Nulite 5 or similar intumescent paint to provide 1/2 hour fire resistance as agreed with Building Control. All fire protection to be installed as detailed by specialist manufacturer. Engineer to confirm all steel and structural work.

EXTERNAL BRICKWORK WALL
100mm brick external walls with 100 X 400mm piers at maximum 3.0m cts.

REVISIONS

REV	DATE	CHANGES
0	01/11/23	Initial Draft
2	30/11/23	Amendments
3	11/12/23	Amendments
4	12/12/23	Amendments
5	14/12/23	Amendments

JOB INFORMATION

ADDRESS: DEAN BANK
CONVENIENCE STORE, 1-2 HAIG
TERRACE, FERRYHILL, DL17 8NR

CLIENT NAME: ANANTH
SUBBARAYAN

PROJECT: INTERNAL ALTERATIONS TO
SHOP

DRAWINGS :

Existing & Proposed Plans - Page 01

DATE :
14/12/23

SCALE :
1:50 @A1

DRAWN BY : PF
CHECKED BY : BW

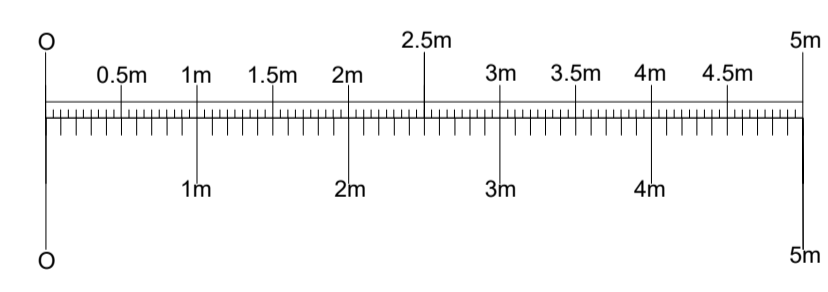

- All Rights Reserved.
- This Drawings must not be reproduced without permission.
- Do not Scale off Drawings.
- All dimensions to be checked by contractor on-site.
- Construction must only commence once planning, building control and any other relevant approvals have been obtained.
- It is the responsibility of the owner to ensure approvals have been granted.
- Any discrepancies must be reported to the architect, surveyor, engineer or responsible person immediately.
- The contractor is responsible for ensuring compliance with the cdm regulations and mandatory h&s on site precautions.
- The client/building owner must obtain the necessary party wall agreements prior to commencing works on site.