

Do not scale from this drawing.  
 Check drawing on receipt and immediately report any discrepancies to the Architect.  
 Verify all dimensions and levels on site prior to construction.  
 The contents of this drawing are Stiff + Trevillion Architects LLP copyright and shall not be re-used without their written permission.

Notes

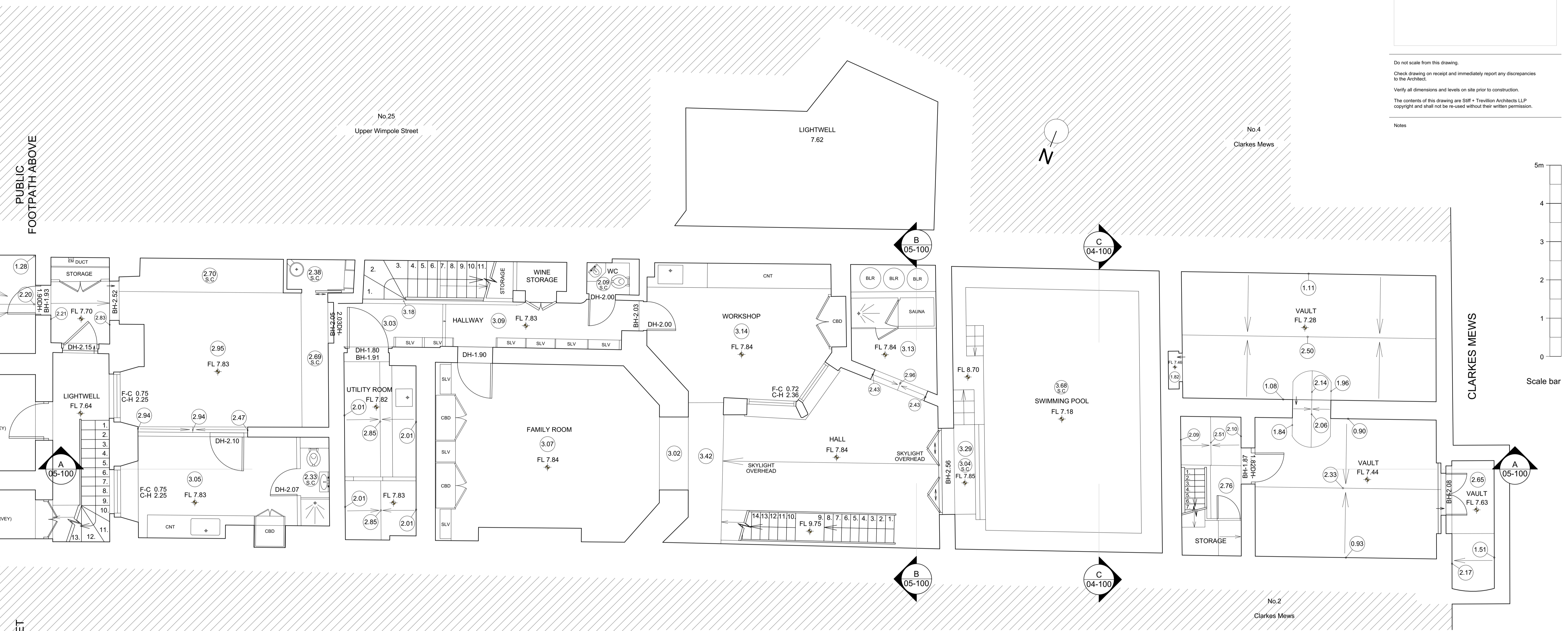
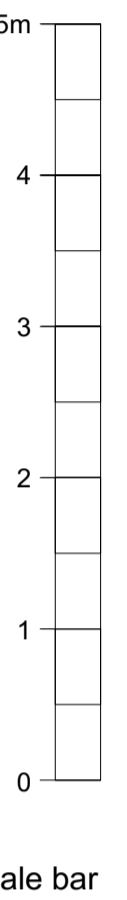

Rev. Date Approved Note

**Stiff + Trevillion**  
 Stiff + Trevillion Architects Ltd  
 16 Woodfield Road  
 London W9 2BE  
 T +44(0)20 8960 5550  
 mail@stiffandtrevillion.com  
 www.stiffandtrevillion.com

Client  
**Susan and Andrew Dawood**

Project  
**3 Clarke's Mews/  
 24 Upper Wimpole Street  
 W1G 6NE London**

Drawing Title  
**Existing Lower Ground Floor Plan**

| Drawing Status            | Drawn      | Checked    | Revision   |
|---------------------------|------------|------------|------------|
| Planning                  |            |            |            |
| Project No.               | Date       | Scale @ A1 | Scale @ A3 |
| 4788                      | 07/07/2023 | 1:50       | 1:100      |
| Drawing Number            |            |            |            |
| 4788-STA-XX-XX-DR-A-01099 |            |            |            |

1 Existing Lower Ground Floor Plan  
 Scale: 1:50