

Key Plan

LEGEND

New construction

Do not scale from this drawing.
 Check drawing on receipt and immediately report any discrepancies to the Architect.
 Verify all dimensions and levels on site prior to construction.
 The contents of this drawing are Stiff + Trevillion Architects LLP copyright and shall not be re-used without their written permission.

Notes

Scale bar

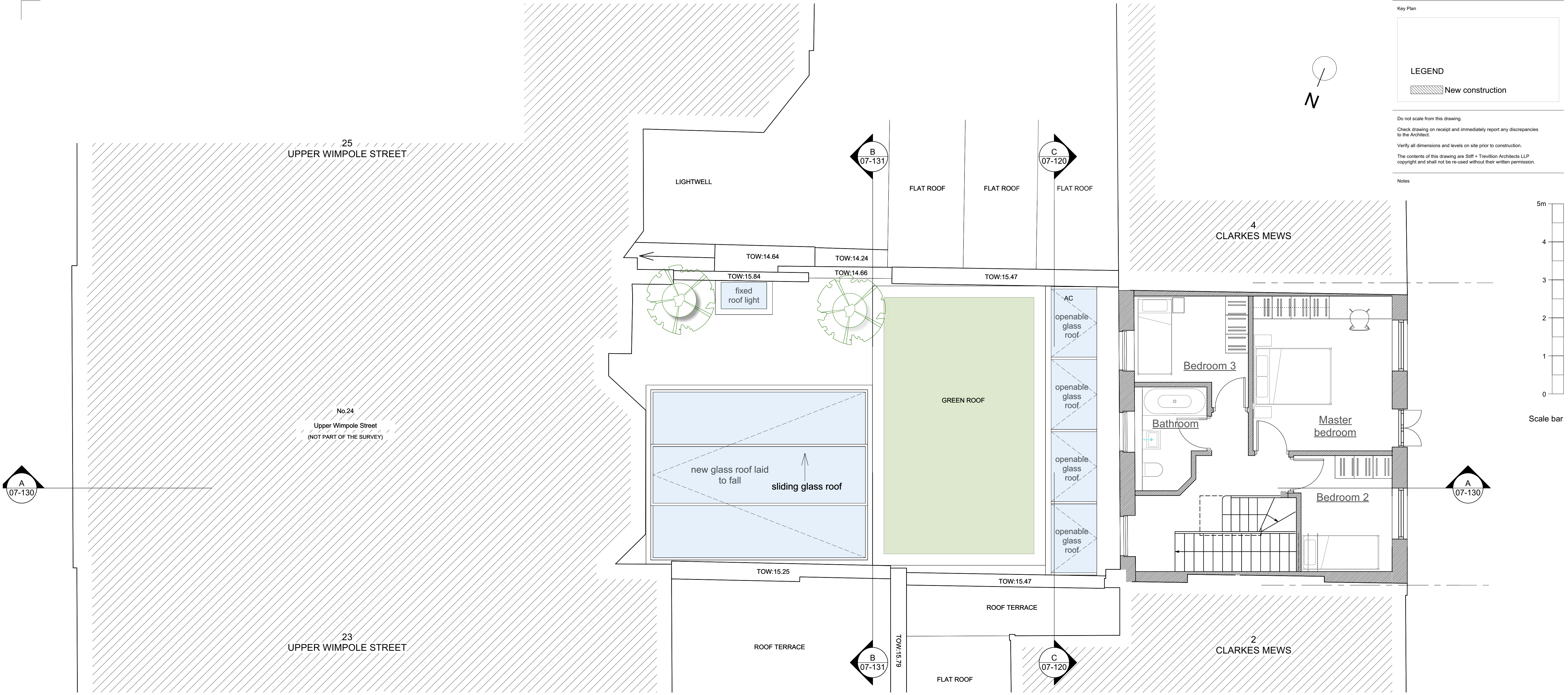

Rev.	Date	Approved	Note

Stiff + Trevillion
 Stiff + Trevillion Architects Ltd
 16 Woodfield Road
 London W9 2BE
 T +44(0)20 8960 5550
 mail@stiffandtrevillion.com
 www.stiffandtrevillion.com

Client
Susan and Andrew Dawood

Project
**3 Clarkes Mews
 24 Upper Wimpole Street
 W1G 6NE London**

Drawing Title
Proposed First Floor Plan

Drawing Status	Drawn	Checked	Revision
Planning			

Project No.	Date	Scale @ A1	Scale @ A3
4788	29/06/2023		1:100

Drawing Number
4788-STA-XX-XX-DR-A-07101

PROPOSED FIRST FLOOR PLAN
 Scale 1:50 @ A1, 1:100 @ A3