

The Oak Barn

Old Dairy Farm

Notes:
 Whilst every care has been taken to ensure the accuracy of this survey, due to the age of the premises, non-exposure of the structure, occupancy, building methods & materials used, some assumptions have been made necessary.
 Specific areas must be checked on site prior to manufacture of fittings, ordering of materials & equipment & commencement of building operations.
 Any conflicting information found on the drawing must be reported for clarification.
 Under the 'control of asbestos regulations 2012' for buildings constructed before 2000, the building owner / tenant is legally obliged to manage the asbestos content within the premises. This is accomplished with an asbestos survey which will identify & make recommendations on how to manage any asbestos found. This specialist survey is not within the remit of Ampersand Associates Ltd & the client is strongly advised to check if there is already a suitable report available. If not, a 'Management' asbestos survey should be instigated by the client to cover the entire building, with a further 'Refurbishment & Demolition' survey being carried out, targeting all areas affected by any proposed works by a registered UKAS company. These surveys are to be made readily available prior to any operations commencing.

All drawings produced adopt the principles of prevention in accordance with CDM2015 regulations. Hazards where foreseen have been considered and either designed out or managed where feasible. Any and all associated 3rd party drawings and designs must also take into account the CDM2015 principles of prevention as part of their production.
 By agreeing to the fee offer, the Client purchases raster & RVD copies of this drawing only. Ownership of the vector files remains with Ampersand Associates Ltd & permission to distribute may be withheld.
 Do not scale from drawing.

REVISIONS:

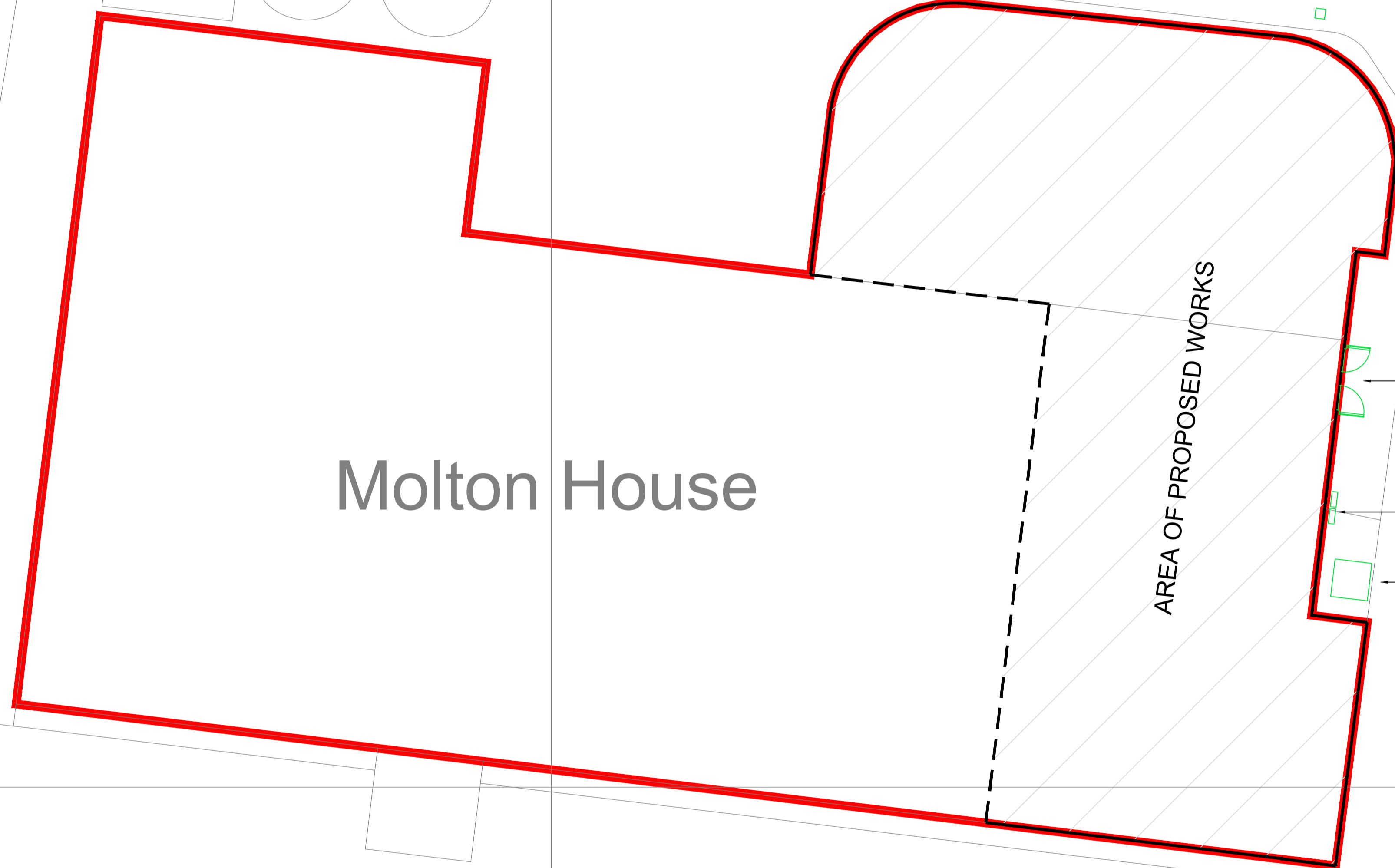

proposed waste water tank

El Sub Sta

proposed chiller/AHU condenser

proposed extract/supply ductwork

relocated a/c condensers

AREA OF PROPOSED WORKS

Molton House



ampersand associates

3 The Stables
Cannons Mill Lane
Bishops Stortford
Hertfordshire
CM23 2BN

t: 01279 505023
e: amp@ampersand-associates.com
w: ampersand-associates.com

commercial architectural design. and then some

CONTRACT:
Molton Brown
Green Street
Elsenham
Bishop's Stortford
CM22 6DS

WHAT3WORDS:
famous.torch.handfuls

DRAWING:
Site Plan

SCALE: 1:200 @A1
DATE: 07.12.23
DRAWN: DS/LT23

DRAWING No: 8555/12
REV:

