

proposed elevations

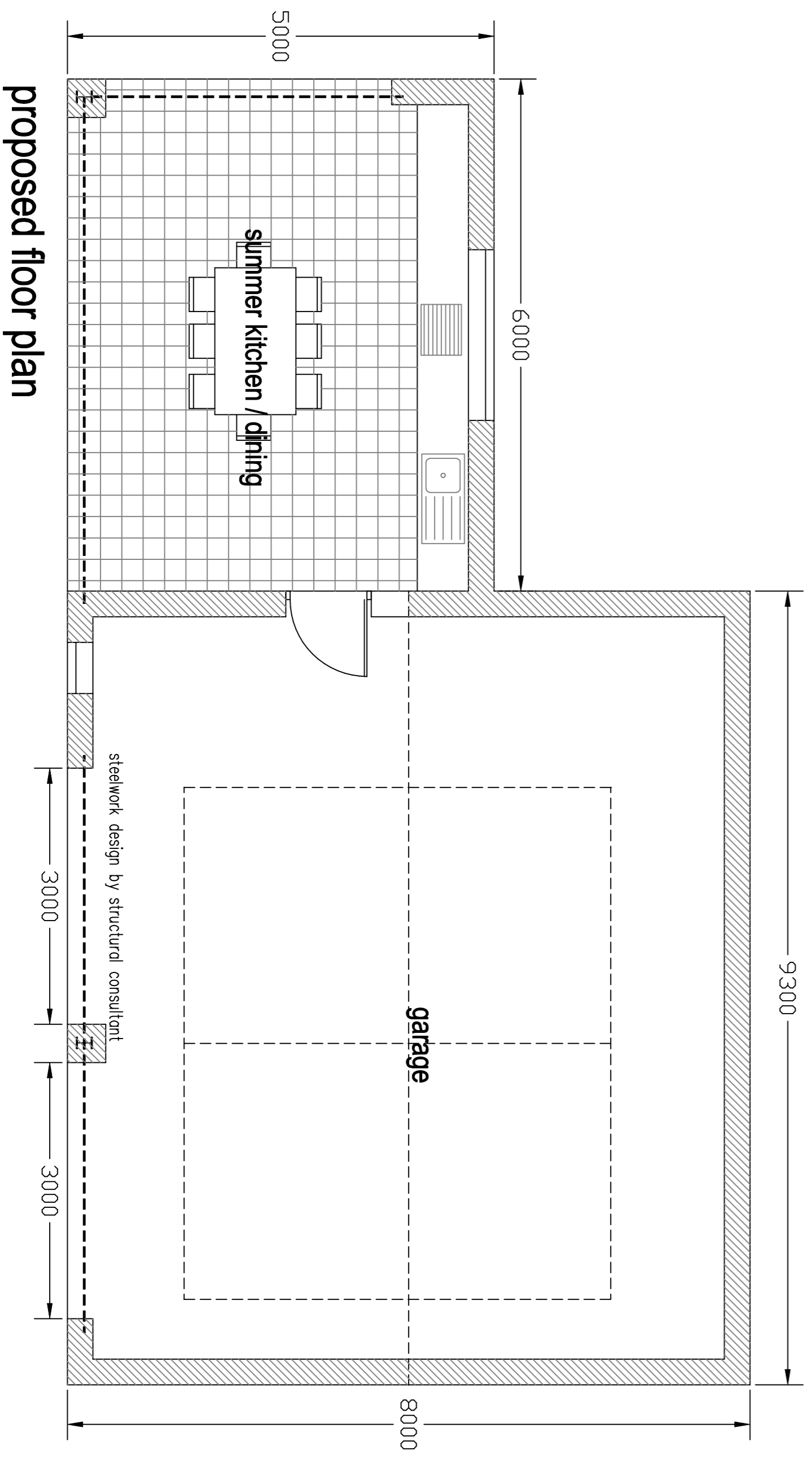

amended 06-12-22  
 garage footprint reduced and relocated  
 to maintain clearance from site boundary of min 2m  
 garage ridge height reduced to 4m

**proposed garage +  
 summer kitchen**

proposed alterations and refurbishment  
 including elevational changes and construction  
 of 2 car garage with summer kitchen at  
**538 Newchurch Road**  
**Rawtenstall**

scale 1:50 @ A1

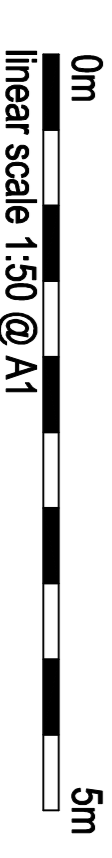

drawing number PG-18-07-22-EE