

KEY:

	Existing Walls
	Proposed Walls
	Demolition

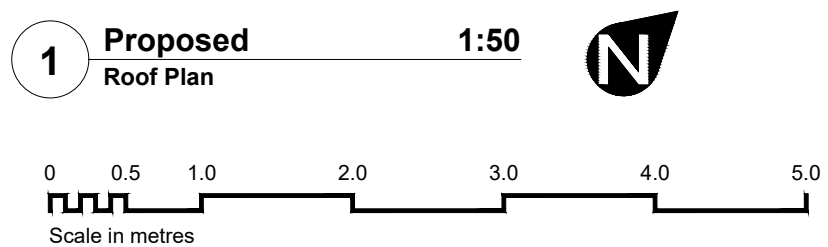
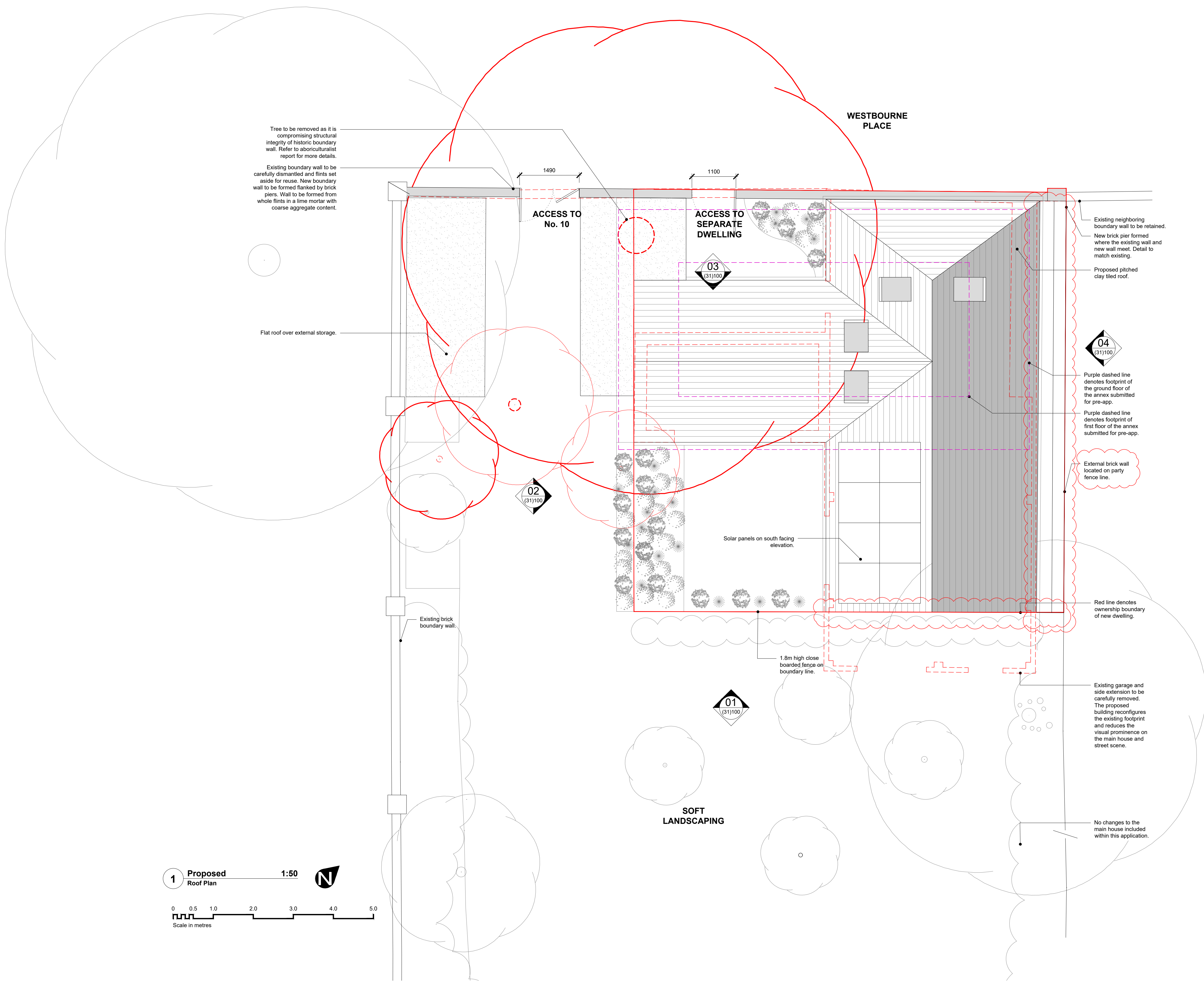

Rev.	Date	Notes	Drawn	Checked
F	19/01/2024	House moved 650mm North East to engage arty wall.	SJH	LH
E	10/11/2023	Amendment to gate, roof and boundary fence.	LH	LH
D	05/09/2023	Solar Panels added to south elevation.	LH	LH
C	08/08/2023	Rooflights added.	LH	LH
B	03/08/2023	Issued for approval	LH	LH
A	07/07/2023	Issued for information	LH	LH
/	03/07/2023	Issued for information	LH	LH

WILLOW
DESIGN PLANNING DELIVERY

370 Brighton Road, Shoreham by Sea, BN43 6RE
tel. 01273 456519 info@willowarchitects.net

Client:
Claire & Steve Evans

Project:
**1003
10 Princes Crescent, Hove**

Drawing:
**Proposed
Roof Plan**

Scale	Drawn By	Checked By	Issued For
1:50@A1	MB	LH	APPROVAL
Drawing No.	Revision		
1003(21)101			F