

Ground Floor Plan.

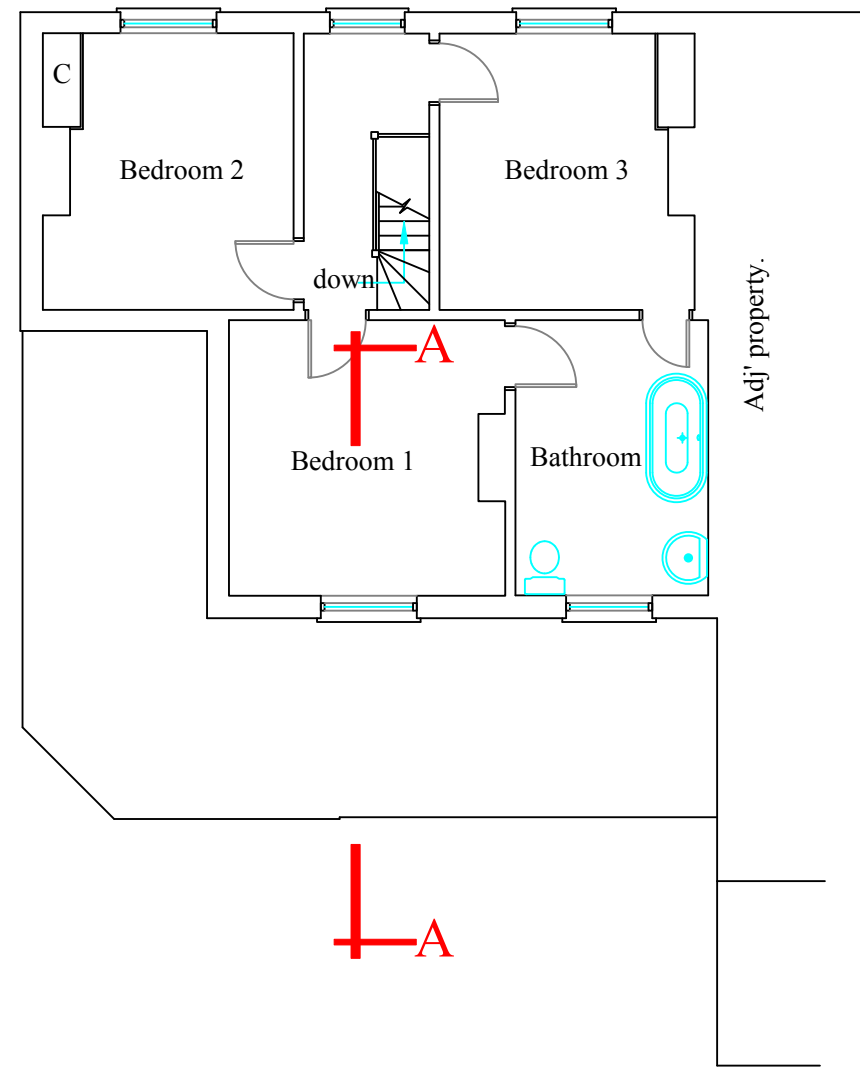

First Floor Plan.

ALL LEVELS AND DIMENSIONS MUST BE CHECKED ON SITE THESE DRAWINGS ARE TO BE READ IN CONJUNCTION WITH ENGINEERS, AND ALL OTHER SPECIALIST CONSULTANT DETAILS. THIS DRAWING IS COPYRIGHT OF MACAIRE ASSOCIATES. IT IS THE CLIENTS RESPONSIBILITY TO AGREE ANY ALTERATIONS TO APPROVED PLANS WITH THE PLANNING AND BUILDING REGULATION AUTHORITIES. IT IS THE CLIENTS RESPONSIBILITY TO READ AND COMPLY WITH CONDITIONS IMPOSED ON ANY PLANNING AND BUILDING REGULATION APPROVALS ASSOCIATED WITH THESE PLANS, INCLUDING AGREEING MATERIALS AND FINISHES WITH PLANNERS PRIOR TO COMMENCEMENT.

Date: October 2023
Drawn by: O.A. + PM
Checked by:

Revision:

Scale: A3 @ 1:100
Drawing N°: 40-2023-2

Location: 4 The Avenue, Gurnard, Cowes, Isle of Wight. PO31 8JL
Project: Proposed Alterations & Extensions. EXISTING FLOOR PLANS.

'The Dairy' at Hebbardens,
Yarmouth Road, Shalfleet,
Newport,
Isle Of Wight,
PO30 4NB.
Tel: 01983 555132

