

How trees are specified: a bit about the common form of trees & hedging

In common with plants and shrubs, trees and hedging are specified by reference to their botanical names, e.g. *Acacia campestre*, *Quercus robur* and then by:

- 👉 Form
- 👉 Age/Condition or number of times transplanted
- 👉 Root collar diameter at ground level or girth at 1 metre
- 👉 Overall height
- 👉 Clear stem height
- 👉 Root form - banyan root, rootballed, container bays

FORMS AVAILABLE

The common forms in which trees and hedging are sold are listed below and are defined in more detail in the Glossary. We use clear terms to be found in the National Plant Specification of the Horticultural Trades Association.

TRANSPLANTS

Small unrooted seedlings are sold in containers or bags, which are then planted in the ground. The term usually applies to plants which are too small to be planted in the ground or to transplants for root cuts. We use both to encourage plants with an established root system, which are more likely to survive. Individual plants are usually sold in containers or bags, but some are sold in large quantities, e.g. for hedging. The plants are usually sold in containers or bags, but some are sold in large quantities, e.g. for hedging. The plants are usually sold in containers or bags, but some are sold in large quantities, e.g. for hedging.

WHIPS

Whips are single slender stems, which are usually sold in bundles. The term usually refers to woody stems which are sold in bundles. The term usually refers to woody stems which are sold in bundles.

FEATHERED TREES

Feathered trees have a central trunk and a wide, spreading canopy. The term usually refers to trees with a central trunk and a wide, spreading canopy.

STANDARDS

Standards are trees with a relatively upright stem, which is without branches, supporting a rounded canopy. The term usually refers to trees with a relatively upright stem, which is without branches, supporting a rounded canopy.

HOW BIG IS BIG?
SOME OF THE TREES WE SUPPLY ARE SO BIG THEY WON'T FIT IN A STANDARD ARTICULATED TRAILER AND NEED A POLICE ESCORT!



PLEASE NOTE: The form and height of a tree are specified in the reference only and are not used proportionally to one another.

OTHER FORMS AVAILABLE
Some more common forms in which trees are sold are listed below. Once again we use definitions to be found in the National Plant Specification of the Horticultural Trades Association.

SEEDLING
Seedlings are woody plants which have not yet developed a stem and are usually sold in containers or bags. Seedlings are usually sold in containers or bags. Seedlings are usually sold in containers or bags.

CUTTING
Cuttings are woody plants, from shoots, stems, or roots of a woody plant. They are usually grown from hardwood stems cuttings planted out in the late Autumn and are often growing for one or two years before being planted out. They are usually grown from hardwood stems cuttings planted out in the late Autumn and are often growing for one or two years before being planted out.

MAIDEN
Maidens are low woody plants in which the stem has grown for one season. The term maiden usually refers to trees which have been propagated vegetatively by grafting or layering. Maidens are usually sold in containers or bags. Maidens are usually sold in containers or bags.

SEMI-MATURE
Semi-mature trees have an overall height in excess of 2.6 metres and are usually sold in containers or bags. Semi-mature trees are usually sold in containers or bags.

MULTISTEMMED
Multi-stemmed trees have two or more main stems arising from one root system. This form reflects the natural characteristics of the tree.

BUSHY
Bushy trees have many main stems arising from or near ground level growing from one root system and which have been transplanted and grown on to a size in excess of 2.6 metres. These trees are usually sold in containers or bags. Bushy trees are usually sold in containers or bags.

For additional information about how trees are specified and to see just how much there is to see go to:
WWW.NURSERYMEN.CO.UK/TRADE/DOWNLOADS

This is Exhibit 8 (Photograph of Flat Roofed Structure (Orange Structure)) referred to in the Statutory Declaration of **Bean Chapman**

DECLARED AT *Chobham Adventure Farm, G424 8DB*

This *30th* day of May 2023

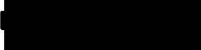
BEFORE ME  *GREGORY BARNBROOK*

~~Commissioner for Oaths~~/Solicitor

KEYSTONE LAW

48 Chancery Lane, London
WC2A 1JF Tel: 020 3319 3700
www.keystonelaw.co.uk



This is Exhibit 9 (Anthony Gallagher Statutory Declaration for 19/2275/CEU) referred to in the Statutory Declaration of **Bean Chapman**

DECLARED AT *Chobham Adventure Farm, G424 8DB*

This *30th* day of  May 2023

BEFORE ME

GREGORY BARNBROOK

~~Commissioner for Oaths/Solicitor~~

KEYSTONE LAW

48 Chancery Lane, London
WC2A 1JF Tel: 020 3319 3700
www.keystonelaw.co.uk

J. E. KENNEDY & CO.
SOLICITORS

~~J.E.KENNEDY~~
C.A.KENNEDY BSc

FAX NUMBER 020 8864 4900

**59/61 HIGH STREET
HARROW ON THE HILL
MIDDLESEX, HA1 3HT**

(OPPOSITE THE KINGS HEAD HOTEL)

TELEPHONE 020 8864 3056

RPS Consulting UK & Ireland
20, Western Avenue Milton Park
Abingdon
Oxfordshire
OX14 4SH

Our Ref: 4650
Your Ref: Mrs J Ramirez

4 December 2019

Attn Mrs Joney Ramirez MRTPI, Senior Planner

Dear Sirs

PART OF "HILLINGS NURSERIES", BAGSHOT ROAD, CHOBHAM,
WOKING GU24 8DB/ LEASE DATED 18/06/2015

I am a solicitor and at the request of Mr A J Gallagher of Easigrass Distribution Ltd I now attach original signed documentation as follows

- (1) Statutory declaration dated 4/12/2019
- (2) Figure 1 as referred to in (1) above

Please make sure that that postal address we have for you above is correct as soon as possible before close of business today at 4pm to avoid any delay in receiving this letter and its attachments.

I am copying this letter and its attachments as follows

joney.ramirez@rpsgroup.com

anthony@easigrass.com

We should be obliged if you would please acknowledge receipt in due course.

Yours faithfully

Caspar Kennedy
J E KENNEDY & CO SOLICITORS

casparkennedy@outlook.com

Statutory Declaration

In support of application for Certificate of Lawfulness of Existing Use or Development under Section 191 of the Town and Country Planning Act 1990 (as amended) for the siting of containers

at

Easigrass Chobham Depot, Bagshot Rd, Chobham, Woking GU24 8DB.

I, Anthony James Gallagher, Managing Director of Easigrass (Distribution) Ltd solemnly and sincerely make this Statutory Declaration in support of an application for a Certificate of Lawfulness of Existing Use or Development (CLEUD).

I DECLARE AS FOLLOWS:

1. I have been in the employ of Easigrass (Distribution) Ltd since 2 February 2010 and as Managing Director of the Chobham Depot since 18 June 2015. My role includes general management of the site and management of the business day-to-day operation on the site.
2. By 18th July 2015 we prepared the site and the ground to receive a number of containers which were purchased from 1st Containers (uk) Ltd. On 19th July 2015 the containers were stationed on site.
3. Since that date, the containers have been stationed on the land outlined in red as shown in Figure 1 (site location plan) submitted with this planning application and have been used as storage related to the activities on site.

I make these solemn declarations conscientiously believing the same to be true and by virtue of the provisions of the Statutory Declarations Act 1835.

Declared by Anthony James Gallagher, Managing Director at Easigrass Chobham Depot

At

J. E. KENNEDY & CO.
59/61 High Street
Harrow on the Hill
Middlesex HA1 3HT

This ^{4th} Day of *December* 2019

Before me (a solicitor empowered to administer oaths)

© 2019 RPS Group

1. This drawing has been prepared in accordance with the scope of RPS's appointment with its client and is subject to the terms and conditions of the appointment. RPS shall not be liable for any use of this document other than for the purposes for which it was prepared and provided. RPS shall not be held responsible for any errors or omissions, or for any consequences arising from the use of this document. The user assumes full responsibility for print to contract scale. Only written correspondence should be used.

Legend

- Site Location
- Other Land Under Ownership of Applicant

Casper Kennedy

This is figure 1 referred to in my statutory declaration dated 4/12/2019.



Rev	Description	By	CS	Date



20 Victoria Avenue, Mifflin Park, Adelaide, South Australia, 5014 4514
T: +61(0)1222 821 888 E: rps@rpsgroup.com

Client -
 Project - Eastgrass Depot
 Title - Site Location Plan
 Status - DRAFT
 Drawn By - BG
 Project Number - PPS1422
 Scale @ A3 - 1:1,250
 Date Created - OCT 2019
 PM/Checked By - JR
 Figure Number - 1
 Rev -
 rpsgroup.com

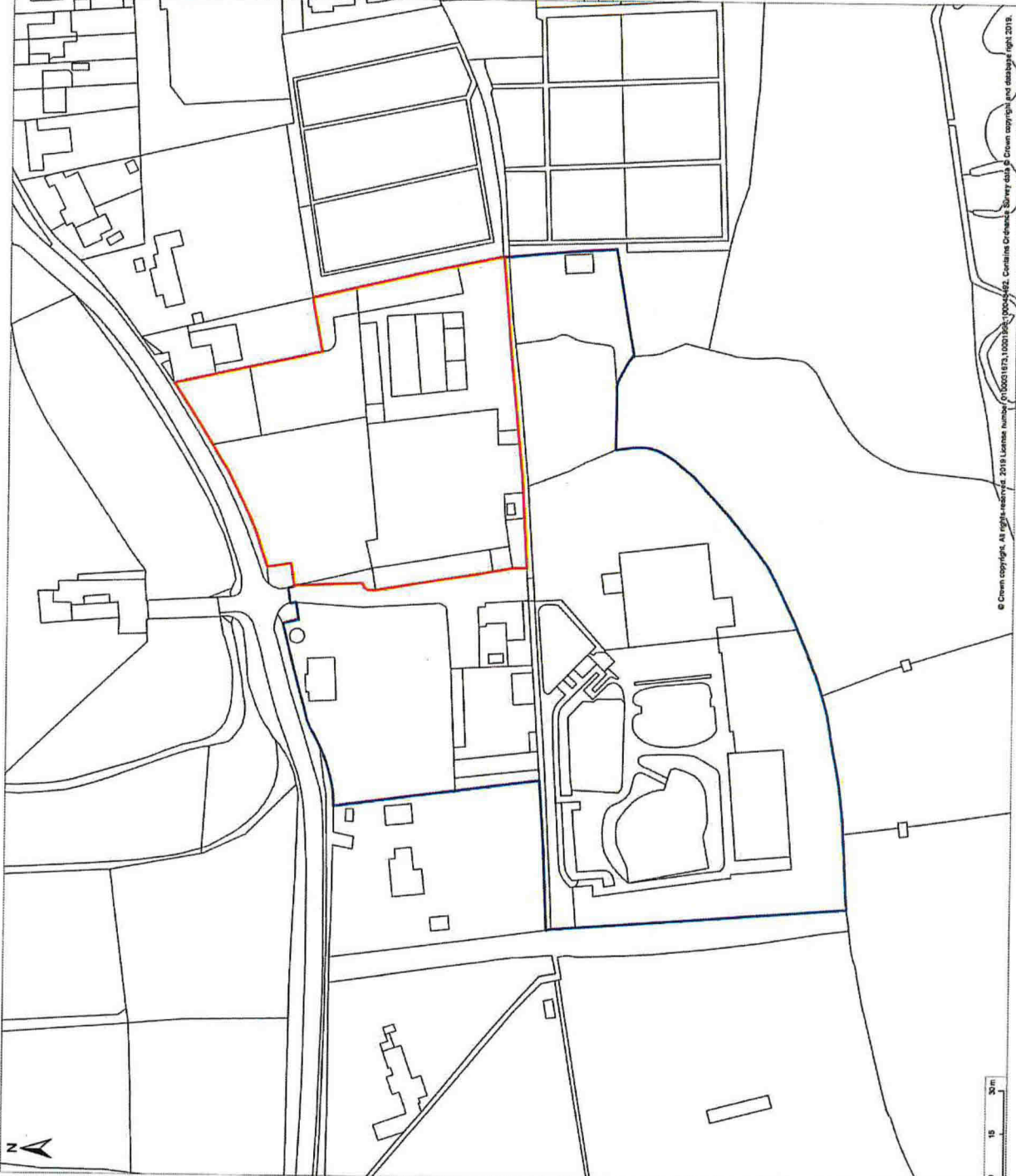

© Crown copyright. All rights reserved. 2018 License number 0100031673, 10001364, 10004462. Contains Ordnance Survey data © Crown copyright and database right 2018.

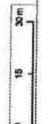

This is Exhibit 10 (Invoice from 1st Containers 04/08/2015) referred to in the Statutory Declaration of **Bean Chapman**

DECLARED AT *Chobham Adventure Farm, GU24 8DB*

This *30th* day of May 2023

BEFORE ME  *GREGORY BARNBROOK*

~~Commissioner for Oaths/Solicitor~~

KEYSTONE LAW

48 Chancery Lane, London
WC2A 1JF Tel: 020 3319 3700
www.keystonelaw.co.uk

1st Containers (uk) Ltd
 Marsh View Industrial Estate
 Ferry Lane South
 Rainham
 Essex
 RM13 9BD
 VAT Reg No: 836 0679 10

Invoice Page 1

Easigrass (Distribution) Ltd
 Old Grass Depot
 Park Avenue
 London
 UB1 3AJ
 VAT Reg No:

Invoice No.	25062
Invoice/Tax Date	04/08/2015
Cust. Order No.	
Account No.	EASIGRAS

Quantity	Details	Unit Price	Net Amount	VAT Rate	VAT
1.00	45 * 20fts all wind and water tight	46,200.00	46,200.00	20.00	9,240.00

Bank Details
 HSBC
 Sort Code: 40-10-27
 Account Number: 21362925

Total Net Amount	46,200.00
Carriage Net	0.00
Total VAT Amount	9,240.00
Invoice Total	55,440.00

This is Exhibit 11 (Photographs July 2015 site preparing to receive containers) referred to in the Statutory Declaration of **Bean Chapman**

DECLARED AT *Chobham Adventure Farm, G424 8DB*

This *30th* day of *May* 2023

BEFORE ME



GREGORY BARNBROOK

~~Commissioner for Oaths/Solicitor~~

KEYSTONE LAW

48 Chancery Lane, London
WC2A 1JF Tel: 020 3319 3700
www.keystonelaw.co.uk



