

General Notes :

Copyright in all documents and drawings prepared by the Architect / Technologist and any works executed from these documents and drawings shall, unless otherwise agreed, remain the property of the Architect / Technologist and must not be reproduced by, lent or disclosed to a third party without the written consent of Building Design Services (C)

Do not scale off this drawing, all dimensions to be checked on site by the Contractor and any discrepancies to be referred back to the Architect / Technologist before proceeding with any work.

All levels to be checked on site by the Contractor and any discrepancies to be referred back to the Architect / Technologist before proceeding with any work.

All component sizes and references to be checked with the manufacturer prior to ordering any materials.

The positions and designation of any Manholes for Foul, Surface Water or Combined Drainage runs on site to be checked and traced by the Contractor, and confirmed prior to commencement of any new Drainage Works. Any existing drainage runs to which additional connections are to be made, to be checked as necessary to ensure they are suitable to accommodate any additional capacity and the type of effluent being connected.

All relevant Boundary positions to be checked prior to proceeding with any Building Works, and all necessary Party Wall agreements entered into prior to the commencement of any Construction.

©copyright

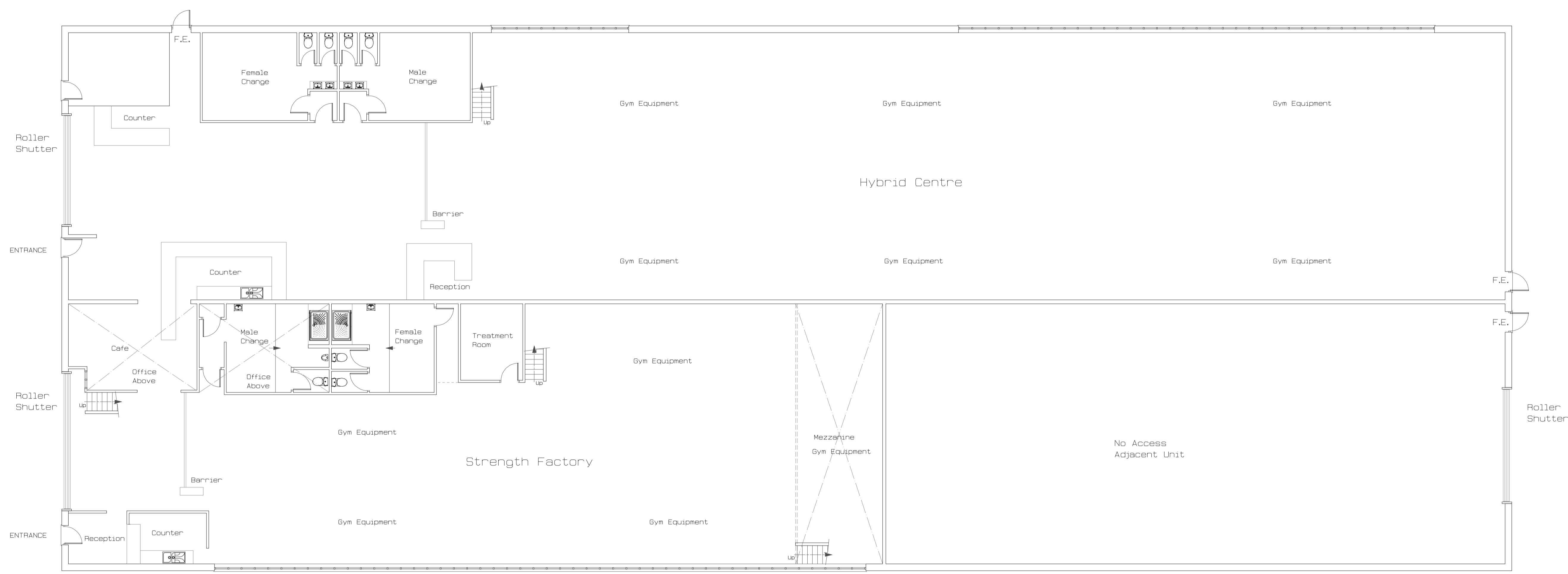

Proposed Ground Floor

Rev	Comments	Date	Initials

BUILDING DESIGN SERVICES
Chartered Architectural Technologist

20 Harpford Close, Brightonmet,
Bolton. BL2 6TN.
Tel : 01204 : 383793. Mob : 07966 : 211995.
jeff.bds93@hotmail.co.uk



Client : *Mr Andy Hibbert.*

Project : *Strength Factory, 105 Manchester Road, Westhoughton.*

Drawing : <i>Proposed Plan.</i>	Drawn : <i>J. C.</i>
	Date : <i>25.01.2024.</i>

Job Number : 60223	Scale : <i>1:100 @ A1</i>
	Drawing Number : 05 Rev :

