

The use of this data by the recipient acts as an agreement of the following statements:  
 Do not use this data if you do not agree with any of the following statements:  
 Ryder Architecture has co-ordinated relevant information received from third parties, but are not responsible for the content of the information received from others.  
 The controlled version of this drawing should be viewed in DWG or PDF format not DWG or other formats. All prints of this drawing must be made in full colour.  
 Where this drawing has been based upon Ordnance Survey data, it has been reproduced under the terms of Ryder Licence No. 100000144. Reproduction of this drawing in whole or in part is prohibited without the prior permission of Ordnance Survey.  
 Do not scale the drawing. Use figured dimensions in all cases. Check all dimensions on site. Report any discrepancies in writing to Ryder before proceeding.

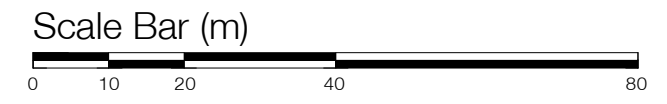

- KEY**
- Area of Works
  - Trust Ownership Boundary Line
  - - - Pedestrian Diversion
  - - - Site Compound/Welfare and Vehicular Access
  - - - Satellite compound and working hours delivery
  - Pedestrian route to site welfare

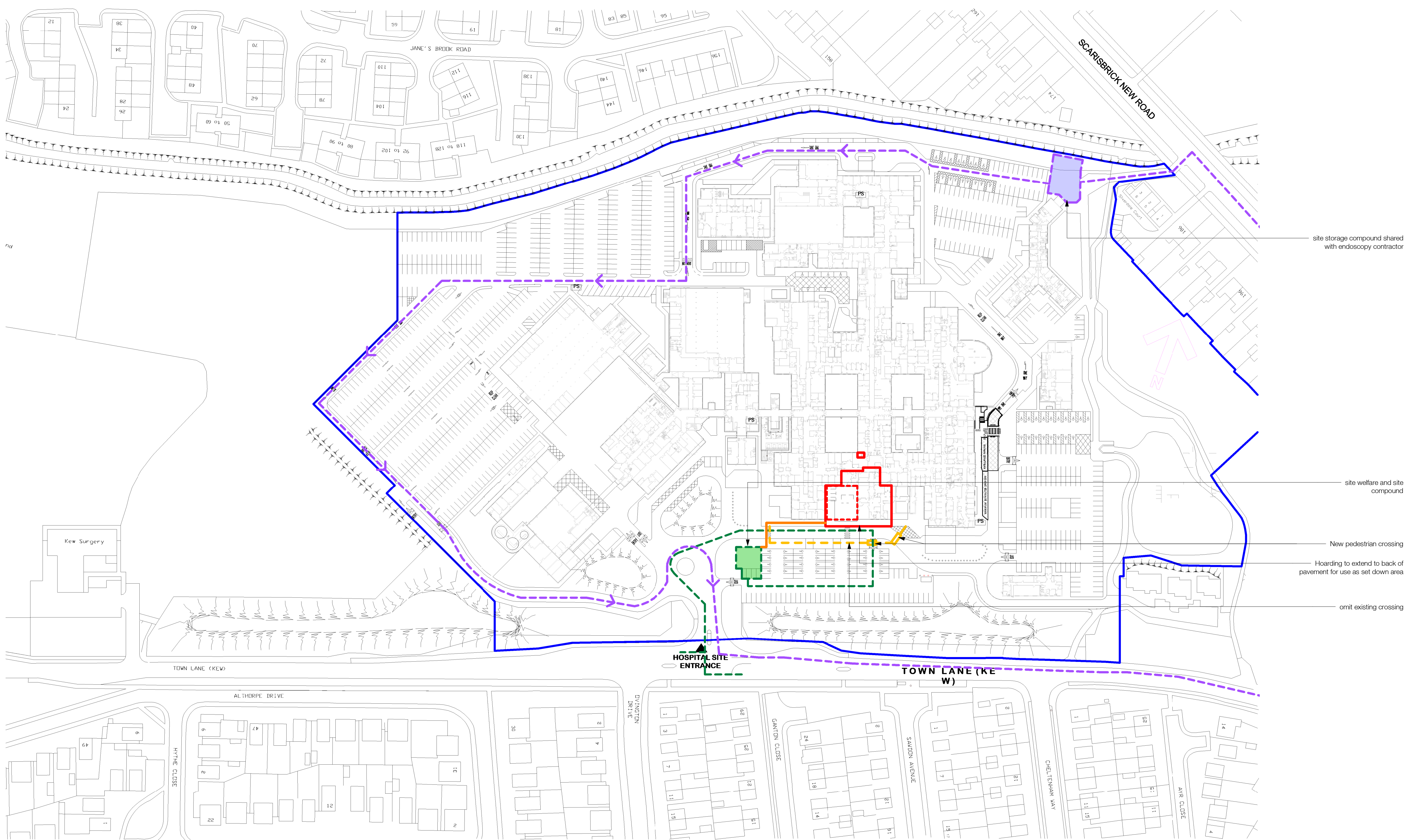

site storage compound shared with endoscopy contractor

site welfare and site compound

New pedestrian crossing

Hoarding to extend to back of pavement for use as set down area

omit existing crossing

Site Compound  
1:1000

P3	Issued for Design and Access Statement	HKL	DFD	24/11/23
P2	Updated to comments made in meeting	TJO	DFD	10/03/23
P1	First Issue	TJO	DFD	03/03/23
Rev	Description	Drawn	Checked	Date

**Subsidiary**  
For Information

**Project**  
Southport and Ormskirk Hospitals  
Diagnostic  
Southport

**Drawing**  
Site Compound

<b>Drawing Number</b>	<b>Originator</b>	<b>Zone</b>	<b>Level</b>	<b>Type</b>	<b>Role</b>	<b>Number</b>
SOUCT	RYD	ZZ	00	DR	A	0433
<b>Project Number</b>	<b>Scale at A1</b>	<b>Status</b>	<b>Revision</b>			
10461-10	As indicated	S2	P3			