

- ### Landscape Legend
- P3** Surfacing - Vehicular tarmac/adam to Engineer's detail and specification
  - P5** Surfacing - Resin bound gravel, Addagrip Pecan Buff pedestrian surfacing refer to Engineer's detail and specification for bedding and bases
  - P6** Paving - Permeable Tegula block paving, Tobermore Hydropave Tegula or similar approved, Heather colour, depth to suit use class, refer to Engineer's detail and specification for bedding and bases
  - P7** Surfacing - concrete surfacing to Engineer's detail and specification
  - P8** Paving - Tegula block paving (depth to suit use type). Tobermore tegula heather colour or similar approved. refer to Engineer's detail and specification for bedding and bases
  - Surfacing - bark mulch
  - Furniture - Cycle shelter with Sheffield stand cycle hoops
  - Furniture - bench seating
  - Furniture - timber pergola
  - Fencing - proposed 1.5m timber privacy screen
  - Fencing - proposed 2m close board fence with gates
  - Fencing - metal hoop top railings, 1.6m height
  - Trellis - for climbing plants
  - Existing tree
  - Existing under-storey planting
  - Proposed tree
  - Specimen shrub
  - Native Hedge planting
  - Ornamental Hedge planting
  - Shrub planting
  - Lawn

Plant schedule Species	Size & Spec.	Spacing	No.
<b>Trees</b>			
Amelanchier alnifolia 'Obelisk'	12-14cmg, H Std, 3.5-4.0m height, 2m clear stem		1
Carpinus betulus	14-16cm girth EHS 4-4.5m height, 2m clear stem		5
Koeleruteria paniculata	12-14cmg, H Std, 3.5-4.0m height, 2m clear stem		1
Magnolia stellata 'Jane Platt'	12-14cmg, H Std, 3.5-4.0m height, 2m clear stem		1
Malus evereste	12-14cmg, H Std, 3.5-4.0m height, 2m clear stem		1
Cercis canadensis 'Forest Pansy'	12-14cmg, H Std, 3.5-4.0m height, 2m clear stem		2
Prunus 'Amanogawa'	14-16cm girth EHS 4-4.5m height, 2m clear stem		1
Sorbus aria	14-16cm girth EHS 4-4.5m height, 2m clear stem		1
<b>Specimen Shrubs</b>			
Acer palmatum 'Summer Gold'	C25, 1.5-1.75m hgt, branched	as shown	1
Buddleja davidii 'Empire Blue'	C15, 1.5-1.75m hgt, branched	as shown	1
Buddleja davidii 'Royal Red'	C15, 1.5-1.75m hgt, branched	as shown	2
Cornus kousa 'Miss Satomi'	C30, 1.75-2m hgt, branched	as shown	2
Cotinus coggygria 'Royal Purple'	C15, 1.5-1.75m hgt, branched	as shown	1
Forsythia x intermedia 'Lynwood Variety'	C15, 1.5-1.75m hgt, branched	as shown	1
Viburnum x burkwoodii 'Anne Russell'	C12, 1.0-1.5m, branched	as shown	8
<b>Native Hedge - Mixed species</b>			
(planted in groups of 5-7 same species)			
Acer campestre	25%	60-90 bare root	5 / lin m 180
Carpinus betulus	50%	60-90 bare root	5 / lin m 180
Viburnum lantana	25%	60-90 bare root	5 / lin m 180
planting rate of 5/lin. m planted in double staggered row			
<b>Ornamental Hedge</b>			
Elaeagnus x ebbingei	C10, 80-100cm, branched	1.5/m2	154
Osmanthus x burkwoodii	C10, 80-100cm, branched	1.5/m2	92
Lonicera pileata 'Maigrun'	C2, 20-30cm, branched	7/lin m	75
Olearia x haastii	C10, 80-100cm, branched	1.5/m2	66

Plant schedule Species	Size & Spec.	Spacing	No.
<b>Shrubs</b>			
Ceanothus thyrsiflorus 'Yankee Point'	C10, 30-40cm, bushy	1.5/m2	10
Cistus x hybridus	C10, 40-50cm, bushy	1.5/m2	25
Choisya 'Aztec Pearl'	C10, 40-50cm	1.5/m2	6
Choisya 'Sundance'	C10, 40-50cm	1.5/m2	19
Cornus Mid Winter Fire	C10, 60-80cm, branched	1.5/m2	3
Deutzia x Mont Rose	C10, 40-50cm, bushy	1.5/m2	2
Fuchsia 'Mrs Popple'	C10, 40-50cm	1.5/m2	20
Lavandula 'Hidcote'	C2, bushy	7/m2	144
Lavandula 'Munstead'	C2, bushy	7/m2	25
Leycesteria formosa	C10, 60-80cm, branched	1.5/m2	1
Philadelphus 'Manteau d'Hermine'	C10, 60-80cm, branched	1.5/m2	1
Pittosporum tenuifolium 'Tom Thumb'	C10, 30-40cm, bushy	1.5/m2	5
Potentilla fruticosa 'Pink Beauty'	C10, 30-40cm, bushy	1.5/m2	12
Salvia rosmarinus 'Sissinghurst Blue'	C10, 30-40cm	1.5/m2	10
Sarcococca hookeriana var. humilis	C10, 30-40cm	1.5/m2	10
Sarcococca hookeriana 'Winter Gem'	C10, 30-40cm	1.5/m2	34
Spiraea japonica 'Firelight'	C10, 40-50cm, bushy	1.5/m2	6
Spiraea japonica 'Goldflame'	C10, 40-50cm, bushy	1.5/m2	4
Weigela 'All Summer Red'	C10, 40-50cm, bushy	1.5/m2	2
<b>Herbaceous Perennials</b>			
Allium lavender bubbles	C2, well developed	7/m2	6
Campanula lact.	C2, well developed	7/m2	6
Hosta 'Brim Cup'	C2, well developed	7/m2	6
Knautia macedonica	C2, well developed	7/m2	6
Kniphofia caulescens	C2, well developed	7/m2	10
Kniphofia 'Ice Queen'	C2, well developed in pot	7/m2	6
Kniphofia 'Royal Castle'	C2, well developed in pot	7/m2	6
Persicaria bistorta 'Hohe Tatra'	C2, well developed	7/m2	16
Perovskia 'Little Spire'	C2, well developed in pot	7/m2	6
Phlox Orange Perfection	C2, well developed	7/m2	6
Salvia nemorosa 'Ostfriesland'	C2, well developed	7/m2	8
Sedum Autumn Joy	C2, well developed	7/m2	6
Verbena bonariensis	C2, well developed in pot	7/m2	6

Plant schedule Species	Size & Spec.	Spacing	No.
<b>Groundcover:</b>			
Alchemilla mollis	C2, well developed	5/m2	11
Bergenia Bressingham White	C2, well developed	5/m2	34
Brunnera macrophylla 'Jack Frost'	C2, well developed	5/m2	49
Epimedium x perralchicum 'Frohneiten'	C2, well developed	5/m2	39
Geranium x oxonianum 'A.T. Johnson'	C2, well developed	5/m2	96
Geranium sanguineum	C2, well developed	5/m2	25
Liriope muscari 'Monroe White'	C2, well developed	5/m2	25
Pachysandra terminalis 'Green Carpet'	C2, well developed	5/m2	56
Tiarella 'Sugar and Spice'	C2, well developed	5/m2	18
<b>Climbers</b>			
Akebia quinata	C3, 90-120 caned	as shown	5
Lonicera periclymenum	C3, 90-120 caned	as shown	2
Jasminum officinale	C3, 90-120 caned	as shown	6

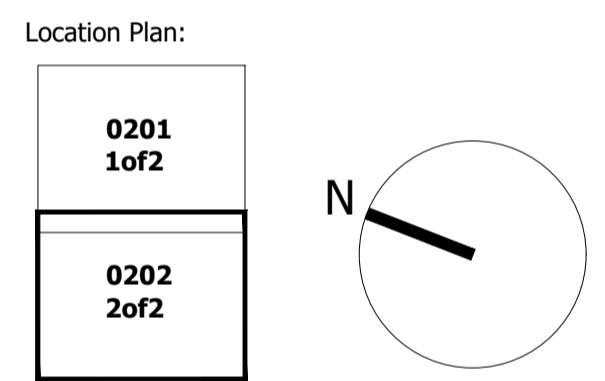

- Revisions:
- P03** site plan updated, landscape plan amended to suit  
Issued for planning Dec'23
  - P02** path to bin store added, plant schedule updated  
Issued for planning Nov'23
  - P01** Issued for planning Oct'23

Landscape Architect

# ijla

Contractors are not to scale from this drawing. All dimensions are to be checked on site. Any discrepancies, ambiguities and/or omissions between this drawing and information given elsewhere are to be reported to this office for clarification before proceeding.

Status:

## PLANNING

Project Title:

### Lawnfield

1 Westmorland Road, Maidenhead, SL6 4HB  
Drawing Title:  
Landscape Plan 2of2

Scale:  
1:100@A1  
Date:  
Sept'23  
Drawing Number: M424-202  
Revision: P3

External references:  
1 - Survey\recvd230601\Geo23-041\_T COPY.dwg  
2 - Architect\recvd231205\ACAD-Proposed Site Plan - 05.12.23.dwg  
3 - Arb\recvd230605\Lawnfields Tree Constraints Plan COPY.dwg  
4 -