

SECTION A-A

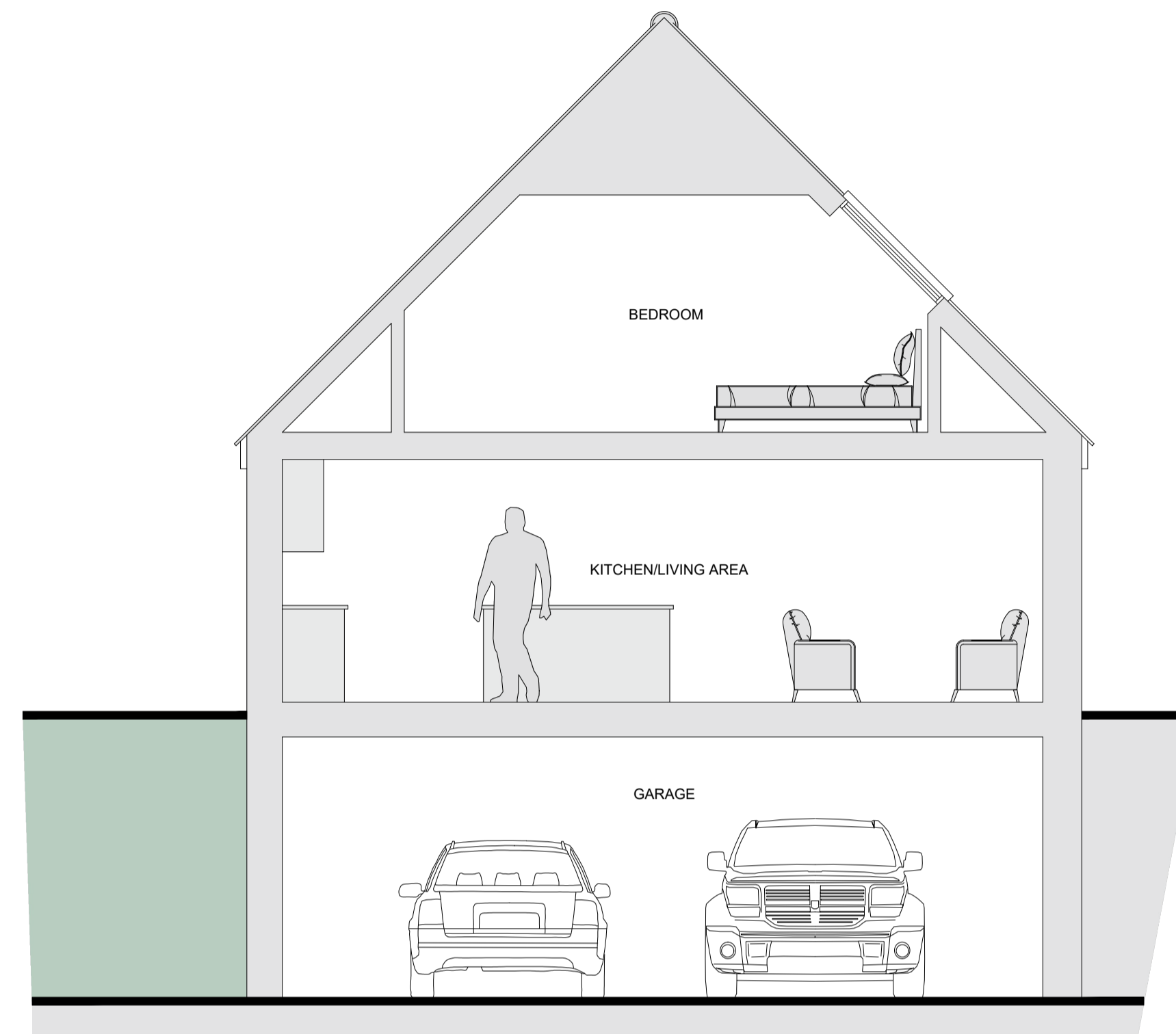

SECTION B-B

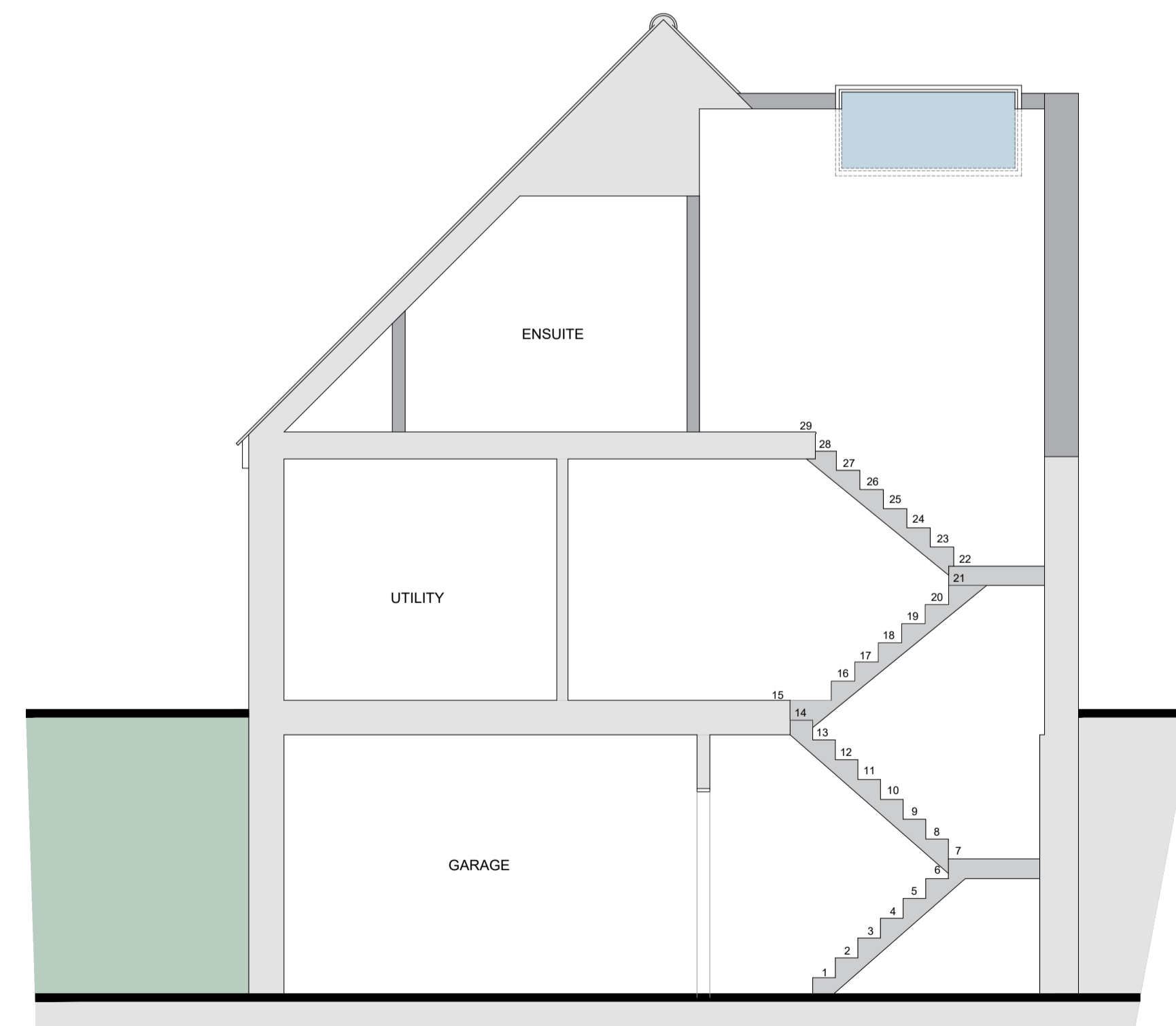

SECTION C-C



Rev	Description	Date

- These drawings have been prepared for the purpose of obtaining planning approval only.
- All dimensions must be checked on site by the client and/or building contractor.
- The client is responsible for all matters relating to Party Wall Act 1996.
- Where existing drain runs are shown these are assumed only.
- The client is responsible for checking that boundaries are correct and proposals do not conflict with any restrictive covenants which may be in title deeds.
- All works to be executed to the satisfaction of the Local Authority and to comply with all current Building Regulations, Planning Requirements, British Standards and Codes of Practice.



Phone: 01206 323603 Email: info@lpsgroup.co.uk

PROJECT  
**Extensions and Alterations**

ADDRESS  
**Waters Edge, Lower Marine Parade, Dovercourt, CO12 3SR**

TITLE  
**Sections**

CLIENT  
**Armstrong**

DRAWN BY JY	CHECKED BY RY	DATE 21/09/2022
SCALE A1 @ 1:100	PROJECT NUMBER LPS1107	REV 00
DRAWING NUMBER 1.5		