

Living Room Ceiling height approx 3075mm above finished floor level

Hallway Ceiling height approx 2845mm above finished floor level

Kitchen Ceiling height approx 2290mm above finished floor level

Loadbearing masonry wall & adjoining doors to be removed. See Structural Engineer's details.

Radiator to be removed

Non-Loadbearing masonry wall & adjoining door to be removed

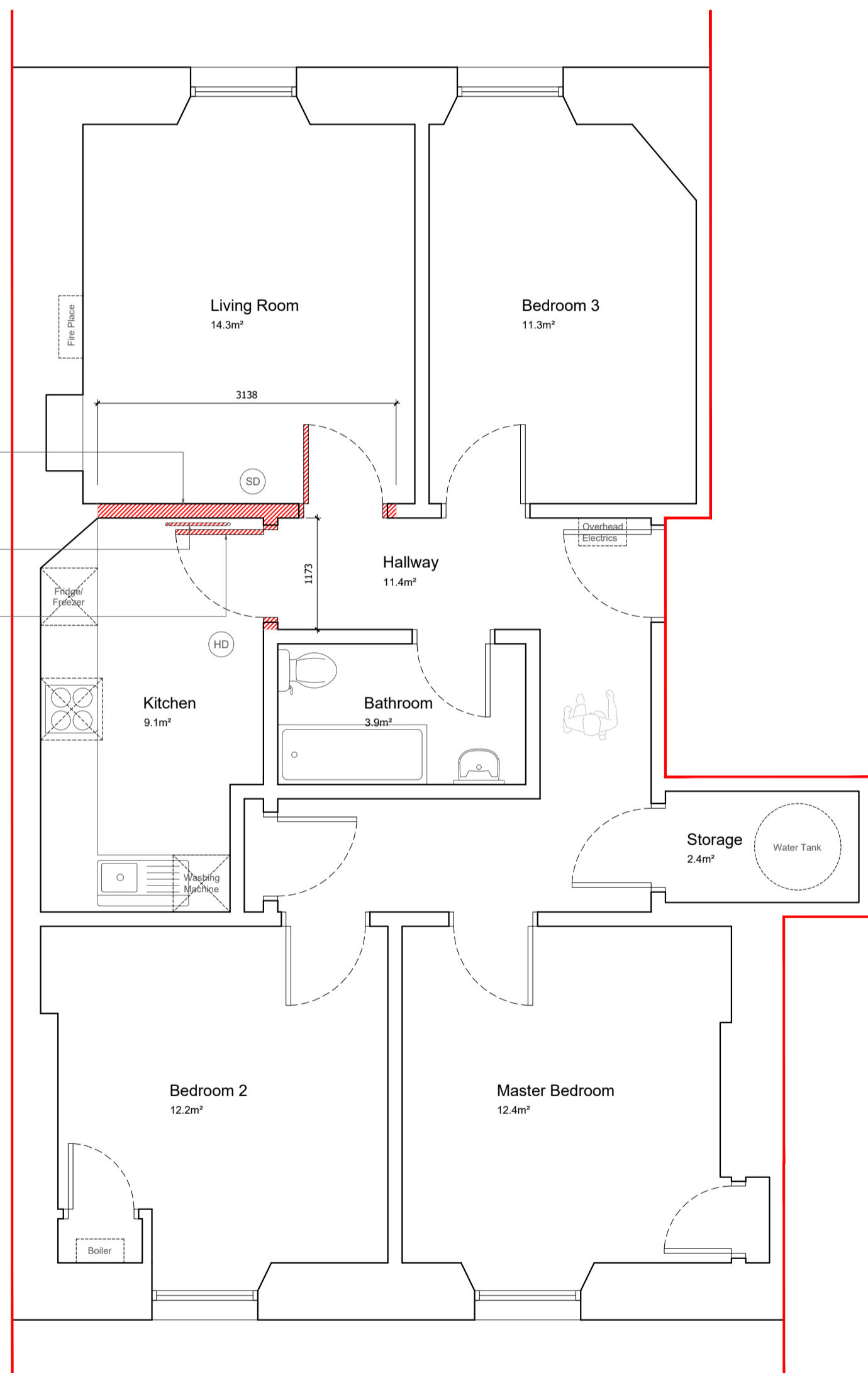

FLAT FLOOR PLAN 1.50 (AS EXISTING)

**Intermediate Flooring:**  
If sound resistance material is removed or damaged when installing new works, upgrade compromised area with 100mm Rockwool Sound Slab between floor. Continuous run of Ø 25mm wire mesh spaced to sides of joists and laid over ceiling. Ceiling finish to be 2no. layers of 12.5mm Plasterboard with a minimum mass per unit area of 50kg/m².

ALL TO ACHIEVE 45dB Rw.

All pipework passing through joists to be wrapped in suitable acoustic material. Any wet ceilinging disturbed during works to be reinstated.

**Overhead Beam to Structural Engineer's Specification:** Steel beam to be encased with 1no. layers of 15mm Friable plasterboard to meet the regulations.

Level to Structural Engineer's specification

Overhead fitted to structural engineer's specification. Contractor to take care not to damage Living Room ceiling when undertaking the works

Contractor to install new Smoke detector which should be hardwired and interlinked in accordance with BS 5446 Part 2, 2003.

Ceiling mounted smoke detectors to be at least 300mm from (and not directly above) any light fitting, heater, air conditioning outlet or vent.

Contractor to ensure Heat Detector is installed in the Kitchen and is hard wired to the mains.

Contractor to ensure existing Ceiling Hung Extractor Fan capable of at least 30 l/min. If not, Contractor is required to upgrade and connect into existing extraction ducting

**New Internal Wall Construction:** 3mm Slab on 12.5mm Plasterboard (Moisture Resistant Plasterboard in Kitchen) on raftwood studs @ max 600mm c/c infilled with minimum 50mm Rockwool Fibre.

New door leading to hallway to be new 30 min self-closing fire door fitted with intumescent strip and smoke brush.

Low pressure hot water gas fired central heating radiators to be fitted/located as shown on drawings. All new radiators to be fitted with TRV's

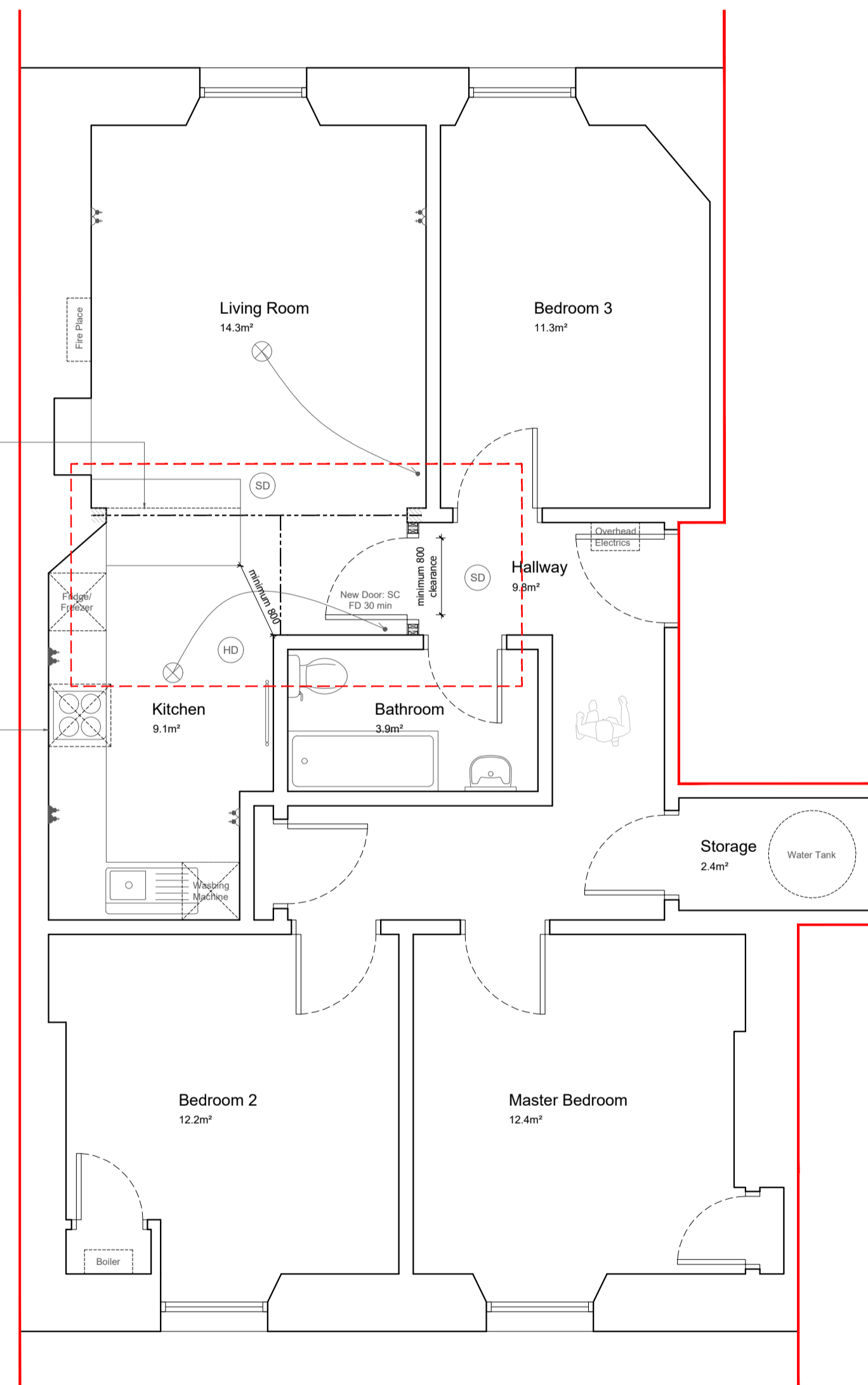

FLAT FLOOR PLAN 1.50 (AS PROPOSED)

North

**GENERAL NOTES**

ALL WORKS ARE TO BE CHECKED ON SITE PRIOR TO CONSTRUCTION/MANUFACTURE.

CONTRACTOR TO ENSURE NO CONSTRUCTION OR SITE COMPOUND/MATERIALS ENCR OACH ON LAND OUT WITH THE OWNERSHIP OF THE CLIENT AS INDICATED ON THE CLIENT'S TITLE.

ALL DISTURBED FINISHES TO BE MADE GOOD BY THE CONTRACTOR PRIOR TO COMPLETION. ALL ROOM DIMENSIONS ARE TAKEN FROM FINISHED PLASTERBOARD WALL UNLESS OTHERWISE STATED.

- HANDOVERING SPACE
- COOKER SWITCH
- CEILING MOUNTED LIGHT PENDANT
- HEAT DETECTOR
- HIGH LEVEL DOUBLE SOCKET
- LOW LEVEL DOUBLE SOCKET
- SMOKE DETECTOR
- LIGHT SWITCH
- DOWNLIGHTS

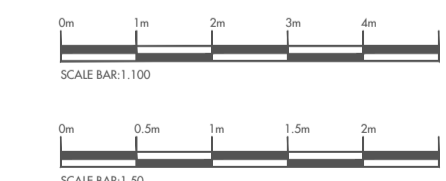

**PROJECT TITLE:**  
23-AHG | Internal Alterations

**PROJECT ADDRESS:**  
Flat 3, 42 Elm Row,  
Edinburgh,  
EH7 4AH

<b>DRAWING NO.:</b> 23-AHG-LBC-01	<b>SCALE:</b> 1.50 @ A1
<b>DRAWING TITLE:</b> See Drawings (As Existing & Proposed)	
<b>DATE:</b> 22/01/2024	<b>REVISION:</b> A