

Existing ground floor
Scale 1:50 @ A1



Existing North Elevation
Scale 1:100 @ A1



Existing East Elevation
Scale 1:100 @ A1



Existing West Elevation
Scale 1:100 @ A1

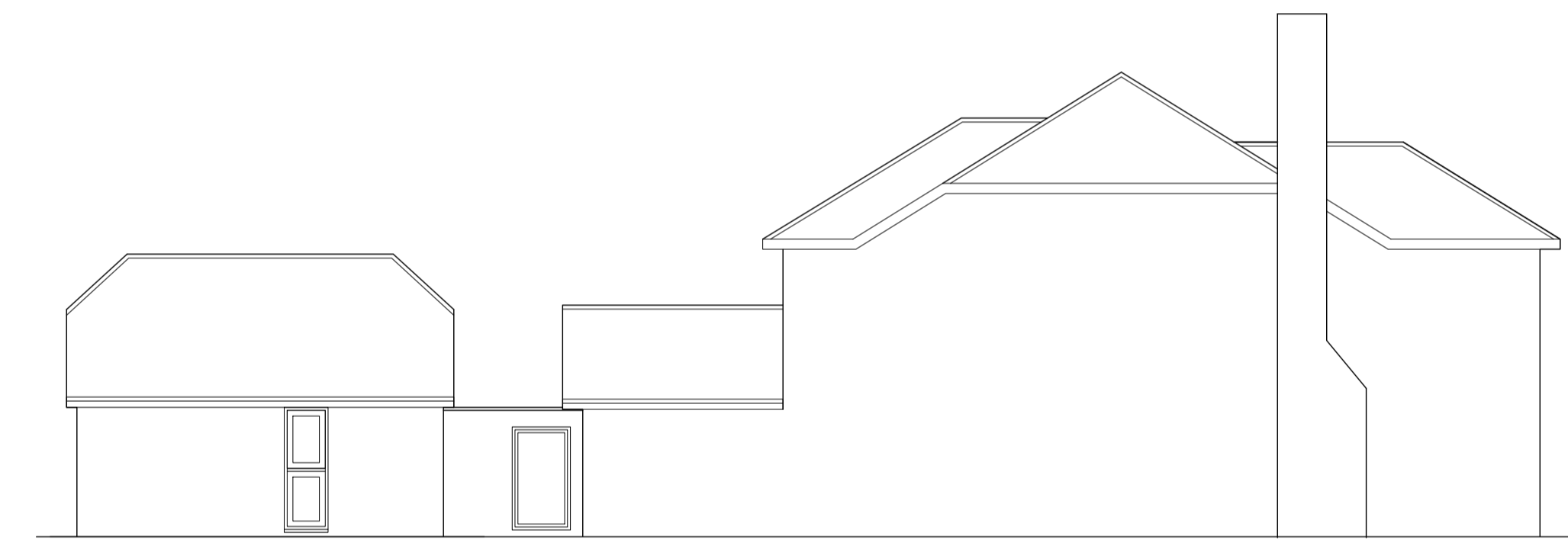

Existing South Elevation
Scale 1:100 @ A1

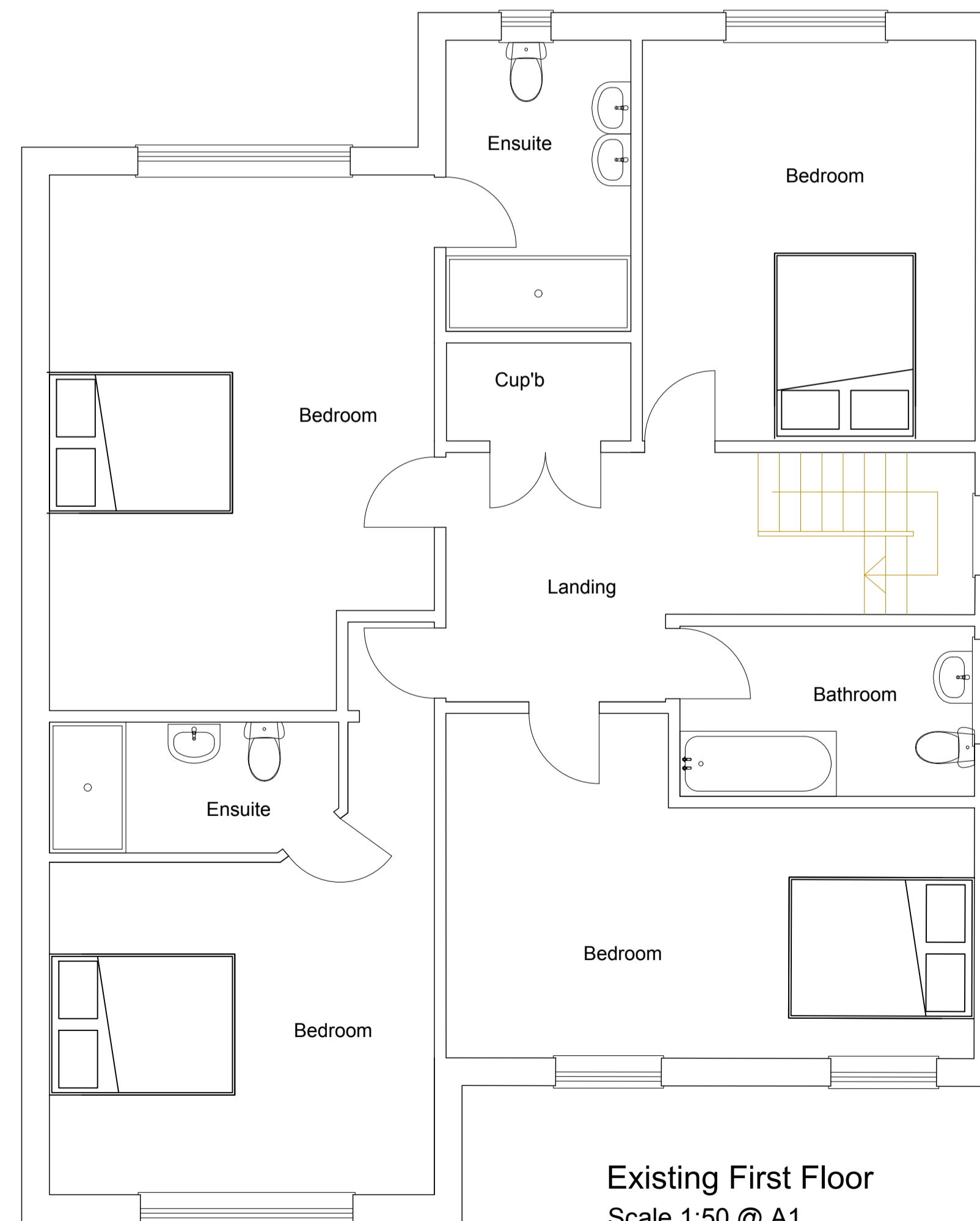

Existing First Floor
Scale 1:50 @ A1

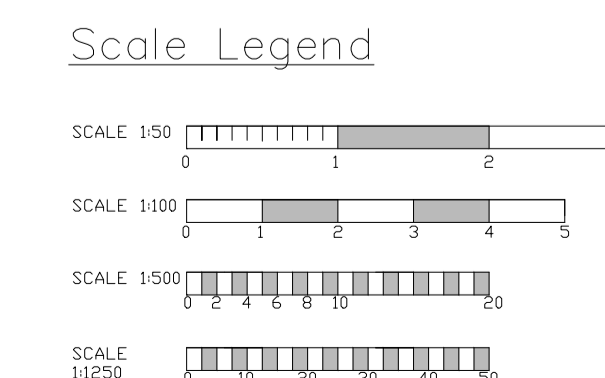

Client : Mr & Mrs N Hill
Address : 38 Barton Court Road,
Barton On Sea, Hants BH25 7HG
Project : Extensions to ground floor
Title : Existing Floor plans

Drawing N.O : PL NH 0101 /2023
Drawn By : Matthew Austin / 71DESIGN
Date : 16 / 10 / 2023
Scale : As indicated @ A1

71DESIGN architectural services
Contact : Matt@71design.net
Tel : 0786649288