

This drawing is the Copyright of Richard Mazillius and may not be altered or reproduced in any way without written permission of Richard Mazillius.  
 Written dimensions supersede scaled dimensions. All dimensions to be checked on site by the Contractor before commencement of the works or before components are fabricated.  
 This drawing is to be used only for the purposes intended and as described in the drawing title block.  
 This drawing to be read in conjunction with all other project drawings, including other appointed Consultant drawings as applicable to the project.

**Scale Legend**

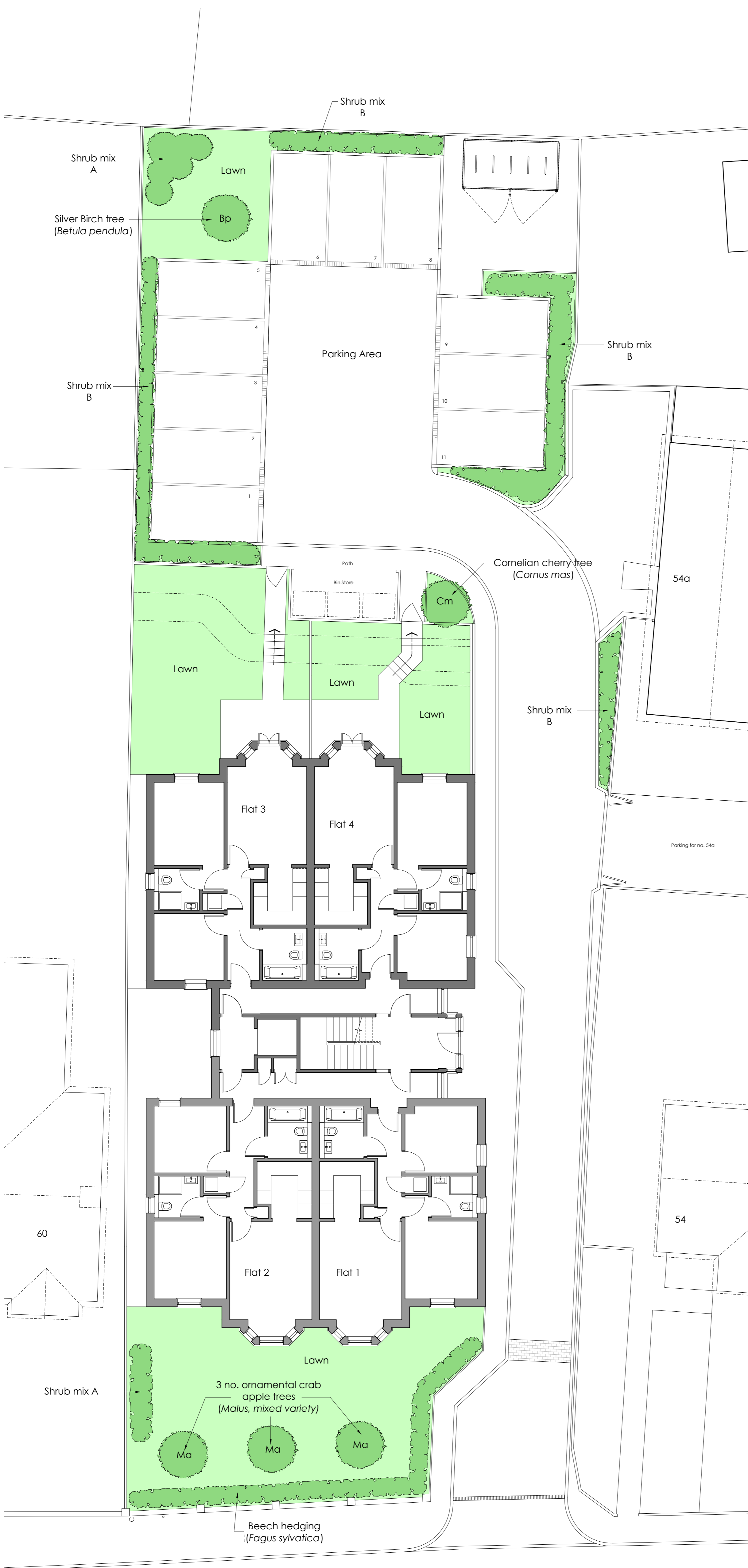

**TREE PLANTING**

No.	Species	Common Name	Specification	Girth
1	Betula pendula (Bp)	Silver birch	Heavy Std	12-14cm
3	Malus (mixed varieties) (Ma)	Ornamental Crab apple	Heavy Std	12-14cm
1	Cornus mas (Cm)	Cornelian cherry	Heavy Std	12-14cm

**PREPARATION:**  
 Heavy Standard tree pits - 1000mm x 1000mm x 900mm.  
 Cultivate by hand or mechanically in order to create a suitably workable tilth ready for planting. Remove all large stones (>50mm) and debris, as well as surplus subsoil from site. Excavate tree pits to the above dimensions ensuring pit size is a minimum of 100mm wider than the root ball itself, taking care to stack topsoil and subsoil separately. Fork over bottom and sides of pit to ensure adequate drainage.

**PLANTING:**  
 All planting will take place in the first planting season following completion or occupation of the development, whichever is sooner. Plant individual trees in locations as indicated, subject to engineering/services layout. A suitable system for controlling the roots of the trees should be installed if necessary. Include for 2no. 100mm diameter, 2m-long, tree stakes per tree (height according to tree size and height above ground to be one third the height of the tree), cross-brace, tie and spacer. Include for a 500mm radius of coarse, graded, free of fines large wood chip mulch, evenly spread around the base of the tree, 50mm deep, over a cut out square or circle of sheet mulch pegged well down at 300mm centres, with metal hoops, all recessed so that the mulch level is 25mm below the surrounding ground level. Water in trees with 50 litres of water per tree position the same day as planting.

**MAINTENANCE:**  
 Remove all weed growth by hand as necessary to ensure weed free planting beds. Take great care not to disturb sheet or bark mulch. Persistent perennial weeds shall be controlled using a suitable herbicide to the manufacturers instructions, as required and at intervals to ensure no regeneration of weed. Watering should be carried out during dry periods (less than 20mm rainfall at end of any 14 day period) during the establishment phase. Tree stakes and ties shall be checked, adjusted and replaced as necessary. Monitor trees until established, and replace in the next planting season any that die, are removed, or fail to thrive during the first 5 years following planting.

**SHRUB PLANTING**

**Shrub Mix A (suggested larger species)**  
 Planting density = 1m centres:

20%	Viburnum tinus	3L container
20%	Escallonia rubra "Crimson Spire"	3L container
20%	Aucuba japonica	3L container
20%	Photinia x fraseri "Red Robin"	3L container
20%	Buddleia davidii (various varieties)	3L container

**Shrub Mix B (suggested smaller species)**  
 Planting density = 0.5m centres:

25%	Hebe Rakaiaensis	2L container
25%	Hypericum "Hidcote"	2L container
25%	Brachyglottis "Sunshine"	2L container
25%	Lavandula "Hidcote"	2L container

**PREPARATION:**  
 Cultivate by hand or mechanically in order to create a suitably workable tilth ready for planting. Remove all large stones (>50mm) and debris, as well as surplus subsoil from site.

**PLANTING:**  
 All planting will take place in the first planting season following completion or occupation of the development, whichever is sooner. Plant individual shrubs in locations as indicated, subject to engineering/services layout. Shrubs to be planted as a random mix of the species listed (or suitable similarly sized alternatives), subject to size category to ensure smaller species are not out competed by larger shrubs.  
 Container grown shrubs to be planted in pits large enough to accommodate the plant without any root damage, with a minimum pit size of 300mm x 300mm x 300mm. Pits are to be backfilled with mixture of topsoil and 100g/m2 of a slow release 16,10,10 fertiliser. Apply wood chip mulch as for trees, covering all planted areas. Water all plants thoroughly, immediately after planting. Lightly firm soil around plants and rake lightly to a fine tilth, with no follows.

**MAINTENANCE:**  
 Remove all weed growth by hand as necessary to ensure weed free planting beds. Take great care not to disturb sheet or bark mulch. Persistent perennial weeds shall be controlled using a suitable herbicide to the manufacturers instructions, as required and at intervals to ensure no regeneration of weed. Watering should be carried out during dry periods (less than 20mm rainfall at end of any 14 day period) during the establishment phase. Monitor plants until established, and replace in the next planting season any that die, are removed, or fail to thrive during the first 5 years following planting. Firm in and straighten any plants loosened and prune out dead, leggy and broken branches, without damage to natural habit of the plant.

**HEDGEROW PLANTING**

Hedgerow Density = 5 plants/m in a double staggered row

100% Fagus sylvatica Beech

Hedging to be 60-90cm bare-root whips.

**PREPARATION:**  
 Cultivate by hand or mechanically in order to create bare earth ready for planting, to minimise competition from established grasses, bramble etc.

**PLANTING:**  
 All planting will take place in the first planting season following completion or occupation of the development, whichever is sooner.  
 Each bare-rooted plant to be dipped with a mycorrhizal gel, and slot planted in random species mix (in double staggered rows for hedgerows, with at least 40cm between rows, and 5 plants per linear metre). Apply wood chip mulch as for shrub beds, covering all planted areas. Water all plants thoroughly, immediately after planting. Lightly firm soil around plants. Plants to be supported with a stake and protected with rabbit guards.

**MAINTENANCE:**  
 Remove all weed growth by hand as necessary to ensure weed free establishment conditions. Take great care not to disturb mulch. Persistent perennial weeds shall be controlled using a suitable herbicide to the manufacturers instructions, as required and at intervals to ensure no regeneration of weed. Watering should be carried out during dry periods (less than 20mm rainfall at end of any 14 day period) during the establishment phase. Monitor plants until established, and replace in the next planting season any that die, are removed or fail to thrive during the first 5 years following planting.  
 Ongoing cutting management of light annual hedgerow cut to establish required size (c.0.9m wide x 1.2m high).

**GRASS / LAWN:**

**CULTIVATION & TOP SOIL:**  
 Areas to be turfed shall be cultivated and levelled as required, removing any debris, contaminated soil (containing subsoil, rubble, fuel, lubricants or other substances damaging to plants), and stones with largest dimension exceeding 50mm. Ensure the ground is completely broken up and is free draining. The contractor shall ensure that all topsoil is cultivated in accordance with BS 3882:2007. Topsoil minimum depths to be 150mm for areas of turf. Grass areas are to be cultivated to 100mm and raked to a fine tilth.

**TURFING:**  
 Water the entire area to be turfed thoroughly, to field capacity (minimum of 15 litres per m2). Keep turf stored on site in moist and healthy condition. Supply and lay cultivated low maintenance fine lawn grade turf, such as Rotawn "Medallion" or similar approved, including for cutting turf around manhole covers, stop cocks etc, and adjusting soil levels to suit. Roll using a suitable light roller. Ensure surface of turf is even and level. Water new turf to field capacity with a fine spray hose fitting. Allow for top dressing any cracks occurring within 14 days of turfing, using a 70/30 sand/soil mix containing grass seed.

**MAINTENANCE OF GRASS AREAS:**  
 Mow to height of 25mm, at approximately 14-day intervals throughout the growing season. Vary the mowing frequency to ensure that there is no excessive cutting during dry periods, increasing the cutting height. Water as necessary according to weather conditions, to ensure the soil remains in a damp condition, ensuring that water is applied to field capacity approximately weekly, but more often if dry, until fully established. Once established, water during any spell of continuous hot, dry weather lasting more than 14 days, during the maintenance period.

Revision	Date	Description

**Richard Mazillius**  
 Architecture

1 Kings Road, Binstead, Ryde, Isle of Wight, PO33 3RX  
 tel: 01983 616352 mobile: 07881 651766 e-mail: info@richardmazillius.co.uk

Client: Ronima Ltd

Project: Raffles, 58 Steyne Road  
 Bembridge  
 Isle of Wight

Drawing Title: **PLANTING SCHEME PROPOSALS**

Scale	Date	Drawn
1:100 @ A1	Jan 2024	rmm
Project No.	Drawing No.	Revision
<b>22013</b>	<b>117</b>	

This drawing is the copyright of Richard Mazillius

