

This drawing is copyright of CLARK & MASLIN Ltd and may not be copied or reproduced without permission. Figured dimensions are to be taken in preference to scaled dimensions. Large scale drawings to have preference to small scale drawings. Dimensions for fixed-in items are to be checked on site prior to manufacture.

REV	DETAIL OF REVISION	BY	DATE
-----	--------------------	----	------

A AMENDED SCALE ON TITLE BLOCK

EM 26/01/24

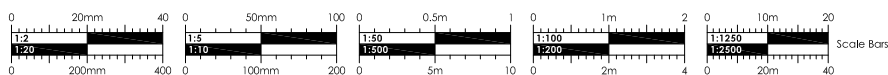
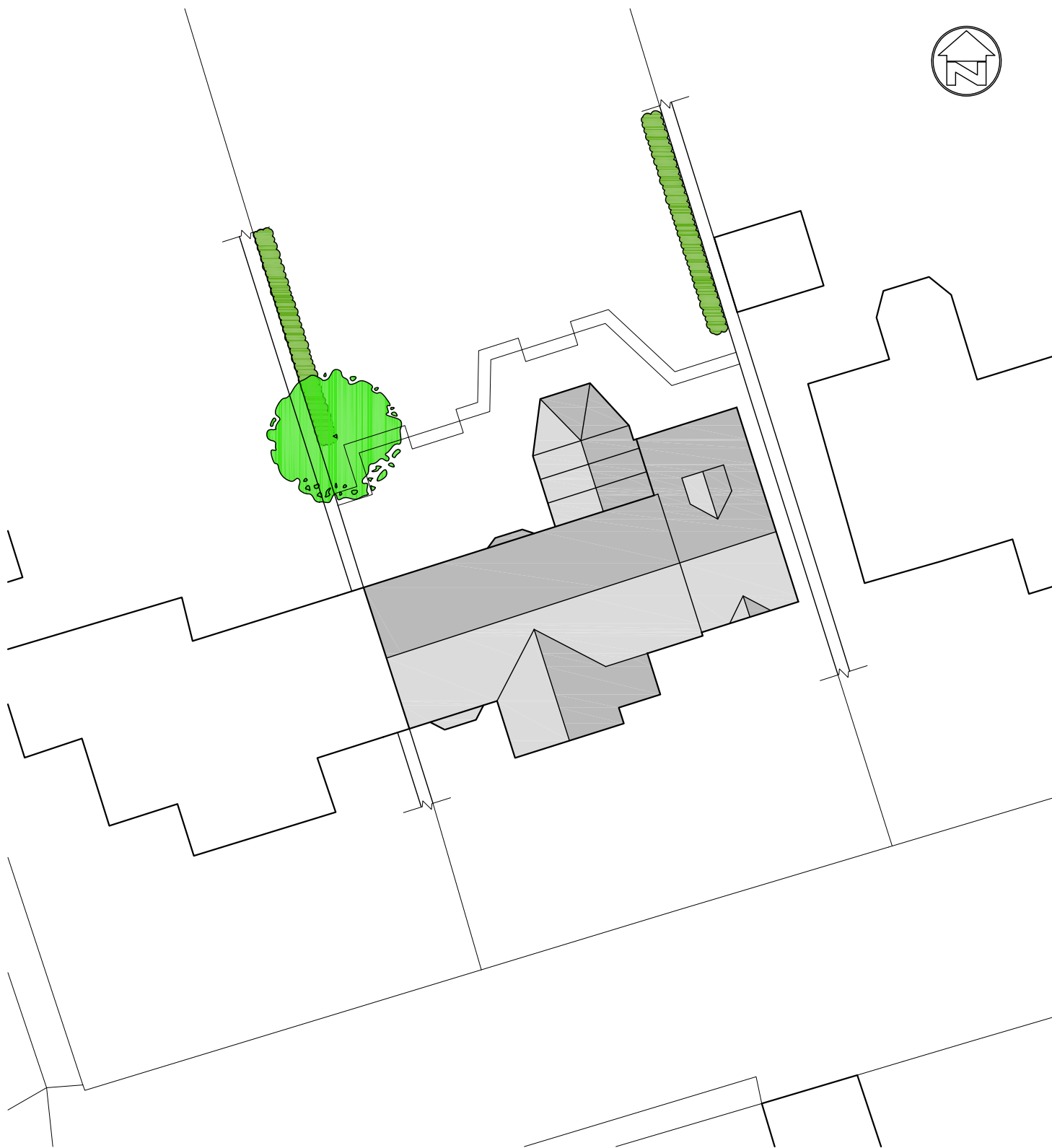

**CLARK & MASLIN**  
 Unit 5, Charlton Business Park  
 Crudwell Road, Malmesbury  
 Wiltshire, SN16 9RU  
 Telephone: 01666 822911  
**Planning Architecture Conservation**

Client MR & MRS J&K BEARDSLEY		Document Type <b>SURVEY DRAWING</b>	
Project PROPOSED EXTENSION & ALTERATIONS, PENLEE, OXLEAZE ROAD, TETBURY, GL8 8JR		Scale 1:200	PG Size A4
Description BLOCK PLAN		Date OCT '23	Drawn DN
		Drawing No <b>5514/04</b>	Revision <b>A</b>